

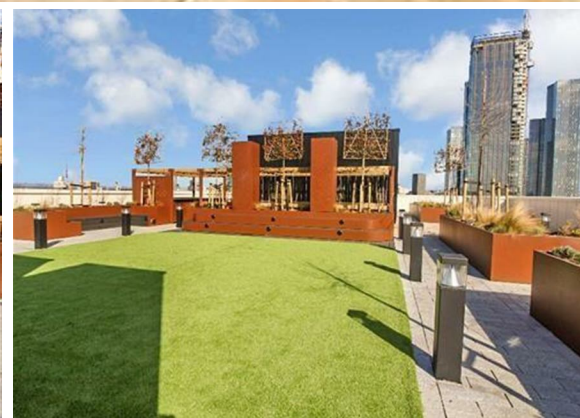

**1 Bed
Apartment
located in 1F
Spinners Way**

£1,250 PCM



 **NPP**
RESIDENTIAL

EPC Rating: B
Council Tax Band: D

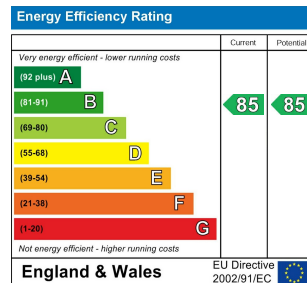

DIRECTIONS

CONTACT

22 Lloyd Street
Manchester
M2 5WA

E: info@nppresidential.co.uk
T: 0161 639 0059
<https://nppresidential.co.uk/>

