

Grove Road, Wallasey Village

£375,000 Council Tax Band C EPC Rating E



This stunning six-bedroom, commanding residence beautifully blends original features with high-quality modern upgrades throughout, a true credit to its current owners. Set across three well-planned floors, this impressive home offers spacious and versatile accommodation, ideal for a growing family. Situated on a sought-after road within a highly regarded area, the property is close to the amenities of Wallasey Village. The accommodation briefly comprises: vestibule, hallway, WC, living room, dining room and a beautifully appointed dining kitchen. To the first floor are three bedrooms and a stunning family bathroom, with three further bedrooms to the second floor. Externally, a well-designed rear garden and double driveway. A must see home!

Key Features

- Stunning Six Bedroom Period Residence
- Beautifully Upgraded Throughout with Original Features
- Set Over Three Spacious and Versatile Floors
- Impressive Dining Kitchen & Luxury Family Bathroom
- Sunny, Well-Designed Garden Ideal for Entertaining
- Sought-After Location Near Grove Road Station
- Off Road Parking
- Council Tax Band C
- EPC Rating E

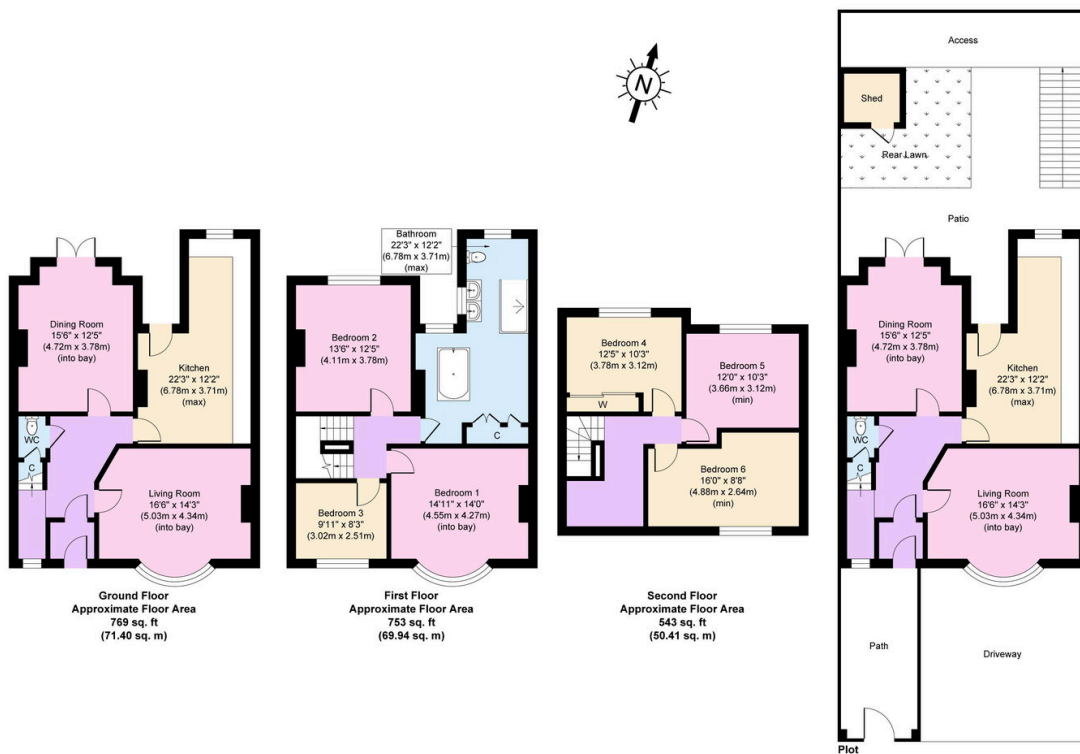

Copyright V360 Ltd 2026 | www.houseviz.com