



Connells

Abbotsfield
Eaglestone MILTON KEYNES



Property Description

Connells Estate Agents are delighted to present to the market this three bedroom End terraced home with no upper chain in the popular and sought after area of Eaglestone that is nearby to both Central Milton Keynes and all of its amenities, and Milton Keynes University Hospital.

The accommodation includes an entrance hallway, cloakroom, lounge/diner, kitchen with a breakfast bar, landing, three bedrooms and a family bathroom. Outside there is a south facing enclosed rear garden, and also a double garage in a nearby block.

Please see the full range of images that accompany this listing as well as the floorplan that provides an indicative view of room layouts. This property should be viewed to be fully appreciated. For further information and to arrange your viewing call Connells Estate Agents today on 01908 674141 or email miltonkeynes@connells.co.uk.

The Area

Eaglestone is located around two miles from Central Milton Keynes, where there is a wide variety of retail, recreational and entertainment facilities in the shape of Centre:MK, the theatre district and the Xscape building.

MK1 retail park is also a short drive away that offers a range of shops, restaurants and a

cinema.

The area is well served with local bus routes providing routes across Milton Keynes. There are also plenty of redways and cycle routes. Main trunk roads such as the A5, A421 and A422 are easily accessible from Milton Keynes. Junctions 13 & 14 of the M1 also connect to Milton Keynes.

Milton Keynes Central railway station located in the town centre offers regular and direct links into London Euston, with journey times from approximately 30 minutes.

Entrance Hall

Double glazed door to the front, wall mounted radiator, stairs to the first floor.

Cloakroom

Double glazed window to the front, w/c, wash hand basin, part tiled.

Lounge/Diner

15' 9" x 14' (4.80m x 4.27m)

Double glazed window to the side, double glazed windows and patio door to the rear garden, understairs cupboard, two wall mounted radiators, tv and telephone points.

Kitchen

12' x 8' 5" max (3.66m x 2.57m max)

Double glazed window to the front, eye base units, worksurfaces, stainless steel sink

drainer, part tiled, space for gas cooker, washing machine, fridge/freezer, breakfast bar, wall mounted radiator.

Landing

Loft access, cupboard, central heating cupboard, airing cupboard, wall mounted radiator, doors to bedrooms one, two, three and the bathroom.

Bedroom 1

14' to front of wardrobe x 8' (4.27m to front of wardrobe x 2.44m)

Double glazed window to the rear, wall mounted radiator, built in wardrobe.

Bedroom 2

10' 1" not into recess x 8' 5" (3.07m not into recess x 2.57m)

Double glazed window to the front, wall mounted radiator.

Bedroom 3

9' 2" x 6' 11" (2.79m x 2.11m)

Double glazed window to the rear, wall mounted radiator.

Bathroom

Double glazed window to the front, bath, taps, w/c, wash hand basin, part tiled, shaving point, wall mounted radiator.

Front Garden

Path to the front door.

Rear Garden

South facing garden enclosed by a timber fence, rear gated access, shed, concrete and slab area, mainly laid to lawn.

Parking

Double garage in a block with up and over doors.







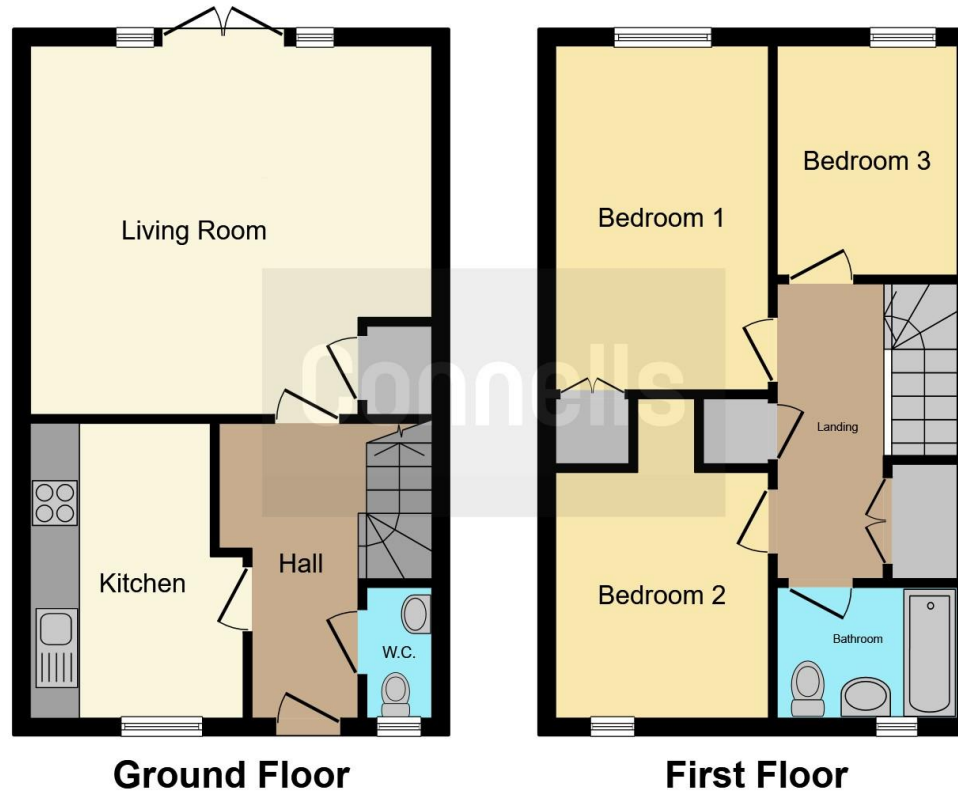

This floor plan is for illustrative purposes only. It is not drawn to scale. Any measurements, floor areas (including any total floor area), openings and orientation are approximate. No details are guaranteed, they cannot be relied upon for any purpose and they do not form part of any agreement. No liability is taken for any error, omission or misstatement. A party must rely upon its own inspection(s). Powered by www.focalagent.com

To view this property please contact Connells on

T 01908 674 141
E miltonkeynes@connells.co.uk

Northgate House 500 Silbury Boulevard
 MILTON KEYNES MK9 2AD

EPC Rating: C Council Tax Band: B

Tenure: Freehold

view this property online connells.co.uk/Property/MKN320396



1. MONEY LAUNDERING REGULATIONS Intending purchasers will be asked to produce identification documentation at a later stage and we would ask for your co-operation in order that there will be no delay in agreeing the sale. 2. These particulars do not constitute part or all of an offer or contract. 3. The measurements indicated are supplied for guidance only and as such must be considered incorrect. Potential buyers are advised to recheck measurements before committing to any expense. 4. We have not tested any apparatus, equipment, fixtures, fittings or services and it is in the buyers interest to check the working condition of any appliances.

Connells Residential is registered in England and Wales under company number 1489613, Registered Office is Cumbria House, 16-20 Hockliffe Street, Leighton Buzzard, Bedfordshire, LU7 1GN. VAT Registration Number is 500 2481 05.

See all our properties at www.connells.co.uk | www.rightmove.co.uk | www.zoopla.co.uk

Property Ref: MKN320396 - 0010