



## Somerset Road, W13

£550,000

A highly impressive lower ground floor flat located in this select private development built in 2024.

Offering over 660 sq.ft of modern fitted living space and benefiting from direct access to a private South facing patio garden.

Perfectly located close to Northfields and South Ealing Piccadilly line stations and the Elizabeth line at both West Ealing and Ealing Broadway stations.

### Features

- Spacious One Bedroom
- 660 Sq.Ft
- Built in 2024
- Adjacent to Parks
- Close To Transport
- Private Garden

# Somerset Road, LONDON, W13

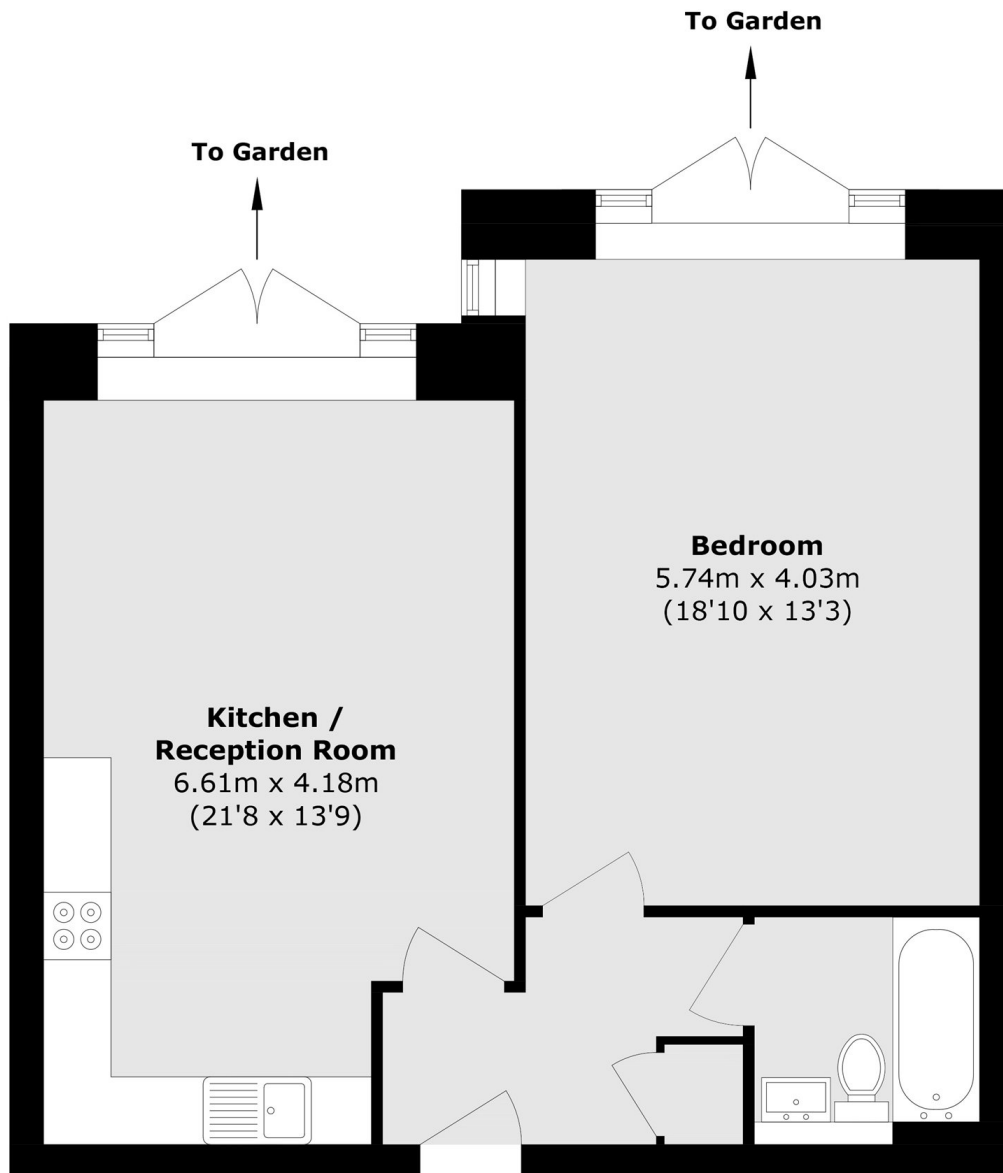

Total area (approx.): 62.0 sq. m (667.3 sq. ft)