



WRIGHTS LANE LONDON W8
£2,750 PER MONTH AVAILABLE 18/02/2026

Hamptons
THE HOME EXPERTS

{ THE PARTICULARS

Wrights Lane London W8

£2,750 Per Month
Furnished

-  1 Bedroom
-  1 Bathroom
-  1 Reception

Features

- One Bedroom, - One Bathroom, - Raised Ground Floor, - Residents Gym, - Porter, - Off Street Parking space, - Furnished/unfurnished

Council Tax

Council Tax Band G

Hamptons
8 Hornton Street
Kensington, London, W8 4NW
020 7937 9372
KensingtonLettings@hamptons.co.uk
www.hamptons.co.uk

{ A SUPERB ONE BEDROOM APARTMENT WITH PORTER AND PARKING

The Property

A superb one bedroom apartment located in this popular portered building in Kensington with underground parking and gym. The property comprises spacious reception room with space for dining, adjoining fitted kitchen, spacious double bedroom with good storage and bathroom with shower over bath. The apartment benefits from wooden floors throughout and is offered furnished/unfurnished.

Location

Consort Court is within the Royal Gate development on Wrights Lane, located moments from the amenities of Kensington High Street.



CONSORT COURT

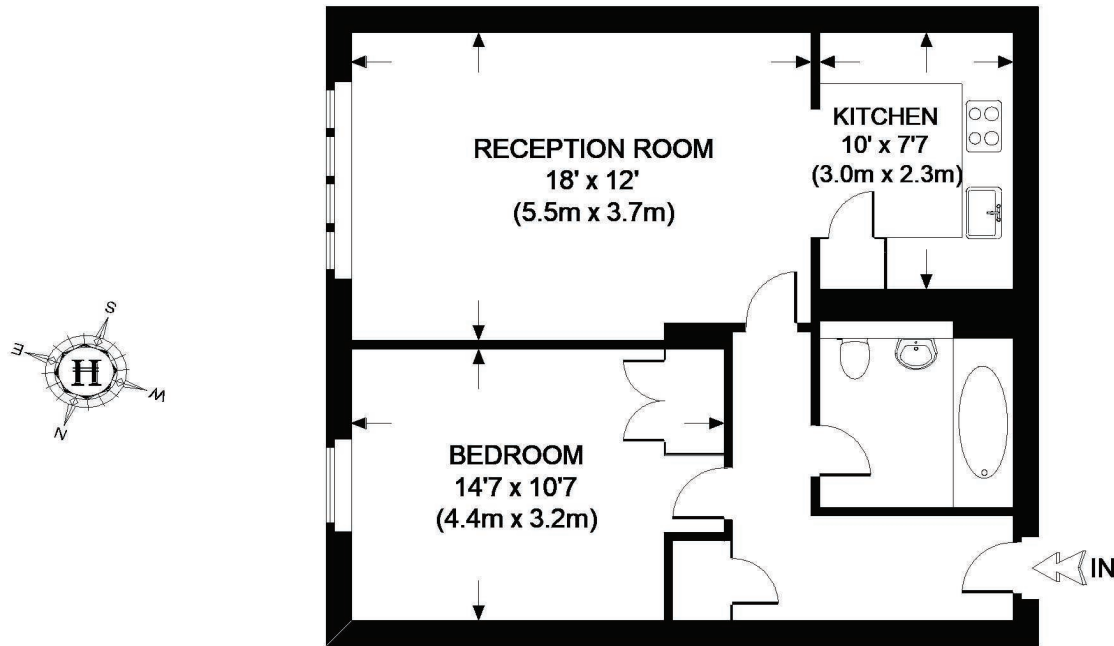

GROUND FLOOR

APPROXIMATE GROSS INTERNAL AREA =
TOTAL = 594 SQ. FT. (55.2 SQ. M.)

This plan is for layout guidance only. Not drawn to scale unless stated. Windows & door openings are approximate. Whilst every care is taken in the preparation of this plan, please check all dimensions, shapes & compass bearings before making any decisions reliant upon them. Please be advised that Hamptons International / our agents have not seen or reviewed any building regulations or planning permission in relation to works carried out to the property.

For Clarification

We wish to inform prospective tenants that we have prepared these particulars as a general guide and they have been confirmed as accurate by the landlord. We have not verified permissions, nor carried out a survey, tested the services, appliances and specific fittings. Room sizes are approximate and measurement figures rounded: they are taken between internal wall surfaces and therefore include cupboards/shelves, etc. Accordingly, they should not be relied upon for

carpets and furnishings. It should also be noted that all fixtures and fittings, carpeted, curtains/blinds, kitchen equipment and garden statuary, whether fitted or not, are deemed removable by the landlord unless specifically itemised with these particulars. Please enquire in office or on our website for details on holding deposit and tenancy deposit figures.

