



29 Angus Drive

Kennington Ashford, TN24 9HW

£1,075 Per Month

Two bedroom top floor apartment positioned within walking distance of local amenities and close to JCT9 of the M20. The accommodation comprises open plan lounge/ kitchen with electric oven, electric hob and washing machine, master bedroom with built wardrobe and en-suite, second single bedroom, bathroom and garage. Call us now to arrange an appointment.

Available Early June
Deposit - £1211
Council Tax- B
EPC Rating- C

Viewing

Please contact our Ashford Office on 01233 646411 if you wish to arrange a viewing appointment for this property or require further information.

- WELL LOCATED PURPOSE BUILT APARTMENT
- SITED ON THE TOP FLOOR
- GARAGE
- TWO BEDROOMS
- EN-SUITE TO BEDROOM ONE
- FAMILY BATHROOM
- KITCHEN AND LIVING ROOM
- GAS CENTRAL HEATING AND DOUBLE GLAZING
- SECURITY DEPOSIT £1211
- AVAILABLE EARLY JUNE

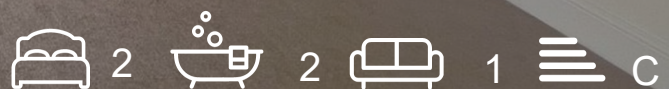

Floor Plan

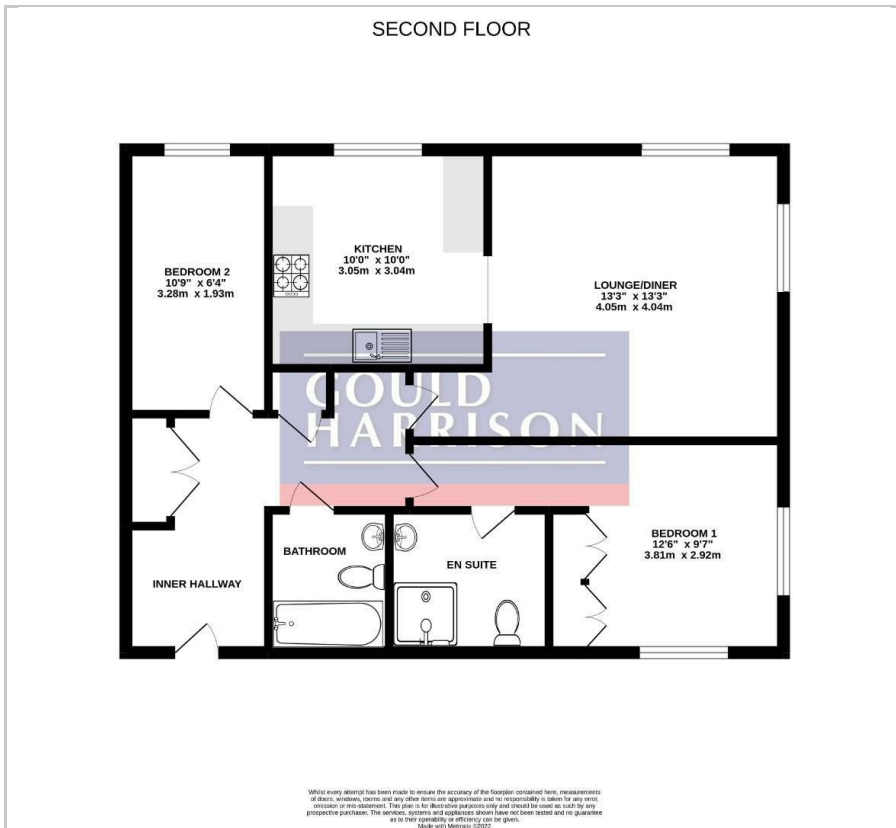

Area Map



Energy Efficiency Graph

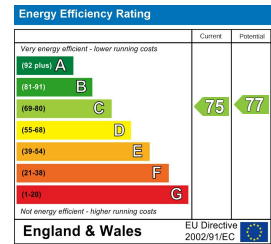

These particulars, whilst believed to be accurate are set out as a general outline only for guidance and do not constitute any part of an offer or contract. Intending purchasers should not rely on them as statements of representation of fact, but must satisfy themselves by inspection or otherwise as to their accuracy. No person in this firm's employment has the authority to make or give any representation or warranty in respect of the property.