



NEW CROSS ROAD, SE14

£300,000

- Two bedroom apartment
- Own private entrance
- Secure gated parking
- Offered chain free
- Overground nearby
- Energy rating: c

@marshandparsons
marshandparsons.co.uk

MARSH &
PARSONS



ABOUT THE PROPERTY

A ground floor apartment, set to the rear of this purpose built development.

The home features its own private entrance with secure entry, with access from the gated residents car park.

The location is super convenient for the many offerings of New Cross, with the Overground also only moments away.



STEP INSIDE NEW CROSS ROAD

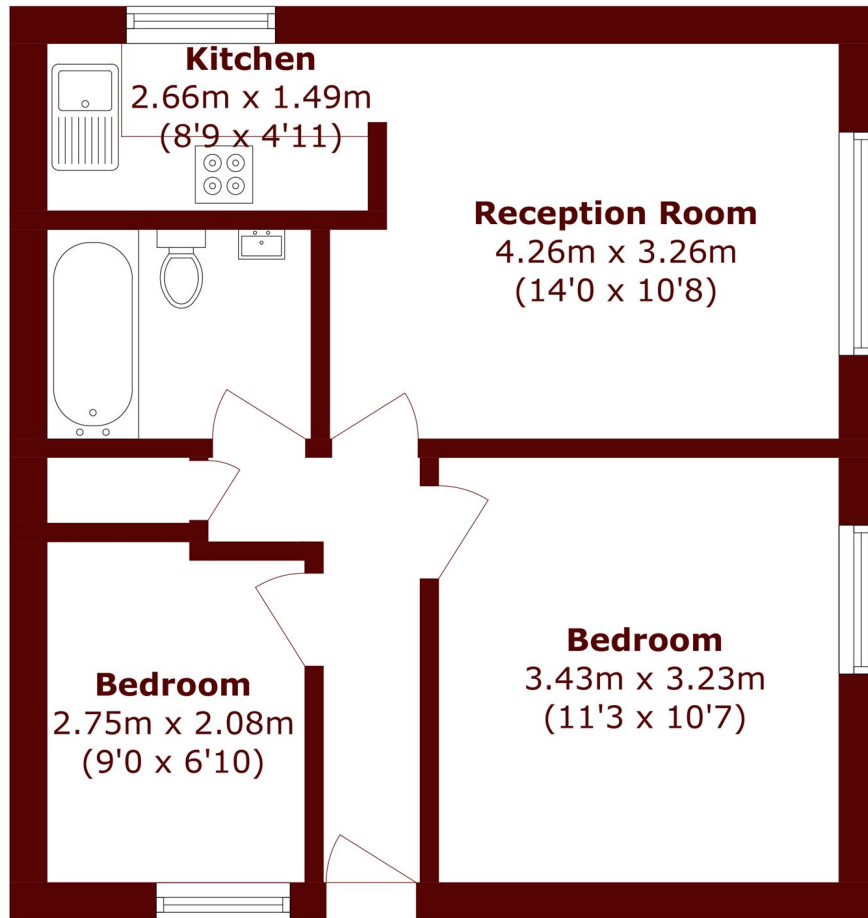

Total area (approx.): 43.2 sq. m (465.0 sq. ft)

Brockley
020 8629 8164

Energy Rating: C We aim to make our particulars both accurate and reliable. However, they are not guaranteed; nor do they form part of an offer or contract. If you require clarification on any points then please contact us, especially if you're traveling some distance to view. Please note that appliances and heating systems have not been tested and therefore no warranties can be given as to their good working order

**MARSH &
PARSONS**