



Neasham Road

Darlington DL1 4BL

£750 Per Calendar Month





This footer paragraph is an example only and should not be relied upon as complying with current legislation. These particulars, whilst believed to be accurate are set out as a general outline only for guidance and do not constitute any part of an offer or contract. Intending purchasers should not rely on them as statements of representation of fact, but must satisfy themselves by inspection or otherwise as to their accuracy. No person in this firms employment has the authority to make or give any representation or warranty in respect of the property.

Neasham Road

Darlington DL1 4BL



- 3 bedrooms
- Close To Local Amenities
- Council Tax Band A

- Terrace
- Close To Train Station
- Modern Kitchen

- Eastbourne Area
- Unfurnished
- Dining Room

A well-presented, three bedroom, terraced property in the Eastbourne area of Darlington. The property comes to the market unfurnished and is close to local amenities and schools, as well as being close to the train station.

Offering spacious living accommodation, the property enjoys two reception rooms, modern kitchen and three bedrooms, as well as large yard to the rear.

Externally, there is a forecourt to the front and large yard to the rear.

Council Tax Band A

Hallway

Lounge

14'5" x 11'0" (4.40 x 3.36)

Dining Room

14'2" x 10'10" (4.32 x 3.32)

Kitchen

11'1" x 6'5" (3.39 x 1.98)

First Floor

Bedroom One

12'9" x 9'11" (3.91 x 3.04)

Bedroom Two

11'0" x 10'10" (3.36 x 3.32)

Bedroom Three

9'5" x 7'0" (2.89 x 2.14)

Bathroom

Externally

Council Tax

Band A

Holding Deposit

All of our rental properties require a Holding Deposit equivalent to 1 week's rent. The Tenant is entitled for this Holding Deposit to be repaid within 15 calendar days of their application proceeding. However, in most cases we hope to repay this to the Tenant on the day you move in and this will be deducted from your first month's rent. This will need to be agreed with the Tenant during the application process.

You will lose your Holding Deposit if any of the following occurs:

1. You give us false or misleading information. For example, incorrect salary/income details or you fail to tell us about a CCJ.
2. You fail a Right to Rent check and are not eligible to reside in the UK.
3. You withdraw your application.
4. You fail to take steps to enter into the tenancy by taking an unreasonable amount of time to complete and submit your application form, failing to provide necessary ID and accompanying documents within a reasonable amount of time or being unable to provide a definitive move in date.*

*Please be aware that all of the above is also relevant to any guarantor applications that may support your tenancy.

Deposit (Bond)

The deposit (bond) amount is equivalent to 5 weeks' rent.

Venture Properties

We are Darlington's leading letting agent and are proud to be an independent company. What does this mean for tenants? If the property is managed by Venture Properties, you will be assigned your own Property Manager who will look after you during the duration of your tenancy. The staff will be located in our Darlington office and not in a call centre out of town, which you will get with some other agents. Our tenant credit/reference checks are also done in-house and not farmed out to a head office out of town or a third party. This means regular updates from local staff. Finally, our admin fees are transparent and there are no other hidden charges before you move in. Check this with other Agents as they often charge add-ons once you've applied for a property, such as a check-in fee, an inventory fee or even a fee for moving in on a Saturday.

Reposit - Rent without a deposit

This property is available to tenants using an alternative to the traditional deposit (bond) of 5 weeks' rent.

Using Reposit, tenants are only required to pay the equivalent of 1 week's rent (or £150, whichever is greater) as an alternative to paying the traditional deposit of 5 weeks' rent. For example, if the rent is £550, the Reposit will be the minimum payment of £150. If the rent is £750, the Reposit will be equivalent to one week's rent at £173.08.

There is no need to pay a deposit or bond. This is a one-off, non-refundable payment.

Please note that just like a traditional deposit, you are still liable for any valid, end of tenancy charges. The difference with Reposit is that you keep control of your money and only pay these if they actually occur at the end of your tenancy, rather than paying at the start.

Further information is available at www.reposit.co.uk/tenants.

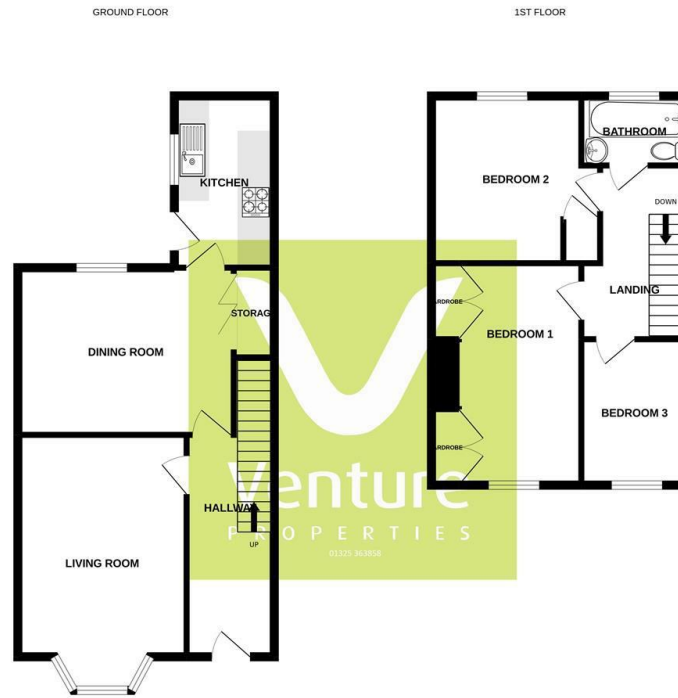

While every attempt has been made to ensure the accuracy of the floorplan contained here, measurements of doors, windows, doors and any other items are approximate and no responsibility is taken for any error, omission or misstatement. This plan is for general purposes only and should be used as a guide only for prospective purchasers. The services, fixtures and appliances shown have not been tested and no guarantee as to their operability or efficiency can be given. Make well telephone 0202

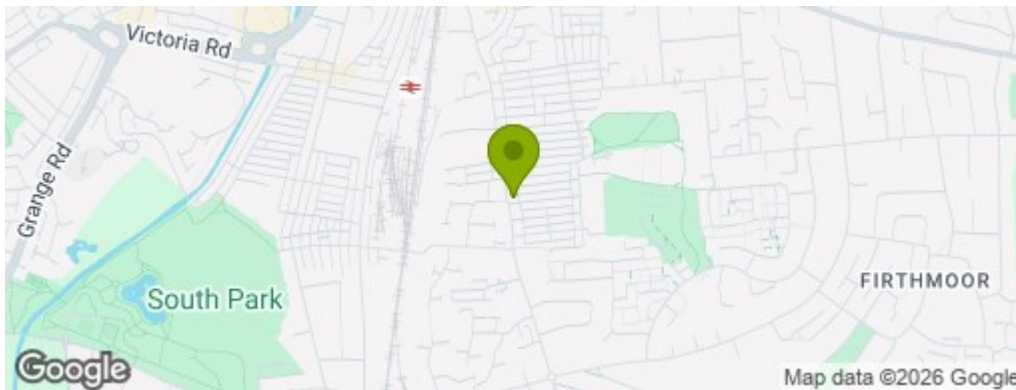

Property Information

01325 363858

45 Duke Street, Darlington, County Durham, DL3 7SD
enquiries@venturepropertiesuk.com