



## KING CHARLES WALK, SW19

£695,000

End of terrace  
Three bedrooms  
Garage  
Two balconies  
Private garden  
Energy rating: d

@marshandparsons  
marshandparsons.co.uk

MARSH &  
PARSONS



# ABOUT THE PROPERTY

Built over three floors with integral garage and two balconies, this end of terrace three bedroom property provides generous and versatile living accommodation. Requiring updating throughout it offers a blank canvas for an incoming buyer to create a wonderful family home in an extremely convenient location

King Charles Walk is perfectly placed for Southfields town centre for its array of independent shops, restaurants and the District line underground station. The open spaces of Wimbledon Park and Common are close at hand.



# STEP INSIDE KING CHARLES WALK

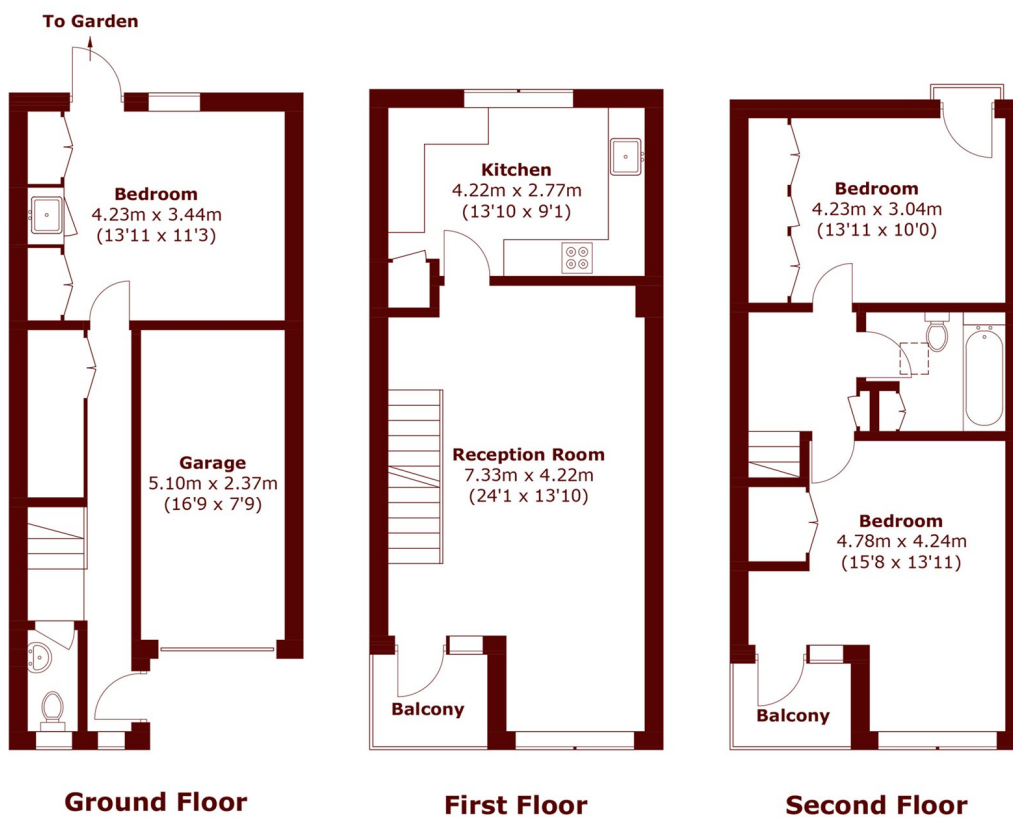

Total area (approx.): 106.7 sq. m (1,148.5 sq. ft)  
Garage: 12.1 sq. m (130.2 sq. ft)  
Total: 118.8 sq. m (1,278.7 sq. ft)  
Balcony: 5.5 sq. m (59.2 sq. ft)

Wimbledon  
020 8879 6660

Energy Rating: D We aim to make our particulars both accurate and reliable. However, they are not guaranteed; nor do they form part of an offer or contract. If you require clarification on any points then please contact us, especially if you're traveling some distance to view. Please note that appliances and heating systems have not been tested and therefore no warranties can be given as to their good working order

MARSH &  
PARSONS