



Hamilton Terrace, London
NW8 9RG
Asking price £11,950,000 Freehold



Nestled on the prestigious Hamilton Terrace, this remarkable Victorian detached house presents a rare opportunity for discerning buyers. Spanning an impressive 648.53 square metres (6,981 square feet), this stucco-fronted residence is designed for both luxurious living and entertaining. The property boasts a magnificent principal bedroom suite that occupies the entire first floor, offering a private retreat with ample space and elegance.

Set within a generous 0.23-acre plot, the house is surrounded by a stunning 32-metre (105-foot) west-facing garden, perfect for outdoor gatherings. The interior is presented in excellent condition, featuring spacious and thoughtfully arranged family accommodation across four levels. Additionally, the property comes with current planning consent to expand further at garden level, allowing for even more versatility.

Conveniently located on the sought-after west side of Hamilton Terrace, the home is just half a mile from the vibrant local shops and restaurants of Elgin Avenue, as well as the Madia Vale Underground Station on the Bakerloo Line. The American School in London, St John's Wood Underground Station (Jubilee Line), and the charming St John's Wood High Street are all within a short distance of 0.6 miles, making this location both desirable and practical.

This exceptional property is a true gem in one of London's most coveted areas, offering a blend of historical charm and modern convenience. It is an ideal choice for families seeking a spacious and elegant home in a prime location.



Hamilton Terrace,
St John's Wood, NW8
Approximate gross internal area
648.53 sq m / 6981 sq ft
(Including External Shower Room)
External Shower Room
1.67 sq m / 18 sq ft

Key:
CH - Ceiling Height

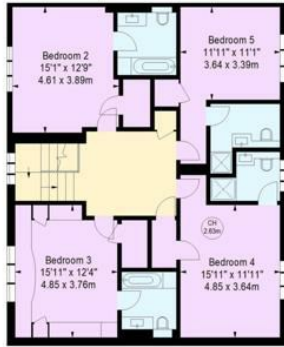

Second Floor



First Floor



Raised Ground Floor



Garden Floor

The floor plan is not to scale and measurements and areas shown are approximate and therefore should be used for illustrative purposes only. The plan has been prepared in accordance with the RICS code of Measuring Practice and whilst we have confidence in the information produced, it must not be relied on. If there is any aspect of particular importance, you should carry out or commission your own inspection of the property.
© Orange Tree Photography

MISREPRESENTATION ACT 1967 Ian Green Residential for themselves and for the vendors and lessors of the above property(ies), whose agents they are, give notice that:- (1) These particulars are intended only as a guide to prospective purchasers or lessors to enable them to decide whether to make further enquiries with a view to taking up negotiations. They do not constitute, nor constitute any part of an offer or contract. (2) All statements contained on these particulars as to this (these) property (ies) are made without responsibility on the part of Ian Green Residential or the vendors or the lessors. (3) None of the statements contained in these particulars as to this (these) property (ies) are to be relied upon as statements or representations of fact, nor should they be relied upon for any purpose whatever. Accordingly, neither their accuracy nor the continued availability of the property (ies) is in any way guaranteed and they are furnished on the express understanding that neither Ian Green Residential nor the vendor or lessor are to be or become under any liability or claim in respect of their contents. (4) The vendor or lessor does not hereby make or give nor do Ian Green Residential have any authority to make or give any representation or warranty whatsoever as regards to the property (ies) or otherwise. (5) Any intended purchaser or tenants must satisfy themselves by inspection or otherwise as to the correctness or each of the statements contained in these particulars. (6) In the event of the agents supplying any further information or expressing any opinion to a prospective purchaser or lessor whether oral or in writing such information or expression of opinion must be treated as given on the same basis as these particulars.

28 De Walden House, Allitsen Road, London, NW8 7BA

Tel: +44 (0)207 586 1000

ian@iangreenresidential.com

www.iangreenresidential.com



