

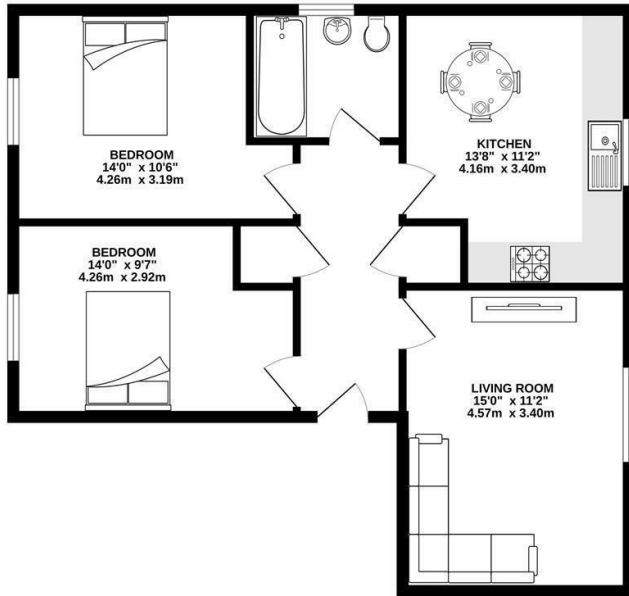

**Keith  
Ashton**

Whitefield Way, Kelvedon Hatch  
Brentwood

704 sq.ft. (65.4 sq.m.) approx.



TOTAL FLOOR AREA: 704 sq.ft. (65.4 sq.m.) approx.  
Measurements are approximate. Not to scale. Illustrative purposes only.  
Made with Metropac (2020)



### 5 Whitefield Way, Kelvedon Hatch, Brentwood, CM15 0FA

We are pleased to market this two, DOUBLE bedroom, first floor apartment which comes to the market, available to purchase on a 25% shared ownership scheme. Perfect for a first-time buyer; the shared ownership scheme is a great way to take your first step onto the property ladder, and subject to approval there may also be the opportunity to purchase the 100% share.

This spacious apartment consists of two double bedrooms both offering plenty of space for fitted or freestanding bedroom furniture. A spacious kitchen/diner which has been fitted in a range of cream gloss wall and base units, with integrated appliances to include double oven, hob with extractor above, fridge/freezer, washing machine and dishwasher, and a separate living room. Externally the property benefits from two allocated parking spaces, plus visitor parking and residents have the use of the communal gardens to the rear.

**\*\* Please note:** Applicants offering on the property will need to meet conditions and be approved by the housing association to proceed with any purchase.

### 25% Shared Ownership £85,000



Energy Efficiency Rating		Environmental Impact (CO <sub>2</sub> ) Rating	
Current	Potential	Current	Potential
Very energy efficient - lower running costs		Very environmentally friendly - lower CO <sub>2</sub> emissions	
(82 plus) <b>A</b>		(82 plus) <b>A</b>	
(61-81) <b>B</b>		(61-81) <b>B</b>	
(39-60) <b>C</b>		(39-60) <b>C</b>	
(19-38) <b>D</b>		(19-38) <b>D</b>	
(9-18) <b>E</b>		(9-18) <b>E</b>	
(1-8) <b>F</b>		(1-8) <b>F</b>	
(1-20) <b>G</b>		(1-20) <b>G</b>	
Not energy efficient - higher running costs		Not environmentally friendly - higher CO <sub>2</sub> emissions	
EU Directive 2002/91/EC	EU Directive 2002/91/EC	EU Directive 2002/91/EC	EU Directive 2002/91/EC
England & Wales	England & Wales	England & Wales	England & Wales

#### SERVICES:

Local Authority: Brentwood  
Council tax band: C  
Post code: CM15 0FA

#### VIEWING:

Strictly by prior arrangement with Keith Ashton Estate Agents

#### OPENING HOURS:

Monday to Friday: 8.45AM - 6.30PM | Saturdays: 9AM - 5.30PM | Sundays: 10AM - 2PM

**MORTGAGE INFORMATION:** We offer the additional facility of an in-house Independent Financial Adviser who will access all mortgage lenders with the purpose of providing you with the benefit of choice. For quotations or comparables please call 01277 375757 or visit our interactive website at [www.mortgagebusiness.net](http://www.mortgagebusiness.net)



We the Agent have not tested any apparatus, fittings or services for this property. The plot size is intended merely as a guide and has not been officially measured or verified by the Agent. Photographs are for illustration only and may depict items which are not for sale or included in the sale of the property. As part of the service we offer we may recommend ancillary services to you which we believe may help you with your property transaction. We wish to make you aware, that should you decide to use these services we will receive a referral fee. For full and detailed information please visit 'terms and conditions' on our website [www.keithashton.co.uk](http://www.keithashton.co.uk)

Brentwood  
Tel. 01277 260858

Village Office  
Tel. 01277 375757

Lettings Office  
Tel. 01277 202200

Explore more @ [www.keithashton.co.uk](http://www.keithashton.co.uk)

