



PENNETHORNE ROAD, SE15

£375,000

One bedroom apartment
Stylish victorian home
Private rear garden
Good size kitchen/diner
Located for stations
Energy rating: D

@marshandparsons
marshandparsons.co.uk

MARSH &
PARSONS



ABOUT THE PROPERTY

A one bedroom apartment set to the ground floor of an attractive Victorian terrace, with sole use of the rear garden, in a popular residential road of similar style properties. This stylish home features a good size kitchen/diner and the current owner has remodelled and refurbished the bathroom. Pennethorne Road is located in a low traffic neighbourhood.

Coodie coffee shop, Prince of Peckham and The Greyhound pub are nearby favourites whilst a walk away are found Peckham Levels and Copeland park with a good choice of eateries. The commuter will find Queens Road Peckham Overground, and Peckham Rye stations a distance, whilst there are ample amenities nearby.



STEP INSIDE PENNETHORNE ROAD

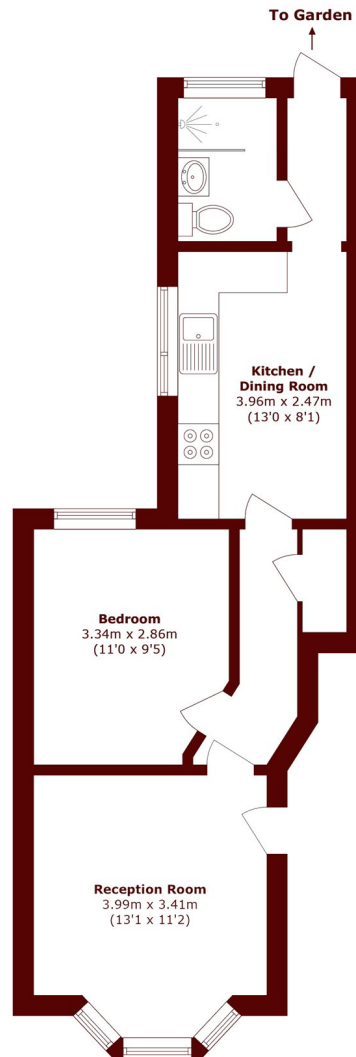

Total area (approx.): 42.3 sq. m (455.3 sq. ft)

Brockley
020 8629 8164

Energy Rating: We aim to make our particulars both accurate and reliable. However, they are not guaranteed; nor do they form part of an offer or contract. If you require clarification on any points then please contact us, especially if you're traveling some distance to view. Please note that appliances and heating systems have not been tested and therefore no warranties can be given as to their good working order

**MARSH &
PARSONS**