

# ATKINSON COURT

HAVANT ROAD | COSHAM | PO6 2HZ



£130,000  
LEASEHOLD

- One Bedroom Top Floor Retirement Flat
- Range of Communal Facilities
- Car Parking For Residents
- Easy Access To Local Amenities
- No Forward Chain
- Secure Entry System



## In Brief

We are pleased to bring to the market, this delightful One Bedroom Retirement Apartment, located in the popular complex of Atkinson Court.

The property is offered with no chain and boasts a range of communal facilities including:- large residents lounge (with kitchenette), laundry room, guest suite for relatives and friends to stay and a nearby hobbies room. The House Manager's office is located on the ground floor and there is a mobility scooter store located just outside the main entrance (with charging facilities).

The complex is situated within attractive and well tended communal gardens with resident's parking behind electronically operated gates.

The accommodation comprises:- Entrance Hall with storage cupboard, Lounge/Dining Room with Kitchen via Double Doors, Bedroom with Built-in Wardrobes, Bathroom and Storage Cupboard.

Atkinson Court is conveniently located close to local amenities and bus routes. We would recommend an early viewing to avoid disappointment.

£130,000

## KEY FACTS

Tenure : Leasehold

Ground Rent is: £197.50 per half year.

Service Charge is: £1,683.40 per half year includes water and sewerage.

Term of lease: 106 full years remaining.

Council Tax Band - C

EPC : B



# ATKINSON COURT

HAVANT ROAD | COSHAM | PO6 2HZ



## Ground Floor

Approx. 44.0 sq. metres (473.5 sq. feet)

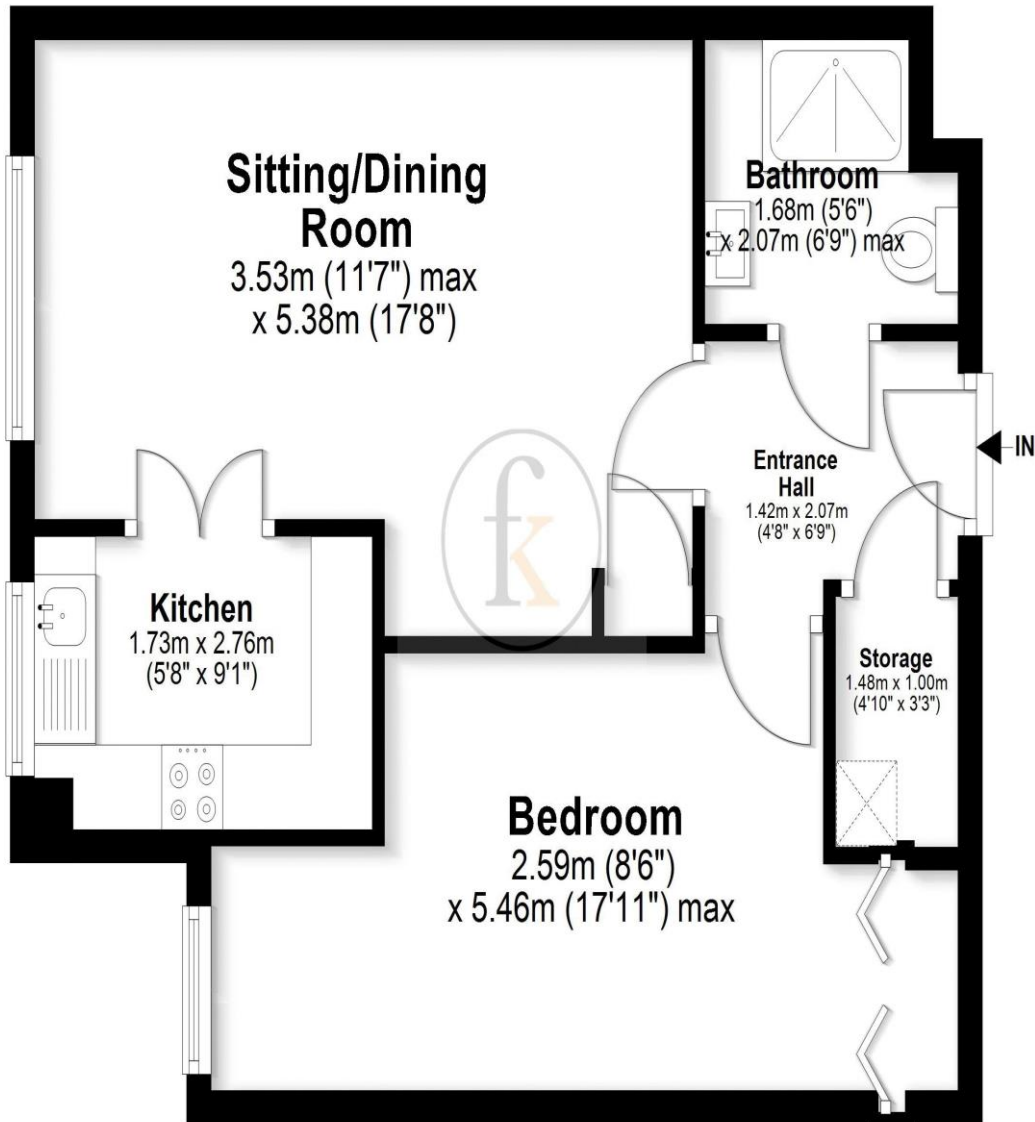

Total area: approx. 44.0 sq. metres (473.5 sq. feet)

Southsea  
Sales & Lettings  
7/9 Stanley Street,  
Southsea, PO5 2DS  
Tel: 023 9281 5221

Old Portsmouth & Gunwharf Quays  
Sales & Lettings  
The Seagull, 13 Broad Street,  
Old Portsmouth, PO1 2JD  
Tel: 023 9281 5221

Drayton & Out of Town  
Sales & Lettings  
139 Havant Road,  
Drayton, PO6 2AA  
Tel: 023 9221 0101

London  
Sales & Lettings  
Mayfair Office, Cashel House,  
15 Thayer Street, W1U 3JT  
Tel: 0870 112 7099

Southsea  
Admin Centre  
12 Marmion Road,  
Southsea, PO5 2BA  
Tel: 023 9282 2300

[www.fryandkent.com](http://www.fryandkent.com)