



City Road, London EC1V

Price £760 per week - Furnished





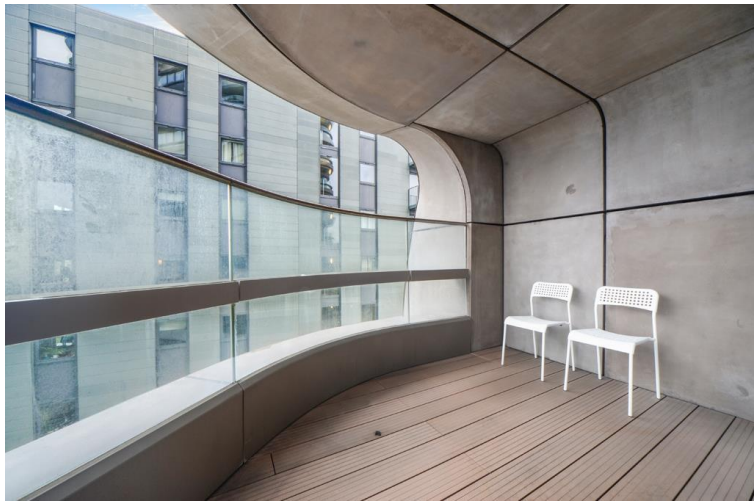

Description

A stunning 1 bedroom apartment, situated on the 9th floor of the sought after Canaletto.

This spacious apartment boasts approximately 659 square feet of living space, comprising 1 double bedroom with large fitted wardrobes, luxury en-suite bathroom, wood flooring throughout, contemporary fitted kitchen and balcony with stunning views over City basin.

Canaletto has a high specification with comfort cooling / heating and the latest smart home technology. The development benefits from 24 hour concierge and also features a private resident's club on the 24th floor and a private on site cinema, gym, pool, spa and entertainment lounge. Canaletto is ideally situated for Shoreditch (0.6 miles), Old Street station (0.4 miles).

We understand that heating, hot water and cooling is delivered via a communal system for which separate charges apply.

Council tax band: E. Rent is payable on a monthly basis and you may be required to pay more than a month's rent in advance, depending on your circumstances. You will be required to pay a 1 week holding deposit following a successful offer. Tenancies with annual rents up to £50,000 will require a 5 weeks' security deposit, while those exceeding this threshold will require a 6 weeks' deposit. Utility bills, council tax, telephone line and broadband are not included in the rent. As well as paying the rent, you may also be required to make some additional permitted payments. If your tenancy does not qualify as an AST, additional fees may apply. Please visit jll.co.uk/fees for details of fees that may be payable when renting a property. To check broadband and mobile phone coverage please visit Ofcom here ofcom.org.uk/phones-telecoms-and-internet/advice-for-consumers/advice/ofcom-checker

- 1 Bedroom
- 1 Bathroom
- 9th Floor
- Balcony
- Onsite private cinema
- 24 Hour concierge
- 0.6 miles from Shoreditch station
- Approx. 659 sq ft (61.2 sq m)
- Furnished
- EPC: B

Floorplan

659 sq ft | 61 sq m

CANALETTO TOWER

APPROXIMATE GROSS INTERNAL FLOOR AREA 659 SQ.FT (61.2 SQ.M)

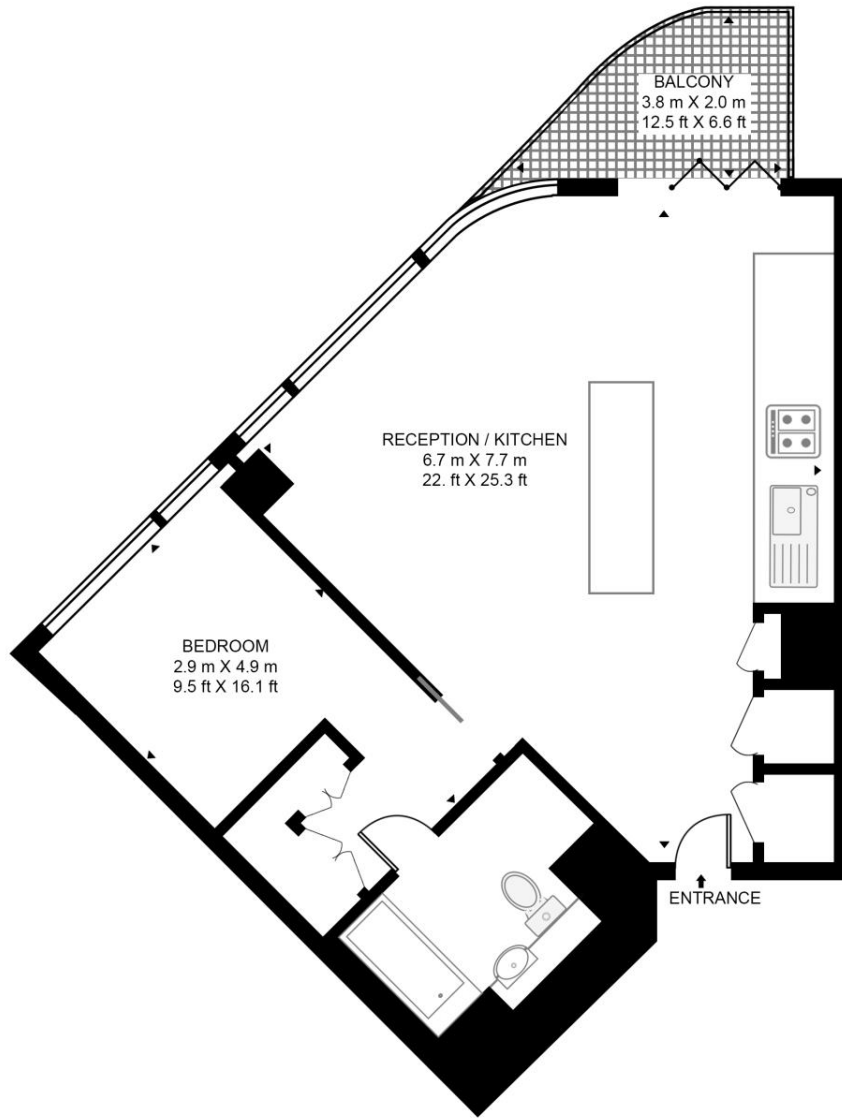

NINTH FLOOR



This floor plan has been defined by the RICS Code of Measurement. This floor plan and all others are for approximate representative purposes only and upon usage is agreed to as such by the client.
WWW: hdvirtualart.com | TEL: 0203.974.1567 | EMAIL: info@hdvirtualart.com

City
25 Walbrook The Walbrook
Building,
London EC4N 8AF
+4420 7337 4000

Urban living, your way.

jll.co.uk/residential

© 2019 Jones Lang LaSalle IP, Inc. All rights reserved. All information contained herein is from sources deemed reliable; however, no representation or warranty is made to the accuracy thereof.

