



6, Cadman Place, The Old Meadow, Shrewsbury, SY2 6AN
£450,000



6, Cadman Place, The Old Meadow, Shrewsbury, SY2 6AN

£450,000

A beautifully presented recently built four bedroom town house situated within this prestigious gated development overlooking superb landscaped grounds, River Severn and Shrewsbury town centre.

Description

Entrance hall, cloakroom, kitchen/dining room, first floor living room with balcony, cloakroom, master bedroom with balcony, dressing area and en-suite, 3 further bedrooms, 1 with en-suite, family bathroom, driveway, integral garage, private garden, double glazed windows, gas fired central heating.



null

Council Tax Band: D

Available:

EPC: C

Floor Plans

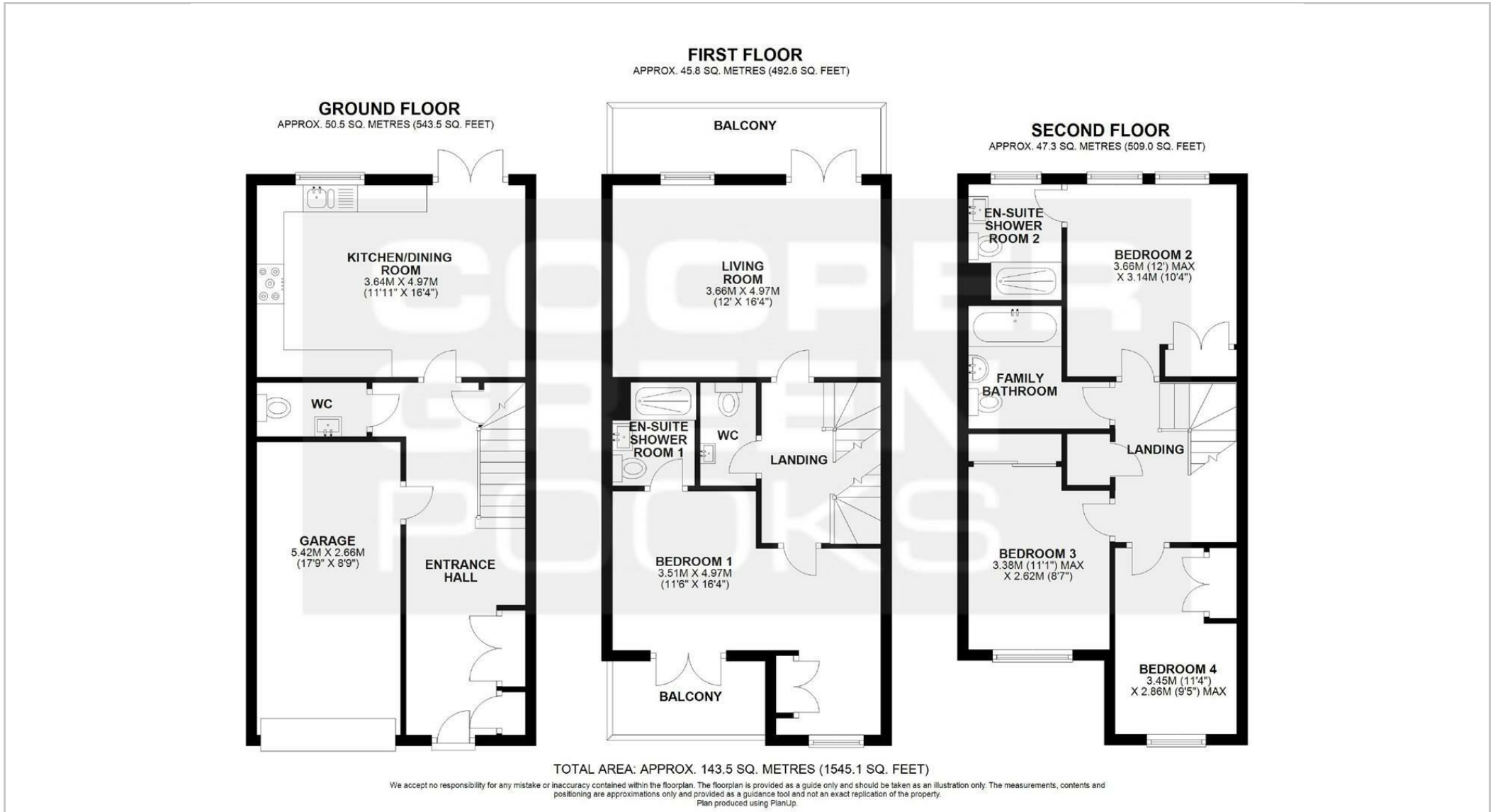

These particulars, whilst believed to be accurate are set out as a general outline only for guidance and do not constitute any part of an offer or contract. Intending purchasers should not rely on them as statements of representation of fact, but must satisfy themselves by inspection or otherwise as to their accuracy. No person in this firm's employment has the authority to make or give any representation or warranty in respect of the property.