



Fairbourne Road, SW4

£585,000

There is an option of 60% shared ownership available for this property. This superb contemporary apartment is situated within a desirable, private development and is presented in excellent order throughout. Comprising a large open plan reception room with a well-equipped kitchen and adjoining outside space (terrace), a principal bedroom with an en suite shower room and fitted wardrobes, a further double bedroom and a family bathroom.

Fairbourne Road is situated just off the Kings Avenue, conveniently located for easy access to Clapham High Street, Abbeville Village and Brixton, nearby transport links include Clapham Common (Northern line) and Brixton (Victoria line).

Features

- Modern Apartment
- Two Bathrooms
- Allocated Underground Car Parking
- Secure Bike Storage
- Outdoor Storage

Fairbourne Road, London, SW4

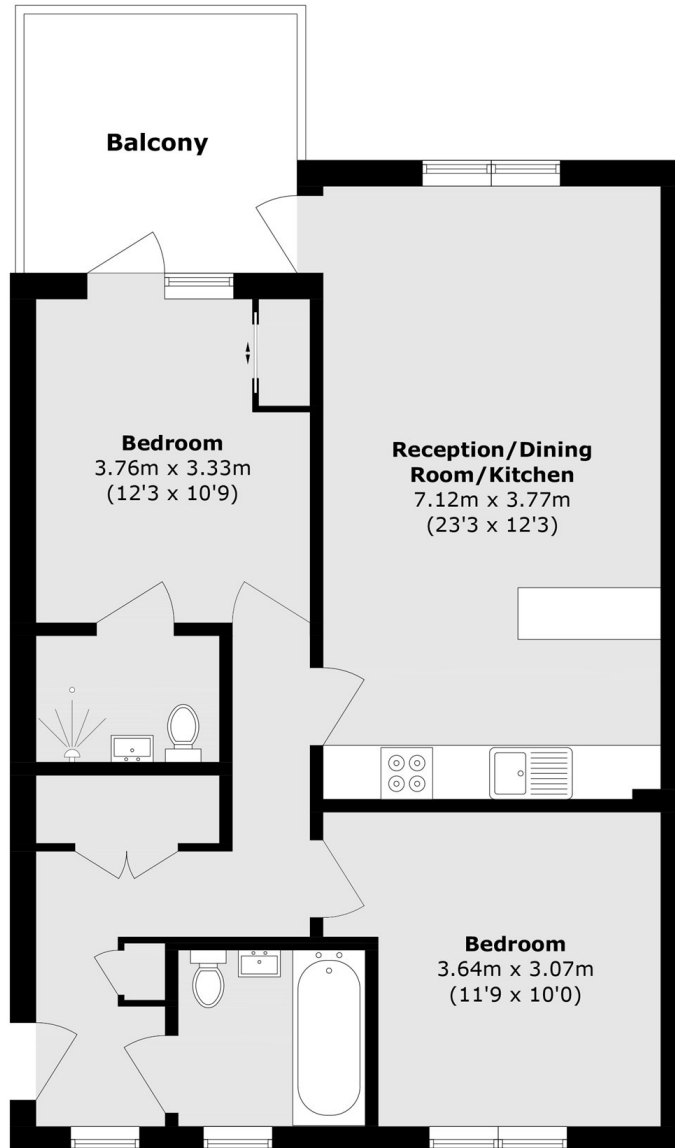

Total area (approx.): 74.8 sq. m (805.1 sq. ft)
Balcony area (approx.): 9.5 sq. m (102.2 sq. ft)