



157 Christchurch Road

Ashford, TN23 7UY

Guide Price £325,000

GUIDE PRICE £325,000 - £350,000

An attractive end of terrace home close to Victoria Park, offered for sale with no onward chain.

The property comprises an entrance hall, sitting room, dining room, kitchen, utility, cloakroom, three bedrooms and first floor bathroom/WC. A generous garden can be found to the rear which enjoys a southerly aspect, whilst the property has gas central heating and double glazing installed.

Ashford town centre and mainline station are just a short walk away along with the renowned McArthurGlen designer outlet.

Viewing

Please contact our Ashford Office on 01233 646411 if you wish to arrange a viewing appointment for this property or require further information.

- SPACIOUS END OF TERRACE HOUSE
- THREE BEDROOMS
- SITTING & DINING ROOM
- UTILITY & CLOAKROOM
- GENEROUS REAR GARDEN
- GAS CENTRAL HEATING & DOUBLE GLAZING
- SHORT WALK FROM TOWN CENTRE & MAINLINE STATION
- NO ONWARD CHAIN



Floor Plan

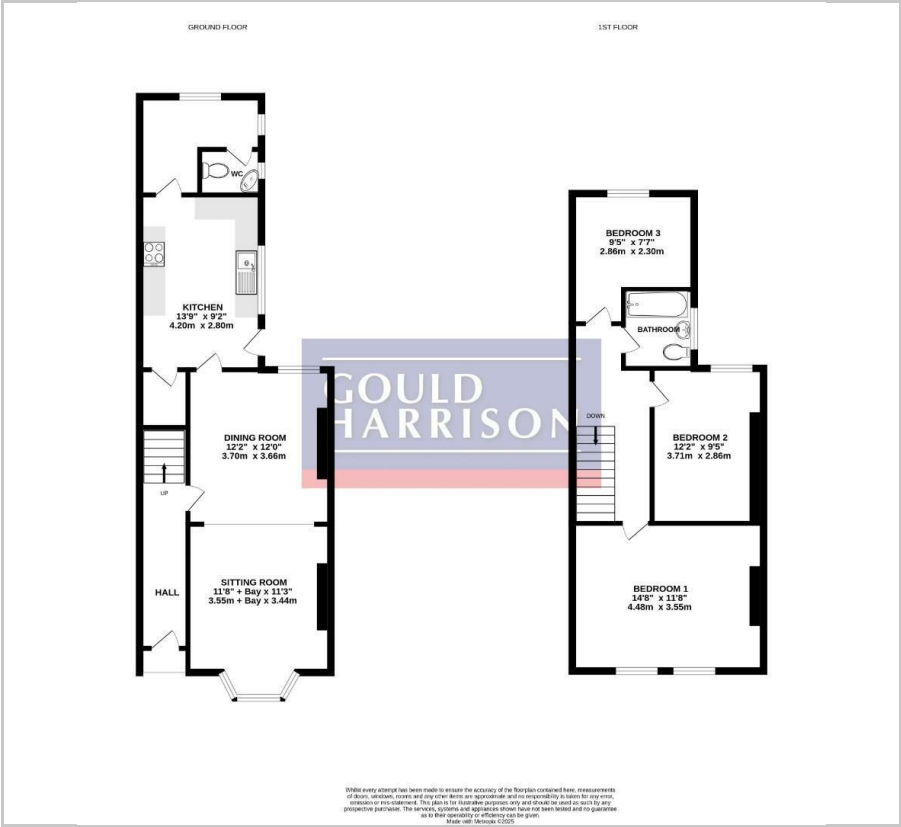

Area Map



Energy Efficiency Graph

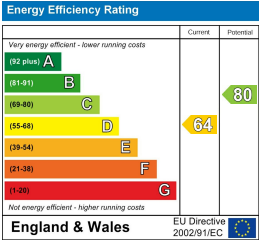

These particulars, whilst believed to be accurate are set out as a general outline only for guidance and do not constitute any part of an offer or contract. Intending purchasers should not rely on them as statements of representation of fact, but must satisfy themselves by inspection or otherwise as to their accuracy. No person in this firm's employment has the authority to make or give any representation or warranty in respect of the property.