



**South Road, Marden, Tonbridge, TN12 9EN**  
**Price £375,000**



\*\*\*NO FORWARD CHAIN\*\*\*

Situated in a sought-after position within the popular village of Marden, this three-bedroom semi-detached home offers an exciting opportunity for buyers looking to modernise and create a property tailored to their own tastes and requirements. Occupying a generous plot, the property also presents excellent potential to extend, subject to the necessary planning consents.

The accommodation currently comprises a lounge, separate dining room, kitchen, utility area and conservatory to the ground floor, whilst upstairs offers three bedrooms and a family bathroom with separate w/c/ Externally, there are useful outbuildings including a shed and greenhouse, together with established gardens offering plenty of outdoor space.

The property is ideally positioned for enjoying all that Marden has to offer. The village remains highly regarded for its balance of countryside surroundings and convenience, with a range of local shops, cafés, pubs and everyday amenities all within easy reach. Marden railway station provides direct mainline services into London Charing Cross and Cannon Street, making the area particularly appealing for commuters.

Families are well catered for with a selection of local schooling nearby, including Marden Primary Academy, whilst the surrounding area also offers access to a range of secondary and grammar schools in Maidstone and Tonbridge.

Offering huge potential in a desirable village setting, this is a home with fantastic scope for improvement and future enhancement.



**GROUND FLOOR**

Lounge 18'11" x 9'0" (5.79m x 2.75m)

Kitchen/Utility 15'11" x 14'3" (4.86m x 4.36m)

Dining Room 13'0" x 7'11" (3.97m x 2.42m)

Conservatory 12'9" x 4'8" (3.91m x 1.44m)

**FIRST FLOOR**

Bedroom 1 12'3" x 11'0" (3.75m x 3.37m)

Bedroom 2 12'2" x 8'11" (3.72m x 2.73m)

Bedroom 3 12'8" x 6'5" (3.87m x 1.97m)

Bathroom

Separate WC

**EXTERNALLY**

Shed 9'10" x 8'0" (3.00m x 2.45m)

Greenhouse 8'2" x 6'2" (2.50m x 1.90m)

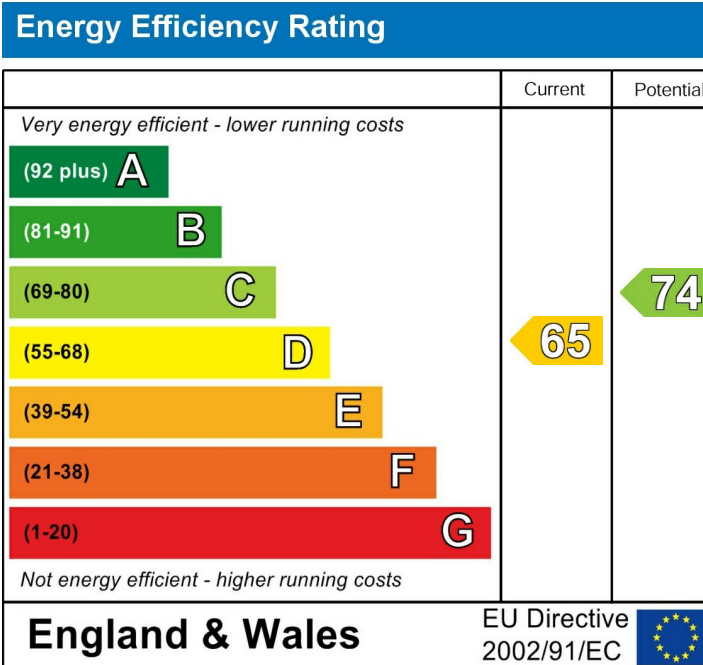

Page & Wells limited for themselves and for the vendors of this property whose agents they are give notice that: 1. These particulars do not constitute any part of, an offer or a contract. 2. All statements contained in these particulars as to this property are made without responsibility on the part of Page & Wells Limited or the Vendor. 3. None of the statements contained in these particulars as to the property is to be relied on as statements or representations of fact. 4. Any intending purchaser must satisfy himself by inspection or otherwise as to the correctness of each of the statements contained in these particulars. 5. The vendor does not make or give, and neither Page & Wells Limited nor any person in their employment has any authority to make or give any representation whatsoever in relation to this property. These particulars are supplied on the understanding that all negotiations are carried out throughout Page & Wells Limited. Properties with a reference prefixes EAA are those which Page & Wells Limited disclose an interest in accordance with the provisions of the Estates Agents Act 1979

South Road, Marden, Tonbridge  
 Approximate Gross Internal Area  
 Main House = 1045 Sq Ft/97 Sq M  
 Outbuildings = 130 Sq Ft/12 Sq M  
 Total = 1175 Sq Ft/109 Sq M

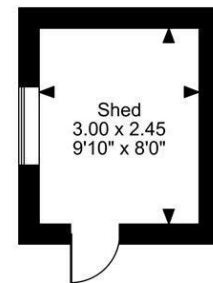
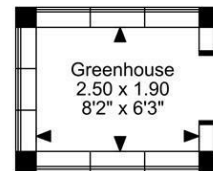
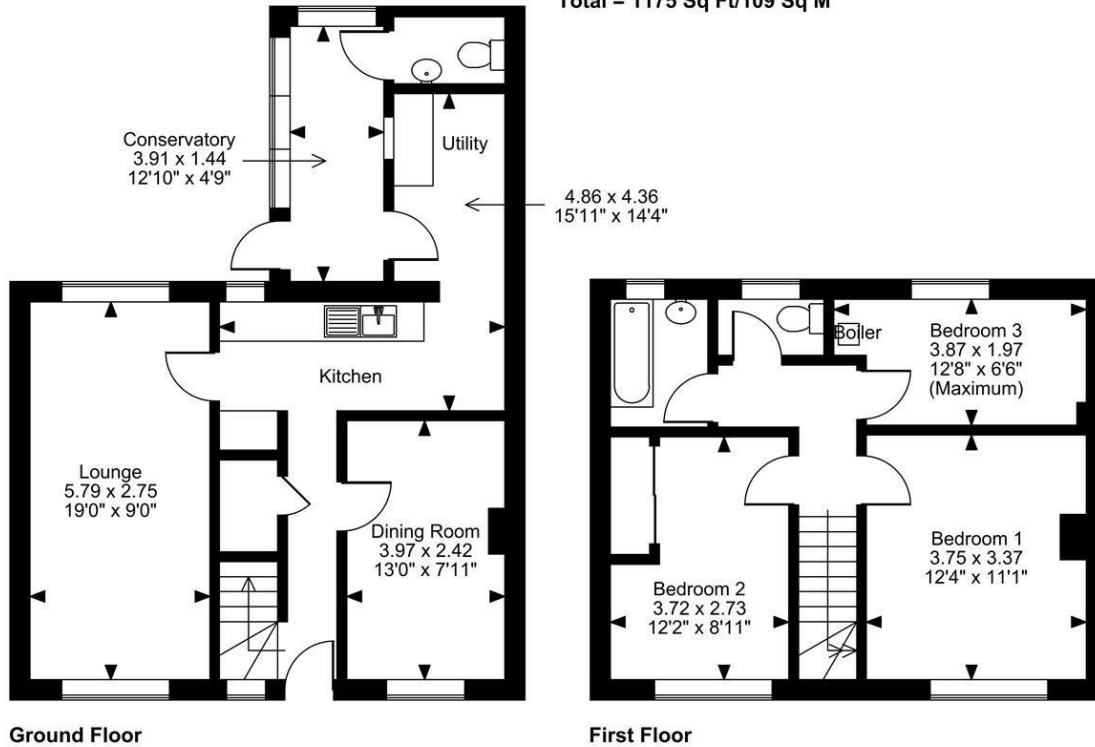
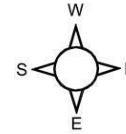

**FOR ILLUSTRATIVE PURPOSES ONLY - NOT TO SCALE**

The position & size of doors, windows, appliances and other features are approximate only.  
 © ehouse. Unauthorised reproduction prohibited. Drawing ref. dig/8692095/LCO