



£1,150 pcm

2 Bedroom Ground Floor Flat to rent

Flat 8 Express Buildings 2a, Howsell Road, Malvern





Overview

This fabulous 870sq ft, unfurnished, ground floor 2 large double bedroom modern flat, with it's own Private entrance door and open plan living, is now available for rent.



Key Features

- Large Double Bedrooms
- Modern , Open Plan Kitchen/dining/living
- Allocated Parking
- Large lobby area , providing extra space
- Private Front Door
- Easy access to Malvern Link Train Station
- Hard Floors Throughout
- Oven and Hob included in Island design Kitchen





This fabulous 870sqft ground floor 2 large double bedroom modern flat, unfurnished, with it's own Private entrance door is now available for rent.

Washing machine and Tumble dryer Laundry room access on first floor. Nominal payment required for use of laundry machines.

Open Plan Kitchen, Dining, living area, with Modern white Island Kitchen , including electric oven and hob.

The bedrooms are off to the right via a small lobby. Both are large doubles, with bedroom one facing the side of the building and bedroom 2, facing the front.

Large Family bathroom with over bath electric shower accessed from the left of the living area.

Are EWE looking for a large , spacious ground floor flat, in the centre of Malvern Link?

It's within 500 yards of the Malvern Link Train Station and around 750 yards from the Malvern link shops and main road.

Book to View

EPC E

Council Tax B £1804 2024

Broadband up to 1800mb available

Phones 02; Good, EE, Vodafone, Three; Okay

Water Bills included

Entrance Hall

19' 8" x 5' 2" (6.00m x 1.59m)

Kitchen/Dining/Living Room

26' 10" x 13' 10" (8.20m x 4.22m)

Bedroom 1

15' 1" x 12' 10" (4.60m x 3.92m)

Bedroom 2

10' 11" x 12' 10" (3.33m x 3.92m)

Family Bathroom

7' 2" x 8' 5" (2.20m x 2.57m)

Floorplans

GROUND FLOOR
870 sq.ft. (80.8 sq.m.) approx.

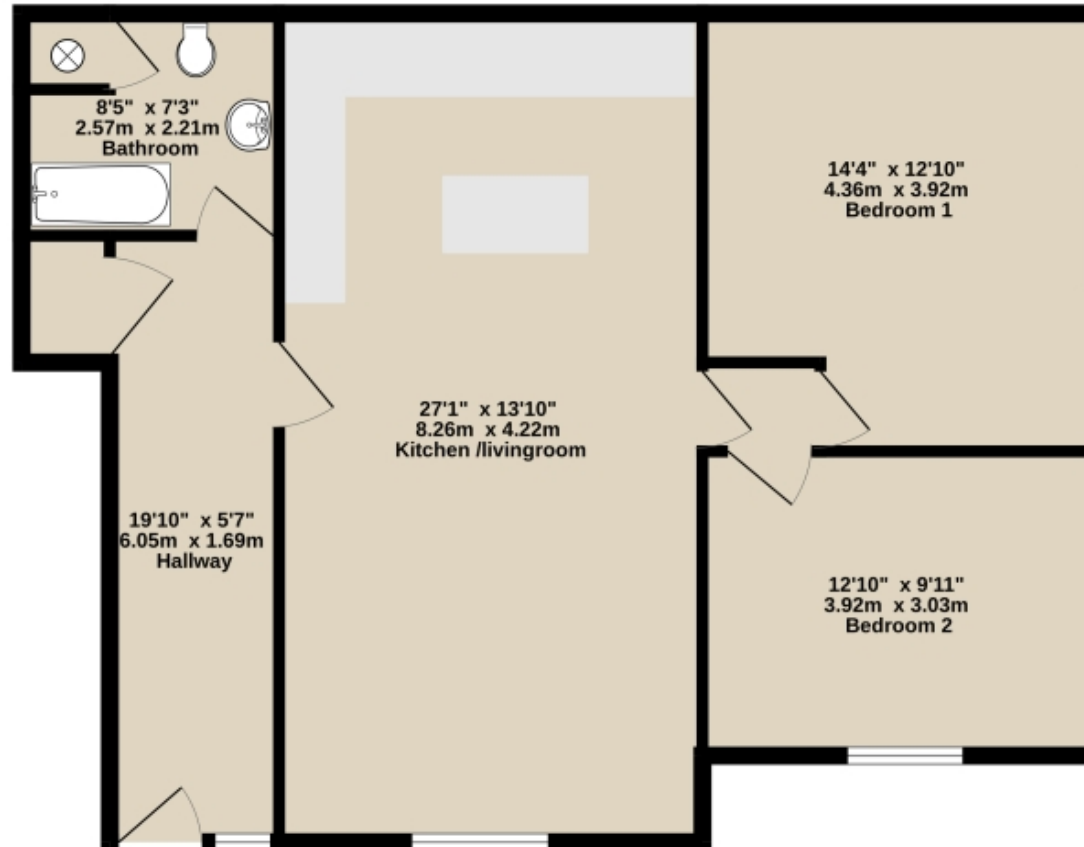

2 BEDROOM,1 BATHROOM, GROUND FLOOR

TOTAL FLOOR AREA: 870 sq.ft. (80.8 sq.m.) approx.

Whilst every attempt has been made to ensure the accuracy of the floorplan contained here, measurements of doors, windows, rooms and any other items are approximate and no responsibility is taken for any error, omission or mis-statement. This plan is for illustrative purposes only and should be used as such by any prospective purchaser. The services, systems and appliances shown have not been tested and no guarantee as to their operability or efficiency can be given.
Made with Metropix ©2023



Floorplans

GROUND FLOOR
870 sq.ft. (80.8 sq.m.) approx.

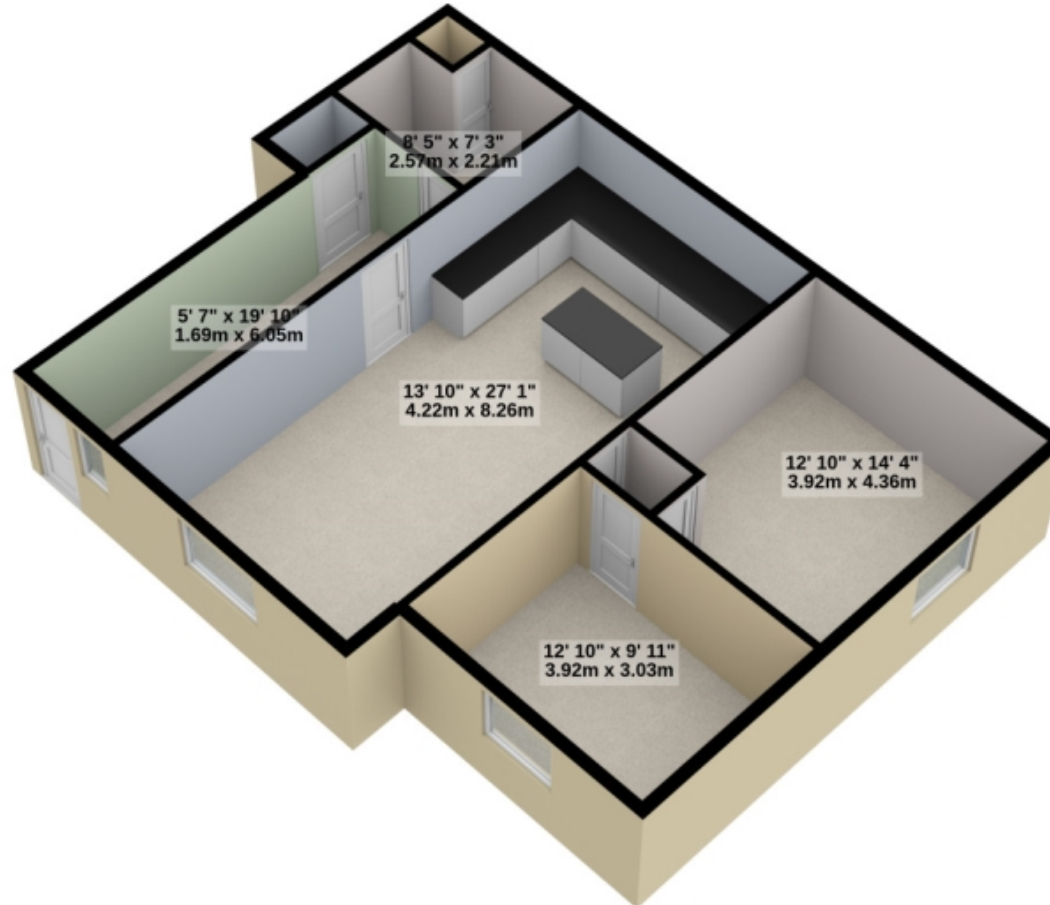

2 BEDROOM,1 BATHROOM, GROUND FLOOR
TOTAL FLOOR AREA : 870 sq.ft. (80.8 sq.m.) approx.

For illustrative purposes only. Decorative finishes, fixtures, fittings and furnishings do not represent the current state of the property. Measurements are approximate. Not to scale.

Made with Metropix © 2023

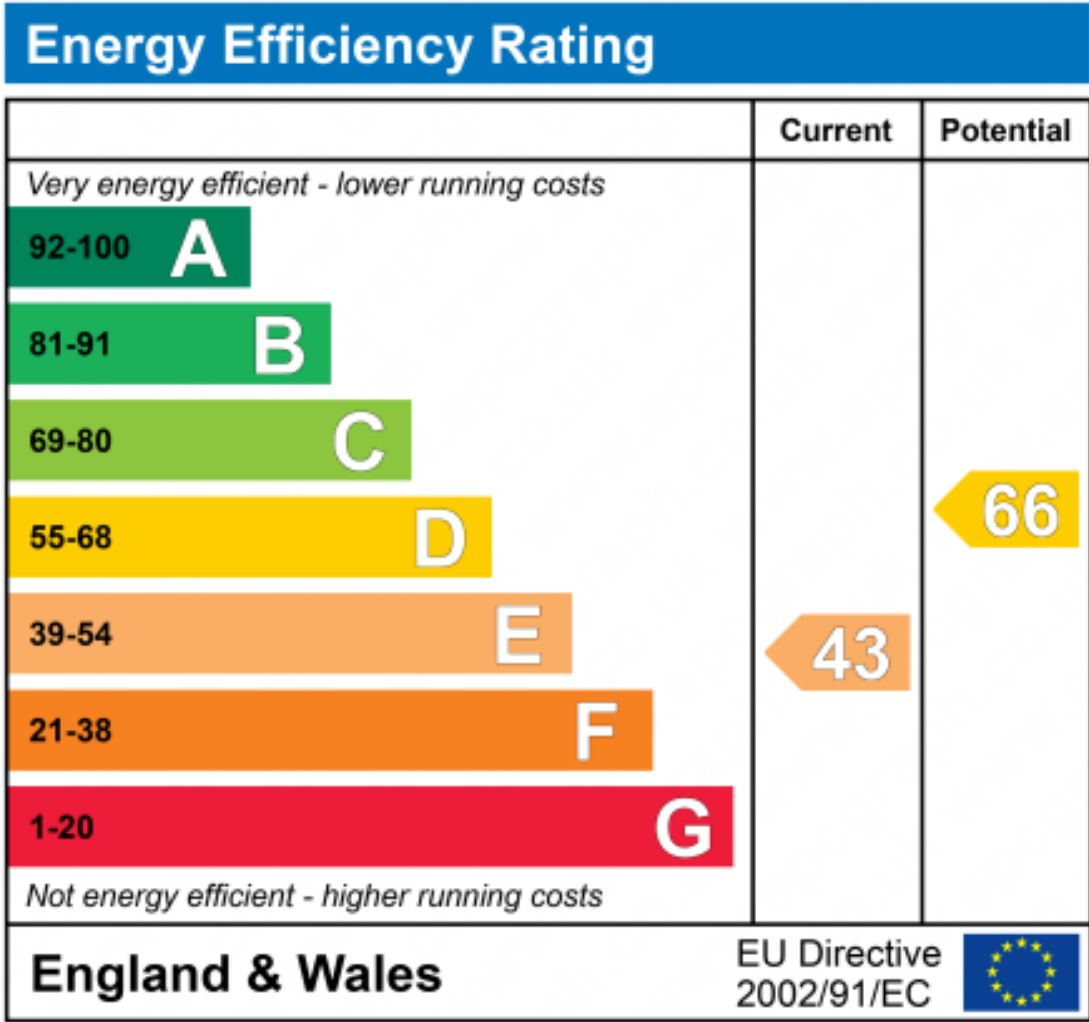



Marketed by Ewemove Worcester East

01905 967991 (24/7)

worcestereast@ewemove.com



EweMove

SALES AND LETTINGS