



**Upton Grange**  
Widnes

**£369,000**



**Bedrooms: 4**

**Bathrooms: 2**

**Receptions: 2**

A fabulous family home offering versatile living, ideally located within walking distance to local amenities.

This well-presented property offers generous living spaces, perfect for family life. The ground floor features two reception rooms, providing flexible options for entertaining or relaxation, along with a kitchen with an array of wall and base units with complementary work surfaces. A downstairs W/C and utility room completes the ground floor. Upstairs, there are four comfortable bedrooms, offering ample space for a growing family, complemented by two well-appointed bathrooms.

Externally, the property benefits from a driveway, providing convenient off-road parking and to the rear is a fabulous garden with seating area for al fresco dining.

With its practical layout and accessible location, this home is perfect for those seeking convenience and comfortable living. Early viewing is highly recommended to appreciate its full potential.







Approx Gross Internal Area  
111 sq m / 1192 sq ft

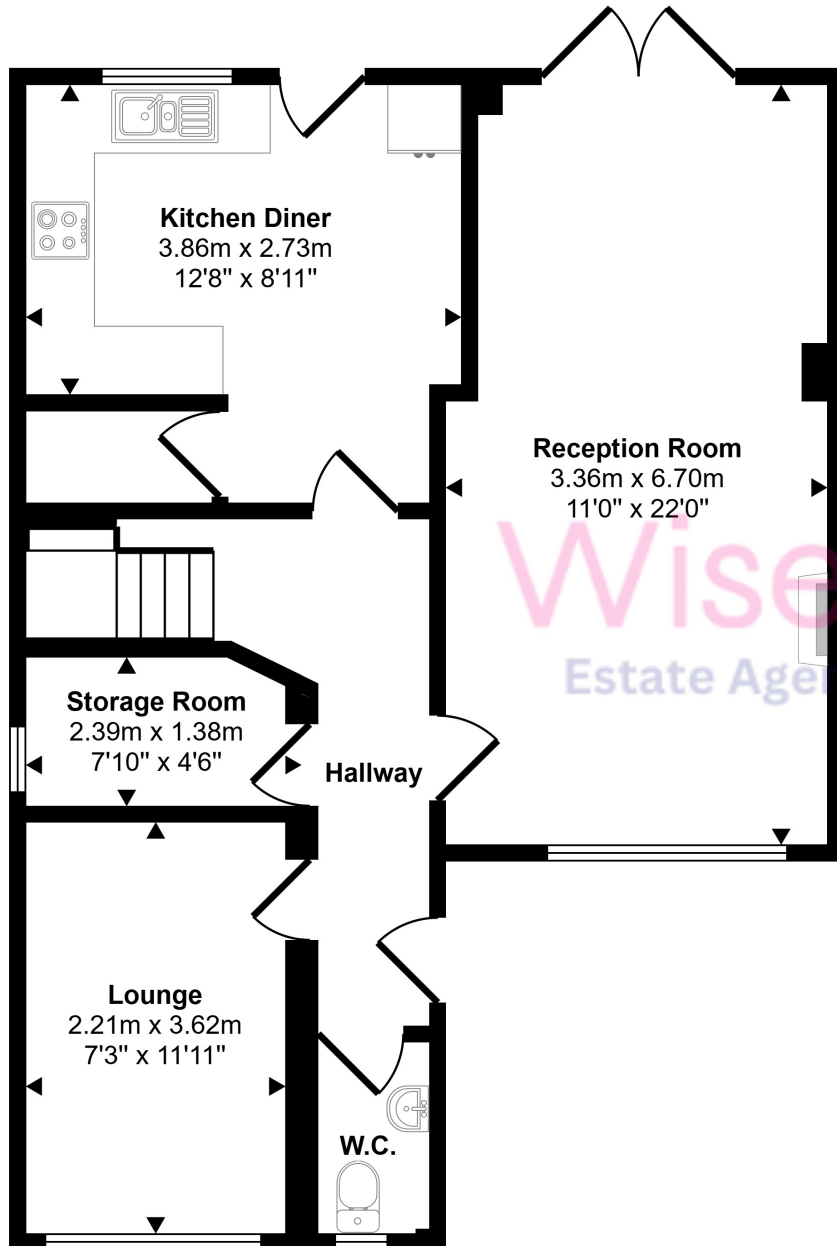

Ground Floor  
Approx 59 sq m / 638 sq ft

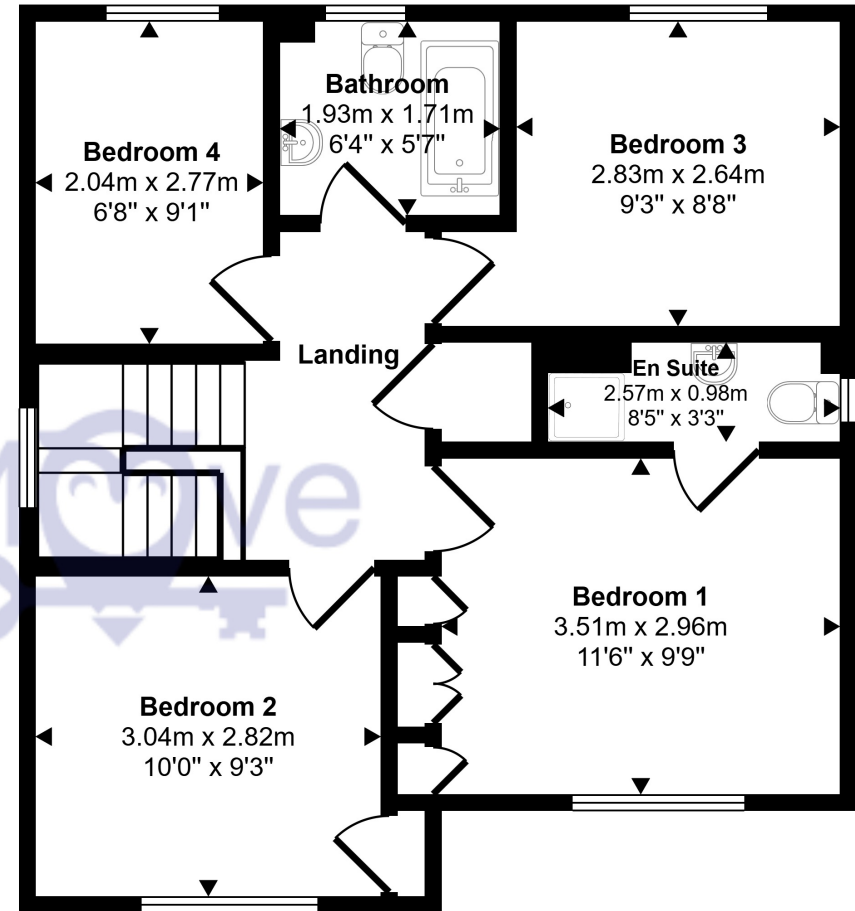

First Floor  
Approx 51 sq m / 554 sq ft