



## MAIDENSTONE HILL, SE10

£885,000

Victorian house  
Two bedrooms  
Extended to the rear  
Hand crafted kitchen  
Original features  
Energy rating: e

@marshandparsons  
marshandparsons.co.uk

MARSH &  
PARSONS

# ABOUT THE PROPERTY

Beautifully presented Victorian terrace house, extended to the rear, featuring an east facing garden and original features.

Greenwich rail and DLR stations are within walking distance, which is a pleasant walk passing the specialist shops along Royal Hill, including a green grocers, fishmonger and butchers. The town centre is also within a short walk, where you will find the covered market, Royal Naval college, Royal park, Greenwich pier and a wide range of riverside pubs and restaurants. Local primary schools include James Wolfe and Meridian.







# FURTHER DETAILS

The interior comprises a very spacious through lounge, a hand crafted kitchen/diner with bespoke concrete and glass work tops, bi-fold doors opening out to the garden, a family bathroom suite and two good size bedrooms, the principal includes tall, fitted wardrobes.

Added benefits include lots of storage, including the loft, recently decorated throughout and a lovely brick facade.



# STEP INSIDE MAIDENSTONE HILL

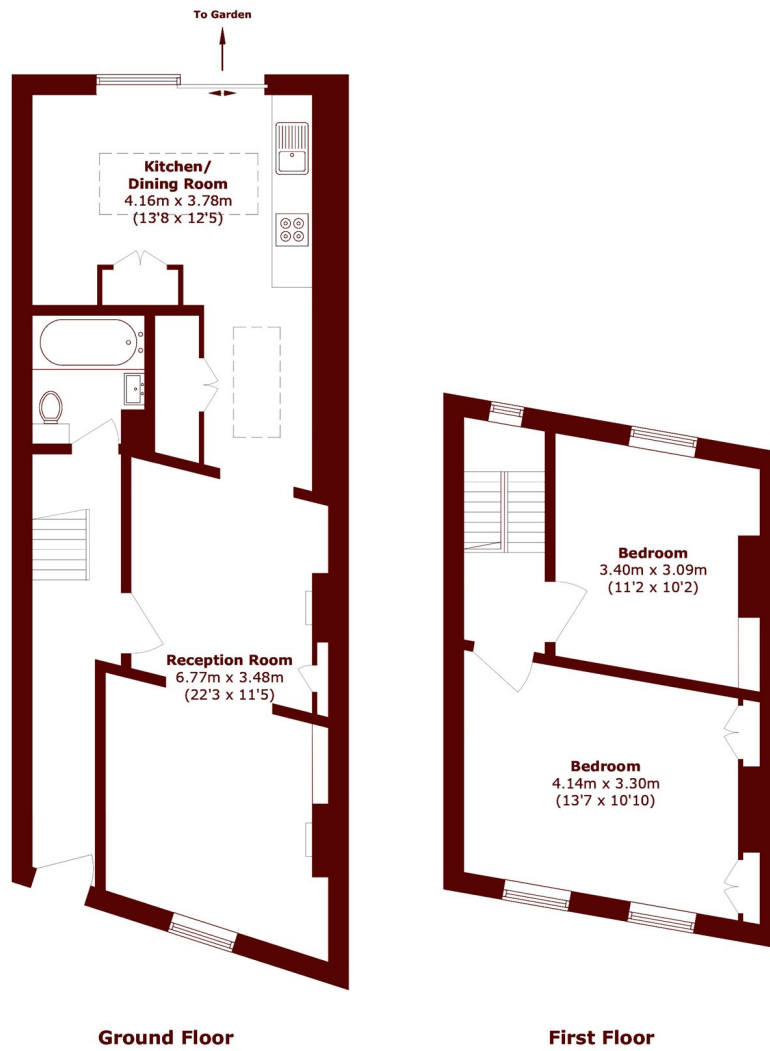

Total area (approx.): 83.3 sq. m (896.6 sq. ft)

Greenwich  
020 8312 8312

Energy Rating: E We aim to make our particulars both accurate and reliable. However, they are not guaranteed; nor do they form part of an offer or contract. If you require clarification on any points then please contact us, especially if you're traveling some distance to view. Please note that appliances and heating systems have not been tested and therefore no warranties can be given as to their good working order

MARSH &  
PARSONS