

3 Carnival Place, Fallowfield, Manchester, M14 7TN



**JP&Brimelow**  
ESTATE AGENTS

# Offers In The Region Of £280,000



\*\*\*VIDEO TOUR AVAILABLE\*\*\* A spacious THREE DOUBLE BEDROOM mid-terrace property, located in Fallowfield just a short drive from Manchester city centre. Close to fantastic transport links on Princess parkway, Alexandra Park with a selection of sports activities, Hough End leisure centre in the direction of West Didsbury and Divine Mercy Primary School. In brief the property consists of an entrance hall, a downstairs W.C, a lounge to the front aspect and a spacious, fully-fitted kitchen/ dining room with access out into the rear garden. Stair's leading to the first-floor landing reveal three bedrooms and three-piece bathroom. The property also benefits from gas fired central heating and a rear enclosed garden. Early viewing is highly recommended to fully appreciate all this property has to offer.





### EPC Chart

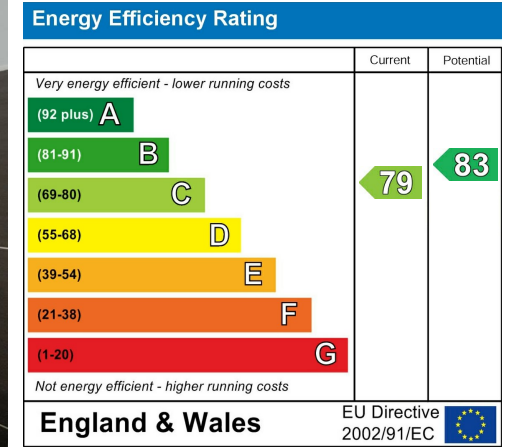

Tenure: **Leasehold** Council Tax Band: **C**

## Ground Floor

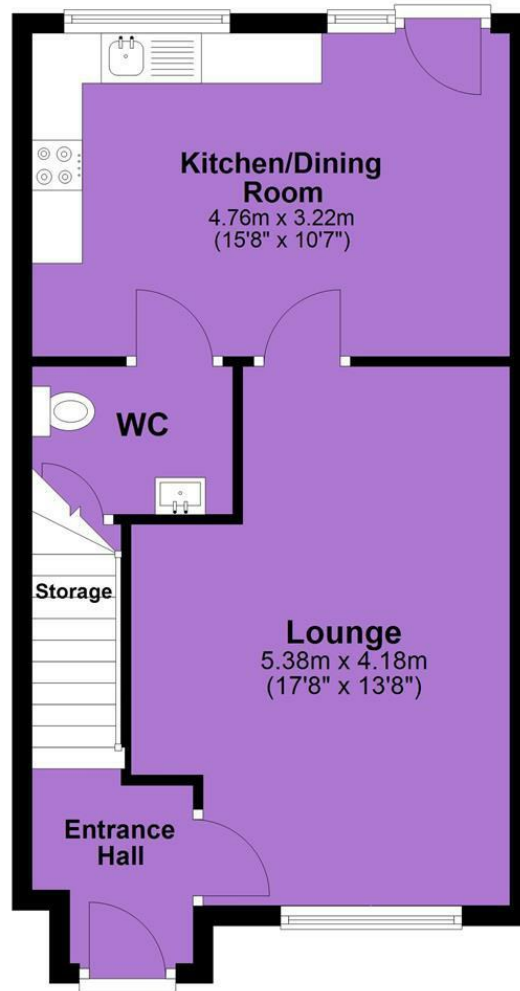

## First Floor

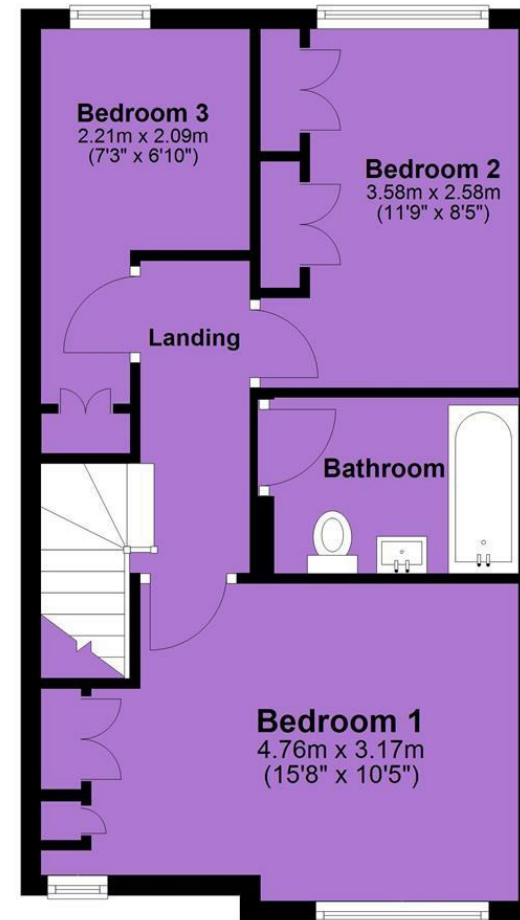

JP & Brimelow Estate Agents Ltd  
430 Barlow Moor Road, Manchester, M21 8AD  
Tel: 0161 8822233  
E: sales@jpbrimelow.co.uk www.jpandbrimelow.co.uk



**JP & Brimelow**  
ESTATE AGENTS

NOTICE: JP & Brimelow Estate Agents Ltd for themselves and for the vendors or lessors of this property whose agents they are give notice that:

- (i) the particulars are set out as a general outline only for the guidance of intending purchasers or lessees, and do not constitute, nor constitute part of, an offer or contract;
- (ii) all descriptions, dimensions, references to the condition and necessary permissions for use and occupation, and other details are given in good faith and are believed to be correct but any intending purchasers or tenants should not rely on them as statements or representations of fact but must satisfy themselves by inspection or otherwise as to the correctness of each of them;
- (iii) no person in the employment of JP & Brimelow Estate Agents Ltd has any authority to make or give any representation or warranty whatever in relation to this property.

jpandbrimelowstateagents

@jpandbrimelow