

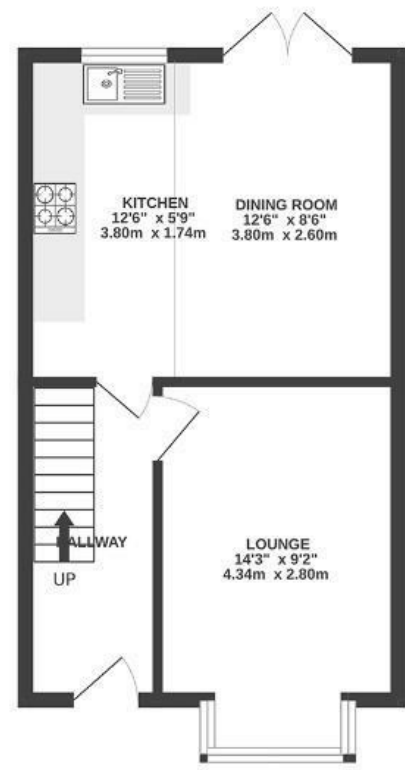

# Coleridge Road EASTVILLE

APPROXIMATE FLOOR AREA  
66 SQM / 715 SQFT

GROUND FLOOR  
362 sq.ft. (33.6 sq.m.) approx.



1ST FLOOR  
354 sq.ft. (32.9 sq.m.) approx.

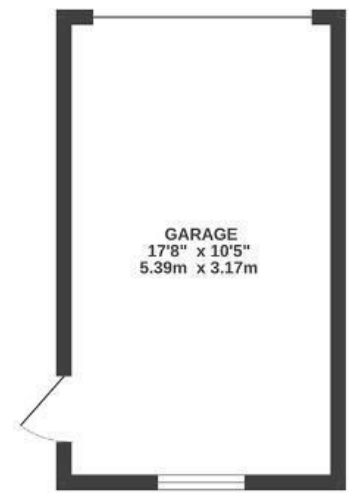
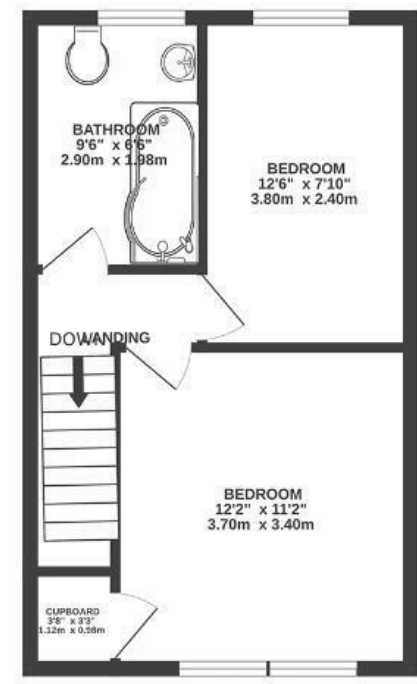

Boardwalk

# Coleridge Road , BRISTOL



£340,000



BS5 6SR



2 Bedrooms



1 Bathrooms

*"We've loved living here for the last 5 years. It's been a great place to start our family and we are really going to miss it. We have had so many happy memories here, from sitting in our back garden in the sunshine after our son had been born, trips to the park to see the birds at the lake and bike rides to Oldbury Court. Our home has been perfect for entertaining our friends and family but also for spending cosy nights in. Not to forget the great coffee and brunch spots around the corner."*

