



65A Berryfield Park, Melksham, SN12 6EE

£950 Per Month



- Two bedroom house
- Enclosed garden
- Pets not considered
- EPC - D (65)
- Allocated parking for two cars
- Longer term let preferred
- Council Tax - A (Wiltshire Council)

Discover Melksham: A Charming Wiltshire Town with Excellent Connectivity

Nestled along the banks of the River Avon, Melksham is a market town that blends historical charm with modern conveniences. It offers a welcoming community atmosphere complemented by a range of amenities.

Local Amenities and Lifestyle

Melksham boasts a high street filled with independent shops, cafes, and traditional pubs. For leisure and recreation, the town offers several parks and green spaces, including King George V Playing Field, which features a playground, skate park and is home to Melksham Parkrun. The nearby Melksham Community Campus enhances the town's leisure offerings with swimming pool, sports hall, gym and cafe.

THE PROPERTY

Welcome to 65a Berryfield Park, Melksham. A well presented two bedroom three storey home available for a longer term let.

The ground floor accommodation comprises an open plan living space with kitchen area, understairs storage cupboard and patio doors leading onto the rear garden. The first floor accommodation comprises landing, bedroom one with fitted cupboard, bathroom and access to the second floor via a spiral staircase. On the second floor is the second bedroom.

The property further benefits from allocated parking for two cars to the front of the property, gas central heating (combination boiler located bedroom two cupboard), double glazing and an enclosed rear garden.

The landlord would prefer a longer term let. Pets not accepted.

SITUATION

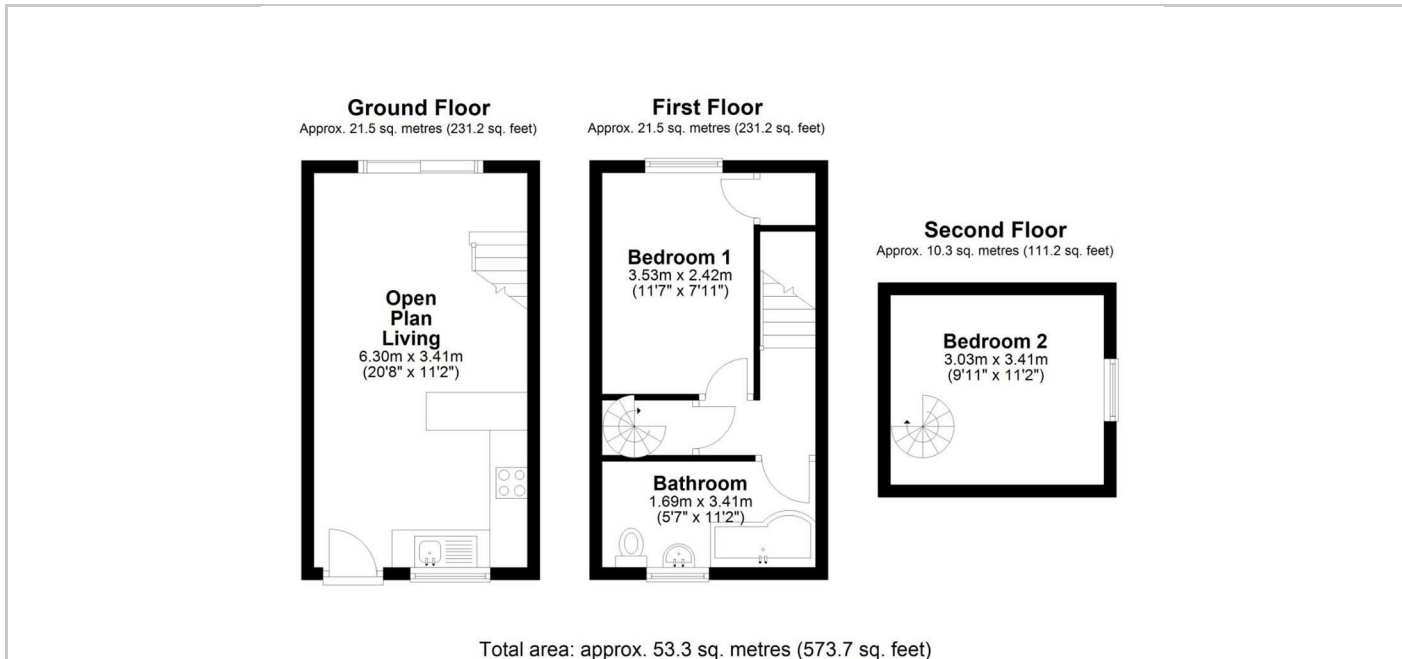

Directions