



11 Wordsworth Close, Ormskirk

Ormskirk

Guide Price £260,000

11 Wordsworth Close

Ormskirk

Extended three-bed semi with stylish open-plan kitchen, spacious living, integral garage, driveway, modern bathroom, and large private garden. Ready to move in. Early viewing advised.

Council Tax band: C

Tenure: Freehold

EPC Energy Efficiency Rating: D

EPC Environmental Impact Rating: D

- NO UPWARD CHAIN !
- SEMI DETACHED PROPERTY
- KITCHEN/DINER
- THREE BEDROOMS
- GARDENS FRONT & REAR
- CONVENIENT FOR ORMSKIRK TOWN CENTRE
- IDEAL FOR 1ST TIME BUYERS
- OPEN PLAN LIVING AREA





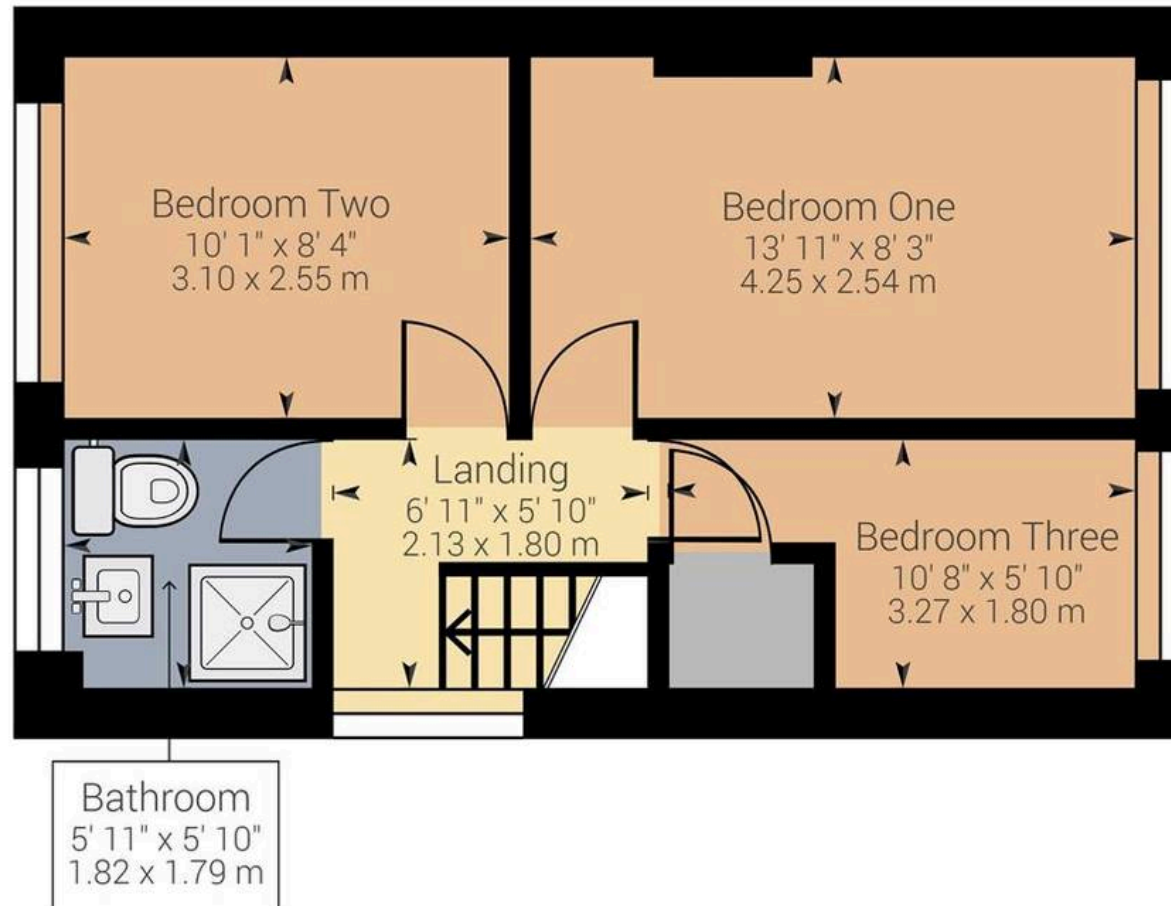

Approximate net internal area: 334.86 ft² / 31.11 m²

While every attempt has been made to ensure accuracy, all measurements are approximate, not to scale. This floor plan is for illustrative purpose only and should be used as such by any prospective tenant or purchaser.



Powered by Giraffe360



IAN ANTHONY

5 Burscough Street, Ormskirk - L39 2EG

01695580888

enquiries@iananthonyestates.co.uk

iananthonyestates.co.uk/

