



8 Barham Close

Bournemouth

Council Tax band: C

Tenure: Freehold

EPC Energy Efficiency Rating: C

EPC Environmental Impact Rating: C

- No Forward Chain
- Modern Freehold Terraced House
- Two Double Bedrooms
- Lounge With Double Doors To Private Garden
- Family Shower Suite & Downstairs WC
- Fully Fitted Kitchen Suite
- Allocated Parking Space
- Walking Distance To Kings Parks & Corpus Christi Primary School
- Short Distance To Both Boscombe & Southbourne High Street
- Close Proximity To Train/Bus Station, Parks & Award Winning Beaches





GROUND FLOOR
315 sq.ft. (29.3 sq.m.) approx.

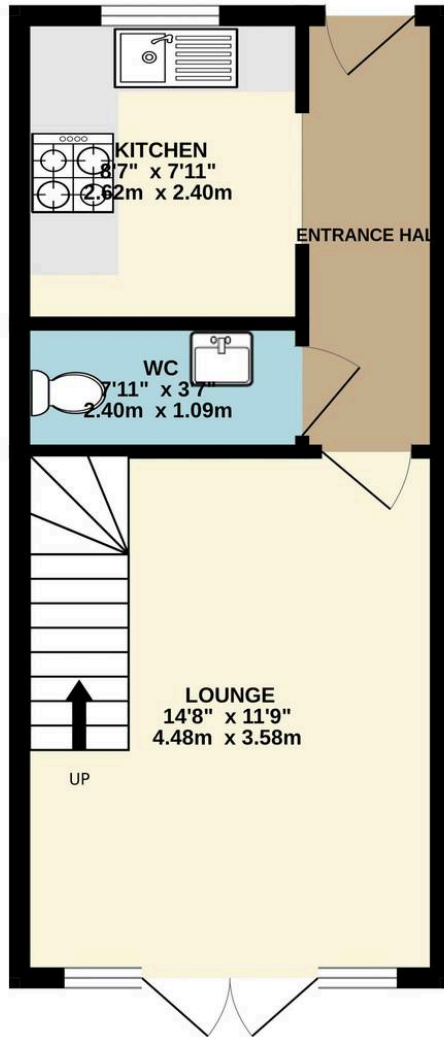

1ST FLOOR
315 sq.ft. (29.3 sq.m.) approx.

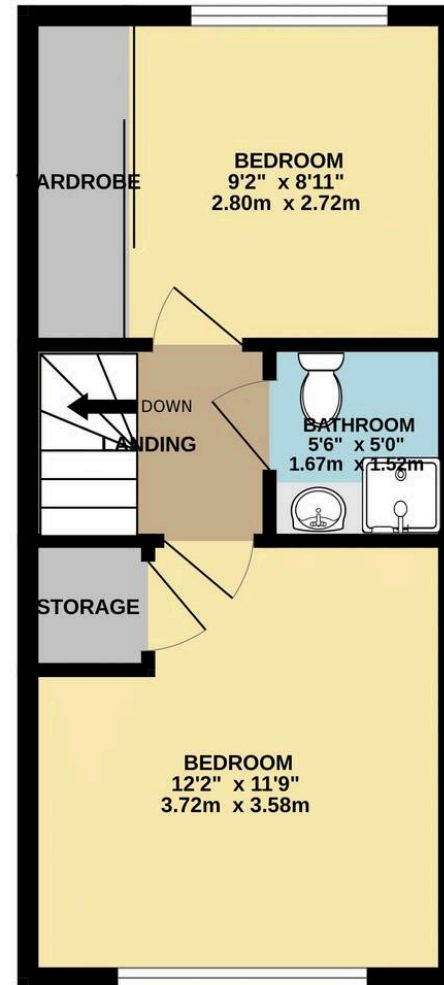

TOTAL FLOOR AREA : 631 sq.ft. (58.6 sq.m.) approx.

Whilst every attempt has been made to ensure the accuracy of the floorplan contained here, measurements of doors, windows, rooms and any other items are approximate and no responsibility is taken for any error, omission or mis-statement. This plan is for illustrative purposes only and should be used as such by any prospective purchaser. The services, systems and appliances shown have not been tested and no guarantee as to their operability or efficiency can be given.
Made with Metropix ©2025