



Hove Park Apartments, BN3

£600,000

ASTON  
VAUGHAN

## INTRODUCING

# Hove Park Apartments, BN3

3 Bedrooms | 2 Bathroom | 1 Reception Room

This beautifully presented three-bedroom apartment sits on the top floor of a recently built development on the desirable Goldstone Crescent. Set back from the road behind neatly maintained front gardens and a smart brick-paved driveway, the property enjoys an attractive outlook across the greenery of Hove Park.

Positioned within the southern block and accessed via a lift, the apartment offers generous living space arranged across three bedrooms and two bathrooms. A standout feature is the west-facing balcony, which provides impressive views over the treetops of Hove Park. Inside, the home has been finished with great attention to detail, combining oak parquet flooring in the main living spaces with plush carpeting in the bedrooms. The kitchen features stylish modern cabinetry, while both bathrooms are finished with contemporary tiling.

The open-plan living and kitchen area is bright and airy, benefitting from plenty of natural light throughout the day. Large floor-to-ceiling glass doors open directly onto the balcony, creating a seamless indoor-outdoor feel that's ideal for relaxing or entertaining. The kitchen itself includes high-quality integrated appliances and subtle recessed LED lighting.





The principal bedroom also opens onto the west-facing balcony through glazed doors and includes a sleek en suite shower room, finished with marble-effect tiling and a walk-in rainfall shower. Two additional bedrooms provide flexible space for guests, family, or a home office. A modern family bathroom completes the apartment and features a rainfall shower above a full-sized bath.

Hove Park Apartments are ideally positioned directly opposite the open green space of Hove Park, where residents can enjoy facilities such as tennis courts, a playground, a bowling green, and a popular park café. Everyday shopping is convenient with a nearby Waitrose, while a wide range of cafés, restaurants, and shops can be found at Seven Dials, Church Road, and Goldstone Villas. Hove seafront is also within easy reach. The area is well served by several highly regarded primary and secondary schools, making it a particularly appealing choice for families.

Newly built to sit sympathetically with neighbouring homes, the Goldstone Crescent apartment buildings bear decorative brickwork, quoin stones and gabled roofs, set back behind border walls and a neat brick drive. Looking out over the green and leafy environs of Hove Park, their location is prestigious and ideal for anyone looking to live the quintessential Hove lifestyle, close to the countryside, the city centre and the coast.







## Vendor's Comments:

"The location of these apartments is fantastic for both families and professionals due to the excellent school catchment and transport links. It feels wonderfully secure here, and really peaceful, yet the city with all its delights is just a short stroll away. Hove Park is also a joy throughout the year, hosting exercise groups, tennis courts and ample space for dog walks and for children to play."

## Education:

Primary: Brunswick Primary, Westdene Primary, Bilingual School

Secondary: Hove Park, Blatchington Mill, Cardinal Newman RC

Private: Brighton College, Lancing College Prep.

Exceptional and unique, these newly built apartments are situated in a popular area with lots of local amenities and green spaces on your doorstep – including the South Downs National Park which is just 10-minutes away by car. While they are peaceful and private inside, they sit in a central location remaining well-connected to the city by road, train or on foot, with the beach just 20-minutes' walk to the south. The local schools are amongst the best in the city with several highly acclaimed private schools also nearby, and the commute to London is less than an hour door to door from Hove Station. For families and professionals alike looking to live in a bespoke and luxurious home in this cosmopolitan coastal city – these apartments need to be seen to be admired.



# Goldstone Crescent

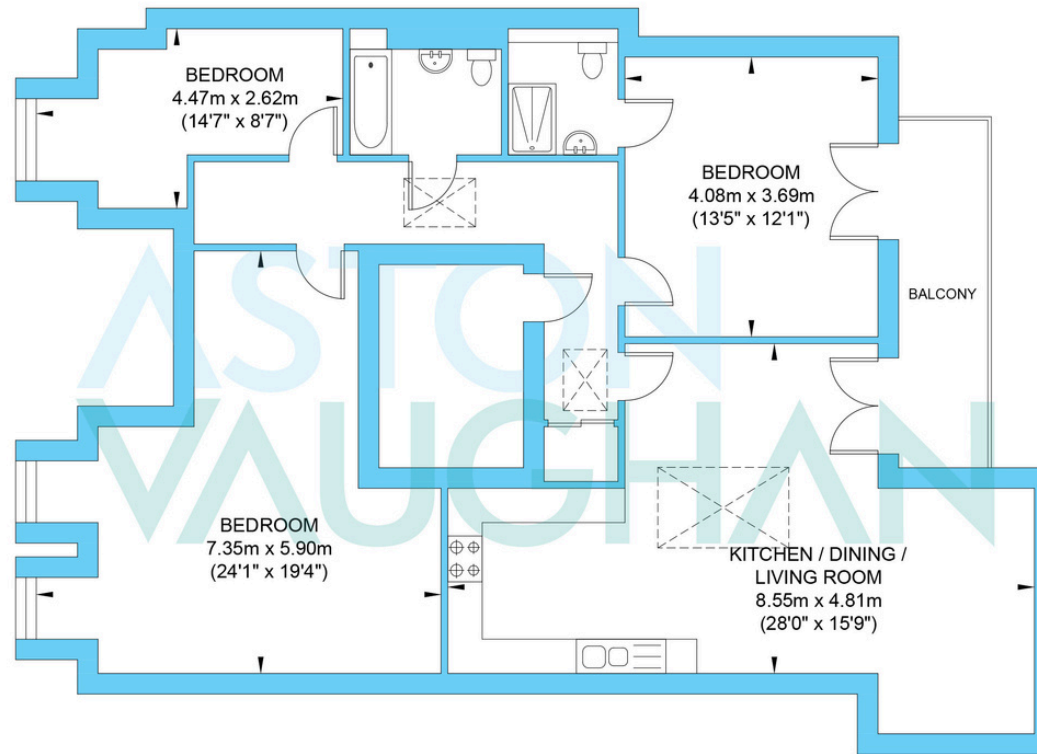

Third Floor  
Approximate Floor Area  
1199.74 sq ft  
(111.46 sq m)

Approximate Gross Internal Area = 111.46 sq m / 1199.74 sq ft  
Illustration for identification purposes only, measurements are approximate, not to scale.