



JOE JEZZARD

exp[®] UK

@ joe.jezzard@exp.uk.com

globe icon joejezzard.exp.uk.com

phone icon 07592 137 082

Singleton Close, Minster, Ramsgate

£385,000

🛏️ 4 🚿 2 🚗 1



Please Quote Ref: JJ1194

This four bedroom family home is situated in a quiet cul-de-sac within the sought after village of Minster. Singleton Close is located within walking distance of everything that Minster has to offer, such as shops, restaurants, pubs, village primary school and train station (0.4 miles).

The spacious accommodation totals 1453 sq. ft. (135 sq. m.) and comprises an entrance hall, a sitting room with open fireplace, an open-plan kitchen/breakfast area with access to the rear garden, a second reception room, and a downstairs cloakroom. On the first floor there are four bedrooms and a family bathroom. Three of the bedrooms are well proportioned double bedrooms with the fourth being a comfortable single bedroom or study. The principal bedroom benefits from an en suite shower room.

Outside, the property offers a South facing rear garden which incorporates a stone terrace and lawn, ideal for family use and outdoor entertaining. A driveway to the front provides off-street parking for a number of vehicles.

Identification Checks

If your offer on a property marketed by Joe Jezzard eXp is accepted, we'll need to carry out an identification check for all buyers. This is a legal requirement under Anti-Money Laundering (AML) regulations.

To make this process quick and secure, we use a trusted third-party specialist to verify your identity. The cost is £30 including VAT per buyer, which is payable once your offer has been agreed and before the sales memorandum is issued. Please note that this fee is non-refundable.



Singleton Close, Minster, Ramsgate, CT12

Approximate Area = 1453 sq ft / 134.9 sq m
For identification only - Not to scale

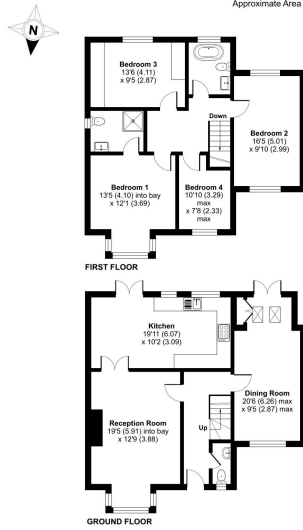

Plan also produced in accordance with BS2798: Measurement for Sale, incorporating International Property Measurement Standards (IPMS) Requirements. Produced for use in accordance with EPC 1001/100011. ©iStockroom 2023.

- Please Quote Ref: JJ1194
- Family Home Situated in a Sought After Village Location
- Waling Distance to Local Amenities
- Sitting Room with Open Fireplace
- Kitchen/Breakfast Room
- Dining Room
- 4 Bedrooms
- Principle Bedroom with En Suite Shower Room
- South Facing Garden
- Off Street Parking

