



Bream Gardens, London, E6 6HX

£2,300 Per Calendar Month





£2,300 Per Calendar Month

# Bream Gardens

London, E6 6HX

- Three Bedrooms
- Front and Rear Garden
- Close to public transport
- Separate Kitchen
- Available from 2nd March 2026

Situated in a prime residential area, this property boasts three well-proportioned bedrooms, good sized reception room with a private front and back garden.

An advantage of the property is the proximity to a number of Schools; Vicarage Primary School, Oliver Thomas Nursery School and Saint Michael's Catholic Primary School. Additionally, Kingsford Community School and Daffodil Tuition Center cater to older students, ensuring a comprehensive range of educational options.

Situated in a vibrant neighbourhood, residents will enjoy easy access to local amenities, including shops, parks, and excellent transport links, with the East Ham, Marlow Road bus stop and Beckton DLR Station are all in close proximity.



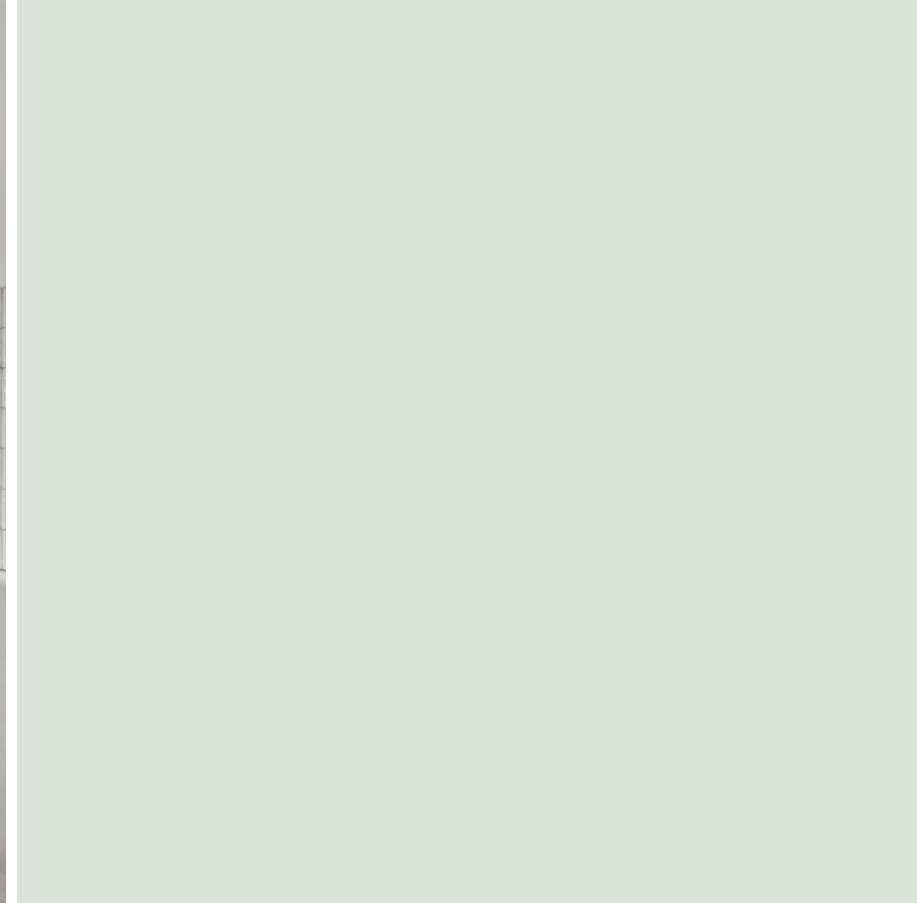

Directions





## Floor Plans

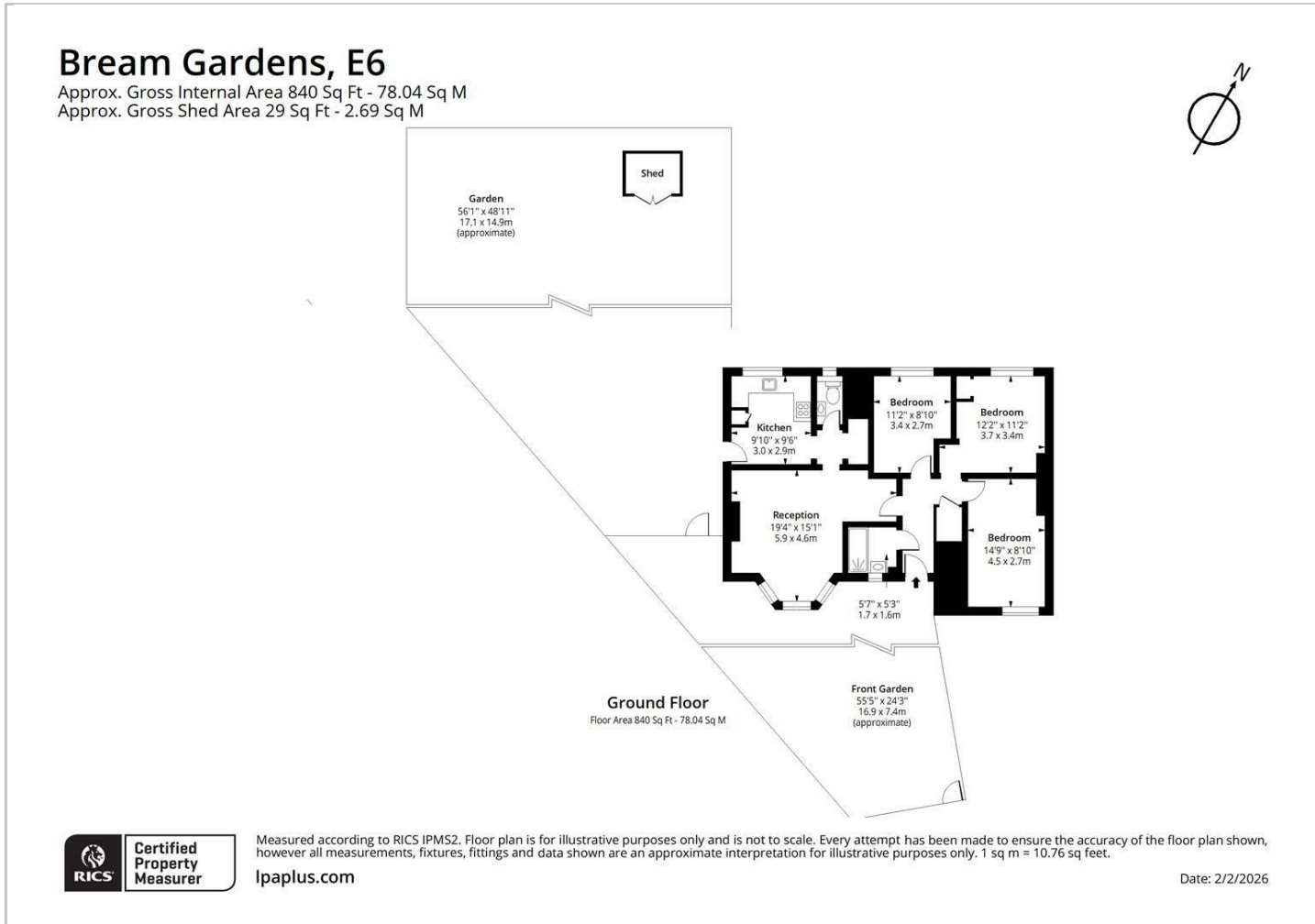

## Location Map

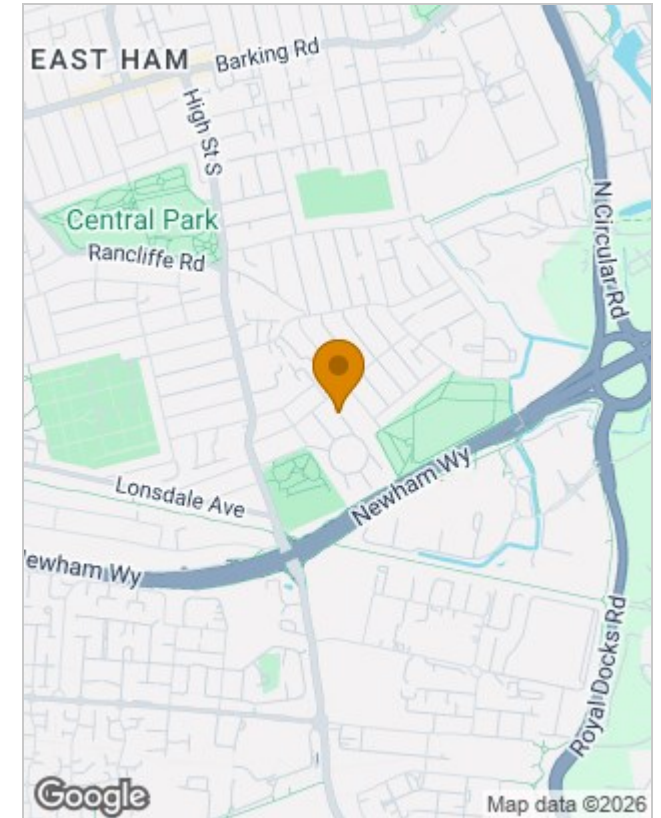

## Energy Performance Graph

Energy Efficiency Rating		Current	Potential
Very energy efficient - lower running costs			
(92 plus) <b>A</b>			
(81-91) <b>B</b>			
(69-80) <b>C</b>			
(55-68) <b>D</b>			
(39-54) <b>E</b>			
(21-38) <b>F</b>			
(1-20) <b>G</b>			
Not energy efficient - higher running costs			
<b>England &amp; Wales</b>	EU Directive 2002/91/EC		

## Viewing

Please contact our Redbridge Lettings Office on 020 8551 0211 if you wish to arrange a viewing appointment for this property or require further information.

The particulars are set out as a general outline only for the guidance of intended purchasers or lessees, and do not constitute, any part of a contract. Nothing in these particulars shall be deemed to be a statement that the property is in good structural condition or otherwise nor that any of the services, appliances, equipment or facilities are in good working order. Purchasers should satisfy themselves of this prior to purchasing.