

SNELLERS

ESTATE AGENTS



Anglesea Road, KT1

£2,295 PCM

A stylish and modern three double bedroom first-floor flat set in Kingston upon Thames, offering bright and well-proportioned living space throughout. Ideally located just moments from the river, this property combines contemporary living with easy access to local amenities, transport links, and scenic riverside walks.



A stylish and modern three double bedroom first-floor flat set in Kingston upon Thames, offering bright and well-proportioned living space throughout. Ideally located just moments from the river, this property combines contemporary living with easy access to local amenities, transport links, and scenic riverside walks.

Anglesea Road offers the best of both worlds, equidistant between Kingston and Surbiton town centres you'll never have to look far for shops, restaurants or excellent transport links (0.6 miles to Surbiton Station).

- Three Double Bedrooms • Large Reception • Separate Kitchen •
- Close to Kingston and Surbiton Stations • Moments From The River Thames • Garage •



SNELLERS

ESTATE AGENTS

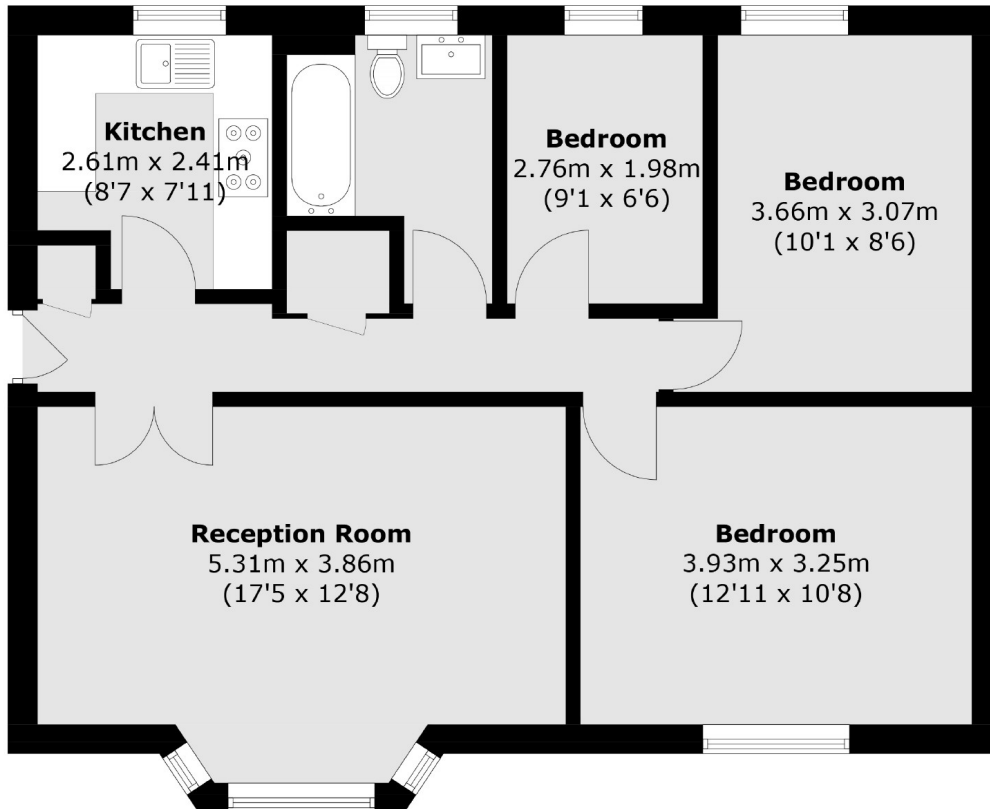

Total area (approx.): 68.7 sq. m (739.4 sq. ft)

Snellers Kingston Lettings
17-21 Richmond Road
Kingston
KT2 5BW
020 8546 0505
kingstonlettings@snellers.co.uk

Energy Rating: C We aim to make our particulars both accurate and reliable. However they are not guaranteed; nor do they form part of an offer or contract. If you require clarification on any points then please contact us, especially if you're traveling some distance to view. Please note that appliances and heating systems have not been tested and therefore no warranties can be given as to their good working order