



Cloutsham Street

The Mounts, Northampton

oriordanbond
SALES & LETTINGS



GROUND FLOOR
531 sq.ft. (49.3 sq.m.) approx.

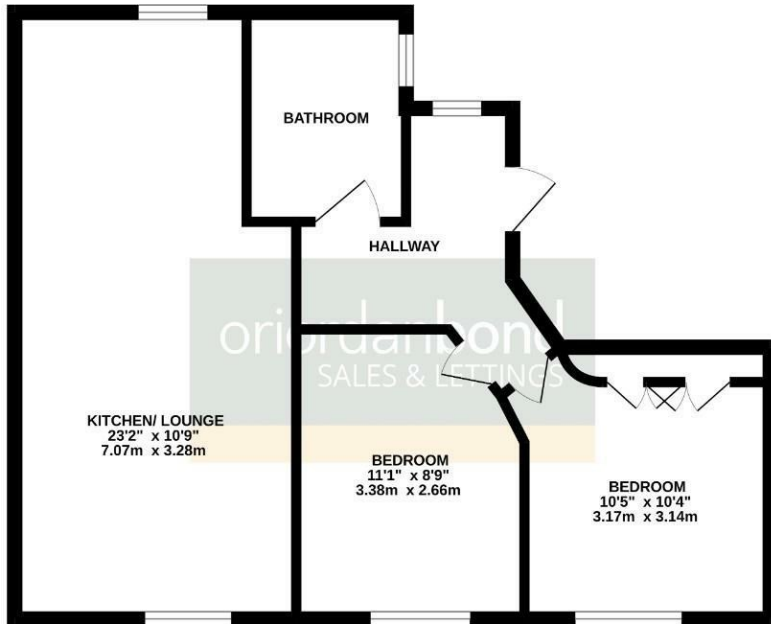

CLOUTSHAM STREET, NORTHAMPTON, NN1 3LN

TOTAL FLOOR AREA: 531 sq.ft. (49.3 sq.m.) approx.

While every attempt has been made to ensure the accuracy of the floorplan contained here, measurements of doors, windows, rooms and any other items are approximate and no responsibility is taken for any error, omission or mis-statement. This plan is for illustrative purposes only and should be used as such by any prospective purchaser. The services, systems and appliances shown have not been tested and no guarantee as to their operability or efficiency can be given.
Made with Metronix 6/20/26

Cloutsham Street

The Mounts

NN1 3LN

PRICE £170,000

O'Riordan Bond is delighted to offer for sale this impressive contemporary two double bedroom top floor apartment, with secure allocated parking, located close to the town centre. Presented in immaculate condition throughout, this apartment is offered for sale with no onward chain.

The accommodation comprises communal entrance hall with security intercom entry system, inner hall, open plan living/dining space incorporating a kitchen area with integrated appliances, two good size bedrooms and a modern bathroom suite. Benefits include uPVC double glazing and gas radiator heating. There is allocated parking in a gated car park. (A/531/-)

Leasehold Information: Lease Remaning - 105 years (as of 2026) / Ground Rent - £150 per annum / Service Charge - £108 per month (includes water rates and insurance)

Additional information

- Council Tax Band: B
- Energy Efficiency Rating: C

Viewing

Viewing strictly by appointment – details below

Disclaimer

O'Riordan Bond Estate Agents Limited has not tested apparatus, equipment, fittings or services and so cannot verify they are in working order. The buyer is advised to obtain verification from their solicitor or surveyor.

O'Riordan Bond Abington Sales

01604 639007

abington@oriordanbond.co.uk

