



Sylvester Road, E8

£775,000

This well-presented three-bedroom home offers generous living space and a modern layout throughout. The open-plan kitchen and reception room has floor-to-ceiling windows and doors opening onto a south-facing balcony overlooking a quiet, tree-lined road. The bedrooms come with plenty of storage, and there are two modern bathrooms. The property comes with a share of the freehold and measures over 900 sq. Ft and has lift access.

Perfectly placed in the heart of Hackney Central, the flat is moments from the independent cafés, shops and restaurants on Mare Street, with London Fields a short walk away. Hackney Central station is close by, providing quick links across London.

Features

- Three Bedrooms
- Two Bathrooms
- South Facing Balcony
- Share Of Freehold
- Open Plan
- Lift Access

Sylvester Road, London, E8

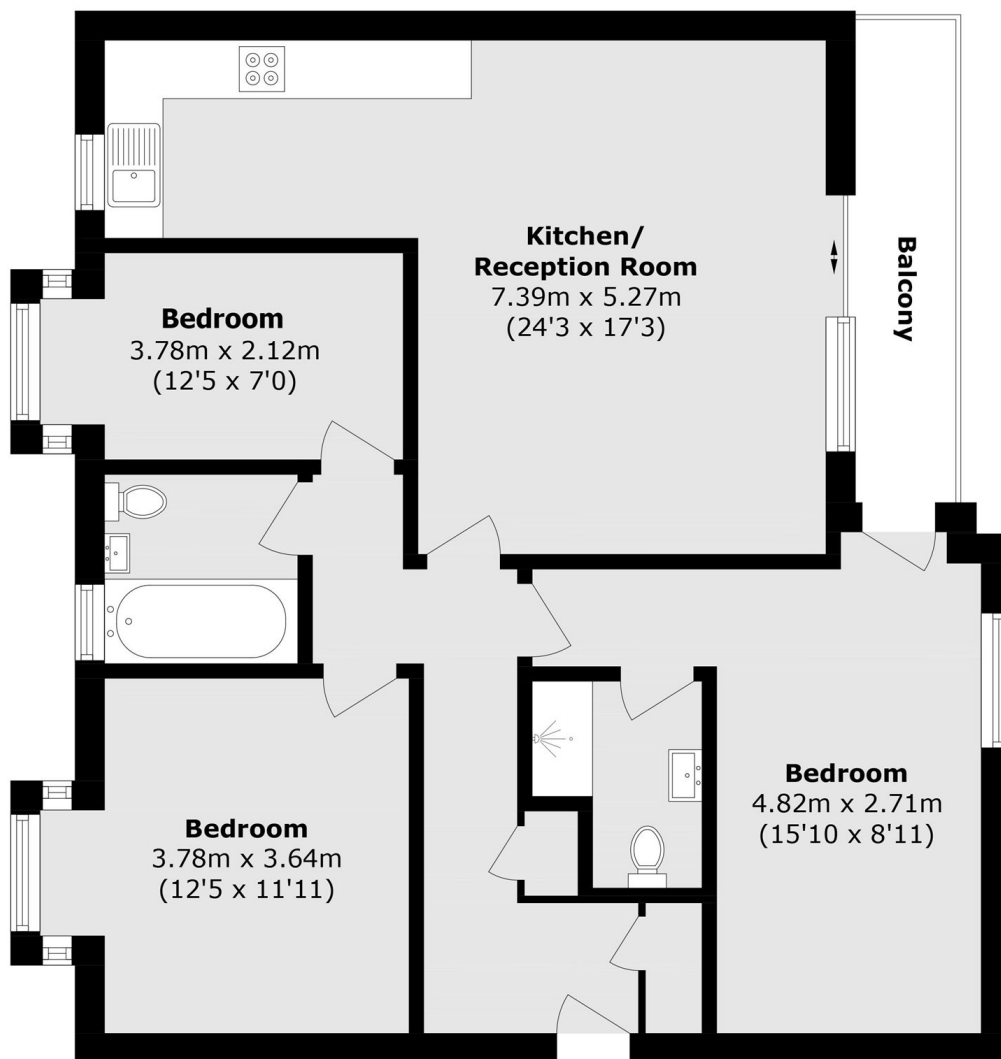

Second Floor

Total area (approx): 84.9 sq. m (913.8 sq. ft)

Balcony area (approx): 5.0 sq. m (53.82 sq. ft)