



Peter Clarke

IN ASSOCIATION WITH

Winkworth

3 Arden Mews, Station Road, Wilmcote, Stratford-upon-Avon, Warwickshire, CV37 9UG

- NO ONWARD CHAIN
- Two double bedrooms and two bathrooms (one en suite)
- Set back from the road
- Gardens to front and rear
- Garage and off road parking
- Popular village of Wilmcote, just north of Stratford upon Avon



£299,950

Rarely available, a two double bedroom modern mews home, located in the popular village of Wilmcote and having the unusual benefit of a GARAGE and allocated parking with gated access. Comprising entrance hall, kitchen, sitting/dining room, two double bedrooms, bathroom and a low maintenance rear garden. Stratford upon Avon is four miles and M40 junction 15 is nine miles. The railway station in Wilmcote is approximately five minutes walk. NO ONWARD CHAIN

ACCOMMODATION

Entrance porch. Entrance Hall. Kitchen with matching wall, base and drawer units with work surface over and incorporating sink and drainer unit, integrated oven with four ring hob and overhead extractor fan, space for appliances. Sitting/Dining Room having doors onto garden.

First floor landing with loft access and door to storage cupboard. Main Bedroom with En Suite comprising shower cubicle, wc and wash hand basin. Bedroom Two. Family Bathroom comprising bath with shower over, wc and wash hand basin.

Outside to the rear is a low maintenance garden with gated rear access to the garage, which is accessed via gates, and allocated parking space.

GENERAL INFORMATION

TENURE: The property is understood to be freehold. This should be checked by your solicitor before exchange of contracts.

SERVICES: We have been advised by the vendor that mains electricity, gas, water and drainage are connected to the property. However this should be checked by your solicitor before exchange of contracts. Gas central heating.

RIGHTS OF WAY: The property is sold subject to and with the benefit of any rights of way, easements, wayleaves, covenants or restrictions etc. as may exist over same whether mentioned herein or not.

COUNCIL TAX: Council Tax is levied by the Local Authority and is understood to lie in Band C.

CURRENT ENERGY PERFORMANCE CERTIFICATE RATING: C. A full copy of the EPC is available at the office if required.

VIEWING: By Prior Appointment with the selling agent.



3 Arden Mews, Station Road, Wilmcote CV37 9UG

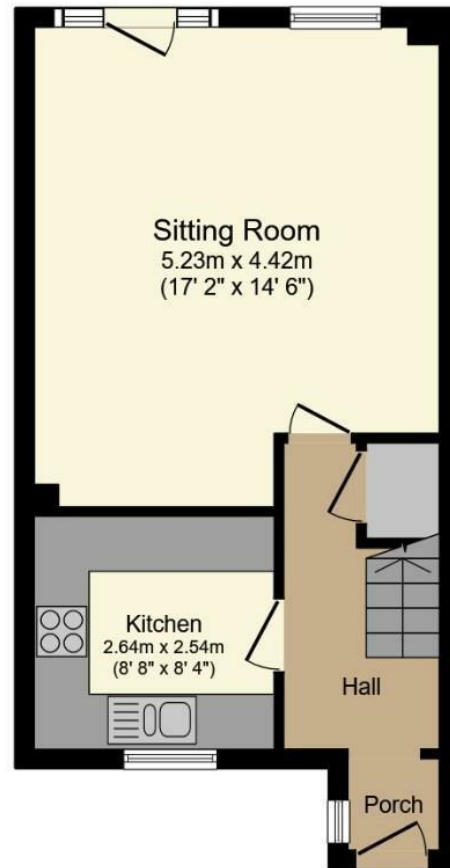

Ground Floor
Floor area 35.9 sq.m. (386 sq.ft.)

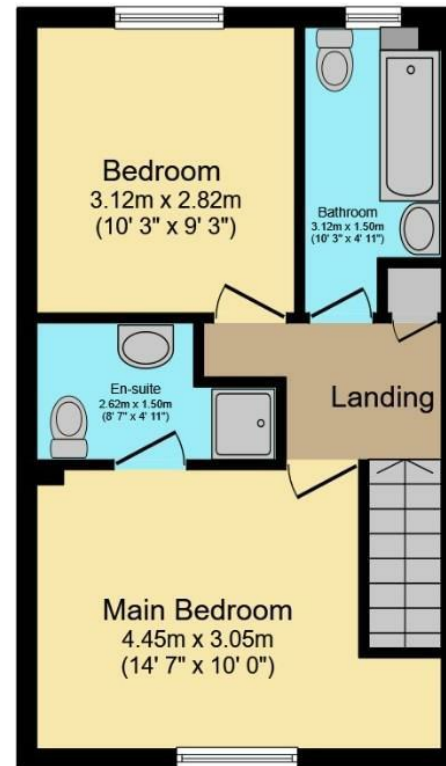

First Floor
Floor area 34.8 sq.m. (374 sq.ft.)

Total floor area: 70.7 sq.m. (761 sq.ft.)

This floor plan is for illustrative purposes only. It is not drawn to scale. Any measurements, floor areas (including any total floor area), openings and orientations are approximate. No details are guaranteed, they cannot be relied upon for any purpose and do not form any part of any agreement. No liability is taken for any error, omission or misstatement. A party must rely upon its own inspection(s). Powered by www.Propertybox.io

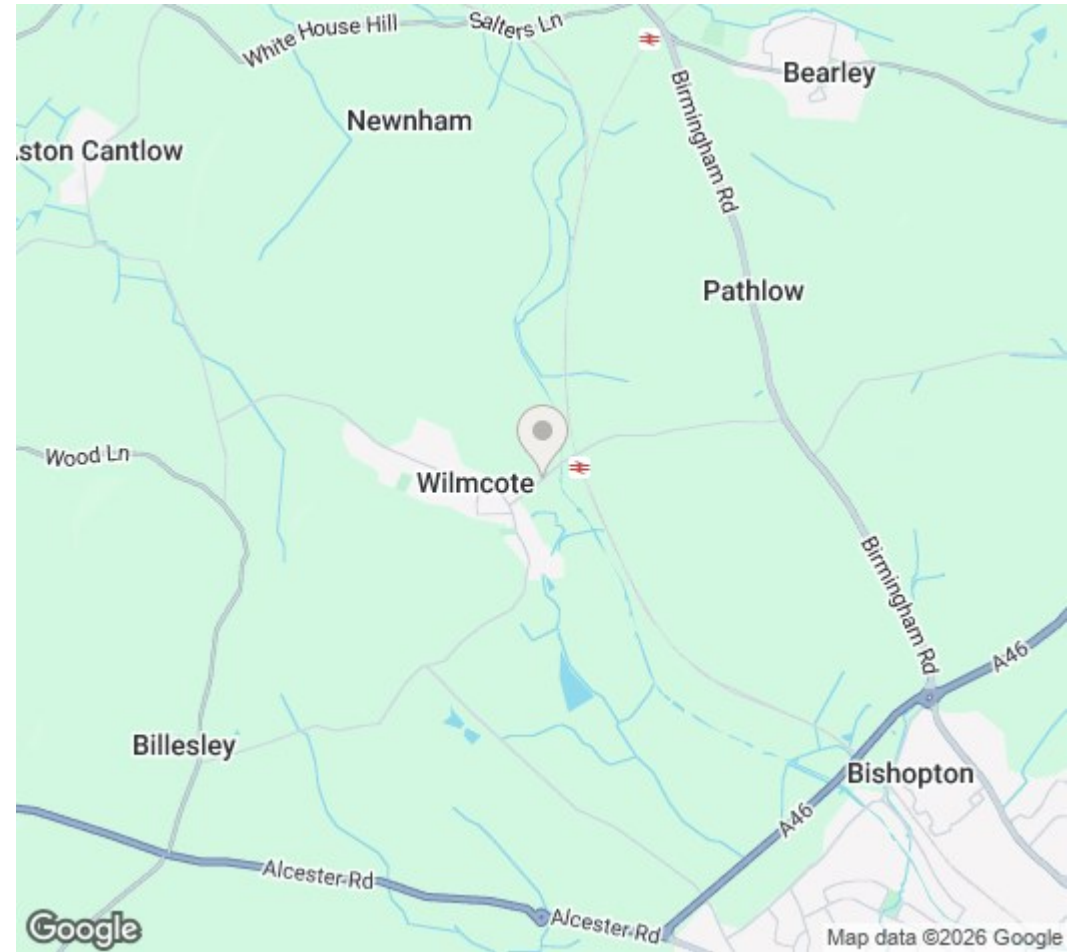

DISCLAIMER: HMR Homes Limited t/a Peter Clarke in association with Winkworth themselves and for the vendors or lessors of this property whose agents they are, give notice that the particulars are set out as a general outline only for the guidance of intending purchasers or lessors, and do not constitute part of an offer or contract; all descriptions, dimensions, references to condition and necessary permission for use and occupation, and other details are given without responsibility and any intending purchasers or tenants should not rely on them as statements or presentations of fact but must satisfy themselves by inspection or otherwise as to the correctness of each of them. Room sizes are given on a gross basis, excluding chimney breasts, pillars, cupboards, etc. and should not be relied upon for carpets and furnishings. We have not carried out a detailed survey and/or tested services, appliances and specific fittings. No person in the employment of HMR Homes Limited t/a Peter Clarke in association with Winkworth has any authority to make or give any representation of warranty whatever in relation to this property and it is suggested that prospective purchasers walk the land and boundaries of the property, prior to exchange of contracts, to satisfy themselves as to the exact area of land they are purchasing.

Multi-award winning offices
serving South Warwickshire & North Cotswolds

53 Henley Street, Stratford-upon-Avon, Warwickshire, CV37 6PT
01789 415444 | stratford@peterclarke.co.uk | www.peterclarke.co.uk



Peter Clarke

IN ASSOCIATION WITH Winkworth