



## Morland Close, CR4

£1,850 Per calendar month

This two bedroom house has been neutrally decorated throughout. The property benefits from two double bedrooms, a large living room and private garden making it perfect for a couple or family.

This property is a short distance away from Morden Hall Park, Mitcham Common & Mitcham Cricket Green as well as having easy access to the Tandem Centre.

### Features

- Terraced House
- Two Double Bedrooms
- Large Reception Room
- Separate Kitchen
- Private Garden
- Quiet Location

# Morland Close, Mitcham, CR4

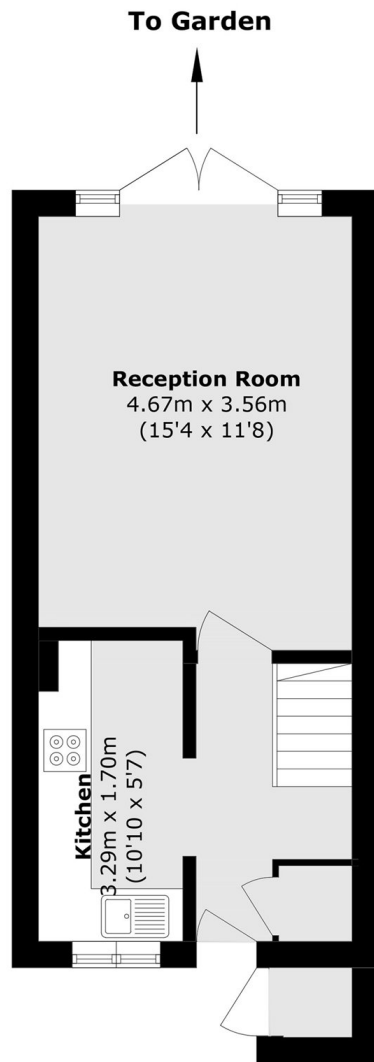

**Ground Floor**

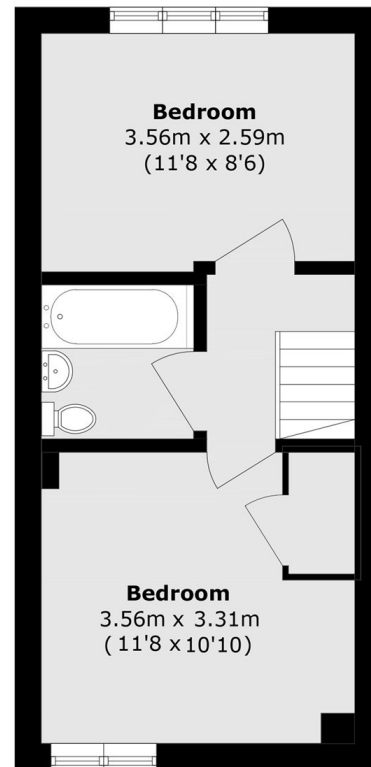

**First Floor**

Total area (approx.): 58.0 sq. m (624.3 sq. ft)  
External Storage area (approx.): 0.6 sq. m (6.4 sq. ft)