



Glendower Court offers in excess of £105,000

- COUNCIL TAX BAND C, EPC RATING B
- WELL POSITIONED TO LIFT AND STAIRCASE
- COMMUNAL LOUNGE, GUEST SUITE, LAUNDRY ROOM
- HOUSE MANAGER - CLAIRE
- OFF ROAD PARKING
- BUS ROUTE TO WHITCHURCH VILLAGE
- EPC Rating: B





About the property

The accommodation comprises a wide reception hall, lounge/ diner, fitted kitchen with appliances, bathroom with a good size bedroom with fitted wardrobes. There is a very pleasant aspect, double glazing and electric heating. Well kept communal gardens and parking bays. Communal lounge, resident house manager, alarm alerts in all rooms, laundry room and guest suite. Residents must be 55 years and over.



Accommodation

Entrance Hallway

Spacious hallway and suitable for wheel chair access. Doors leading access to all rooms. Carpeted throughout. Wall mounted heater. Security entry phone/alarm.

Lounge

11' 7" max x 14' 5" max (3.53m max x 4.39m max)
Double glazed UPVC window to rear. Feature fireplace housing an electric fire with marble hearth, television point, alarm, fitted carpet, double doors to kitchen. Wall mounted heater.

Kitchen

7' 3" max x 5' 8" max (2.21m max x 1.73m max)
Double glazed window, fitted wall and base units, inset stainless steel sink unit with drainer, space for under counter fridge and separate freezer, inset electric oven and hob, tiled splashbacks, wall mounted heater, cooker hood, alarm, vinyl flooring.

Bedroom

11' 4" max x 17' 7" max (3.45m max x 5.36m max)
Double glazed window, two fitted wardrobes, alarm, wall mounted electric heater, fitted carpet.

Bathroom

Low level WC, vanity unit with inset wash hand basin and storage, wall mounted electric heater, extractor fan, tiled walls, carpet.

02920 612328

whitchurch@peteralan.co.uk

Floorplan

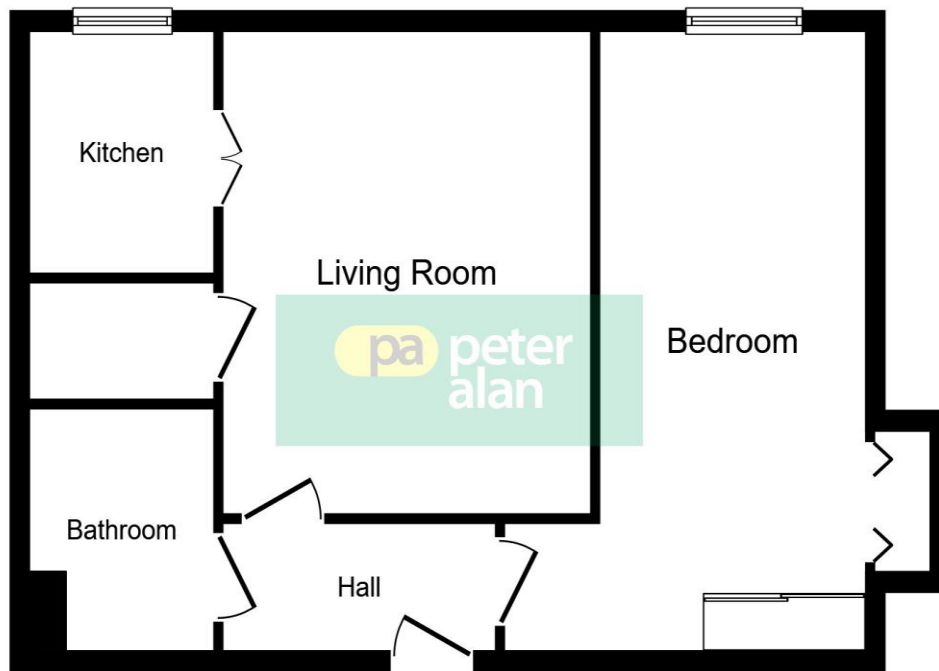

Floor Plan

This floor plan is for illustrative purposes only. It is not drawn to scale. Any measurements, floor areas (including any total floor area), openings and orientation are approximate. No details are guaranteed, they cannot be relied upon for any purpose and they do not form part of any agreement. No liability is taken for any error, omission or misstatement. A party must rely upon its own inspection(s). Plan produced for Peter Alan. Powered by www.focalagent.com



Important Information

Note while we endeavour to make our sales details accurate and reliable, if there is any point which is of particular interest to you, please contact the office and we will be pleased to confirm the position for you. We have not personally tested any apparatus, equipment, fixtures, fittings or services and cannot verify they are in working order or fit for their purposes. Nothing in these particulars is intended to indicate that carpets or curtains, furnishings or fittings, electrical goods (whether wired or not). Gas fires or light fittings or any other fixtures not expressly included form part of the property offered for sale. This computer generated Floorplan, if applicable, is intended as a general guide to the layout and design of the property. It is not to scale and should not be relied upon for dimensions. Tenure: We cannot confirm the tenure of the property as we have not had access to the legal documents. The buyer is advised to obtain verification from their solicitor or surveyor.

Peter Alan Limited is registered in England and Wales under company number 2073153, Registered Office is Cumbria House, 16-20 Hockliffe Street, Leighton Buzzard, Bedfordshire, LU7 1GN. VAT Registration Number is 500 2481 05. For activities relating to regulated mortgages and non-investment insurance contracts, Peter Alan Limited is an appointed representative of Connells Limited which is authorised and regulated by the Financial Conduct Authority. Connells Limited's Financial Services Register number is 302221. Most buy-to-let