



DOONERAK HOUSE | GLENFINNAN | PH37 4LT



PRICE GUIDE: £350,000

Occupying a superb elevated position and commanding breath-taking mountain and countryside views, Doonerak House is an attractive detached residence set within generous private garden grounds, offering ample off-road parking and an enviable setting in the heart of the Highlands. Peacefully nestled amidst spectacular scenery in the picturesque and historic village of Glenfinnan, this charming property enjoys an idyllic setting while providing spacious and versatile accommodation, thoughtfully arranged over two levels. Benefiting from mixed double glazing and electric heating throughout, the house is presented in very good order, making it ready for immediate occupation. The welcoming accommodation comprises an impressive triple-aspect entrance porch/sun room, perfectly positioned to capture the surrounding landscape and natural light, together with a comfortable lounge featuring an open fire, creating a warm and inviting focal point. Further ground floor accommodation includes a formal dining room, a well-appointed kitchen, utility room, two bedrooms and family bathroom. The upper floor offers two further well-proportioned bedrooms and an additional shower room, providing excellent flexibility for family living or guest accommodation. Owing to its generous proportions, outstanding location and versatility, Doonerak House would be ideally suited as a superb family residence with good internet connectivity, an idyllic Highland holiday retreat, or an attractive investment opportunity within the thriving and highly sought-after self-catering holiday rental market.

The historic Highland village of Glenfinnan lies approximately 16 miles west of Fort William, beautifully positioned at the head of Loch Shiel and surrounded by some of Scotland's most dramatic landscapes. Steeped in history, Glenfinnan is famed as the site where Jacobite Rising of 1745 began when Bonnie Prince Charlie raised his Standard in 1745. More recently, the village has gained worldwide recognition for the iconic Glenfinnan Viaduct, celebrated for its appearance in the Harry Potter films. Despite its tranquil setting, the village offers a range of local amenities including a church, hotel, restaurant facilities, railway station and the renowned Glenfinnan Monument visitor centre. The surrounding area is a haven for outdoor enthusiasts, with exceptional opportunities for walking, hiking, climbing, sailing, wildlife watching, and exploring the magnificent West Highland landscape.

- Attractive Detached Dwellinghouse
- Desirable Semi-Rural Village Location
- Beautiful Mountain & Countryside Views
- Lounge with Open Fire
- Kitchen & Utility Room
- Dining Room
- Entrance Porch/Sun Room
- 4 Double Bedrooms, Bathroom & Shower Room
- Mixed Double Glazing & Electric Heating
- Generous Garden with Private Driveway & Parking
- EPC Rating: D 56

MacPhee & Partners
 Airds House, An Aird, Fort William, PH33 6BL
 01397 702200
 estateagency@macphee.co.uk :: www.macphee.co.uk

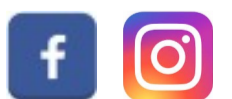

rightmove 
 find your happy



 PrimeLocation.com

Entrance Porch/Sun Room 3.6m x 2.3m

With glazed wooden entrance door and fixed panels to side. Picture windows to front views and side. Hatch to loft. Laminate flooring. Glazed door and side panel to hallway.

Hallway 5.1m x 2.9m

L-shaped, with vaulted ceiling and stairs to upper level. Built-in cupboard. Doors to lounge, kitchen, bathroom and bedrooms.

Lounge 5.5m x 4.0m

With picture window to view. Open fireplace with stone surround. Door to dining room.

Dining Room 3.5m x 2.9m

With window to rear. Open to kitchen.

Kitchen 3.4m x 3.4m

With window to rear. Fitted with beech effect kitchen units, offset with granite effect work surfaces. Belling oven. Indesit electric hob with extractor hood over. Indesit washing machine. Candy dishwasher. LG fridge/freezer. Stainless steel sink unit. Tiled splashback. Laminate flooring. Doors to utility room and hallway.

Utility Room 2.2m x 1.9m

With window to rear. Fitted with wood-trim kitchen units, offset with wood effect work surfaces. Plumbing for washing machine. Stainless steel sink unit. Wooden door to rear.

Bathroom 2.4m x 2.0m

Slightly L-shaped, with frosted window to rear. Fitted with pale green coloured suite of WC, wash hand basin, and bath with Mira shower over. Tiled splashback. Heated towel rail.

Bedroom 3.5m x 3.4m

With window to rear. Built-in double wardrobe.

Bedroom 4.5m x 4.0m

Slightly L-shaped, with window to front. Built-in double wardrobe.

Upper Level

Landing

With hatch to loft. Doors to bedrooms and shower room.

Bedroom 4.8m x 4.3m

With Dormer window to front views and Velux window to rear. Built-in wardrobe.

Shower Room 2.5m x 1.6m

With Velux window to rear. Fitted with ivory coloured suite of WC, wash hand basin, and fully tiled shower cubicle with Mira shower. Tiled splashback. Heated towel rail.

Bedroom 4.5m x 4.3m

Slightly L-shaped, with Dormer window to front views and Velux window to rear. Built-in wardrobe.

Garden

The property is accessed by a private gravelled driveway, leading to an ample parking area. The grounds are laid to a mixture of lawn, gravelled and paved patio areas, well-stocked with mature trees, shrubs, bushes and seasonal planting, providing an interesting and charming space, with the West Coast Fort William to Mallaig railway line located up to the rear.

Travel Directions

Travelling from Fort William on the A830 'Road to the Isles' to Mallaig for approximately 16 miles. On entering the village, pass the monument and continue up the hill past the church. After the turning for the railway station, take the first on the right. Doonerak House is the middle of the three properties.

 [passport.bordering.shrubbery](https://www.what3words.com/passport.bordering.shrubbery)



Title Plan

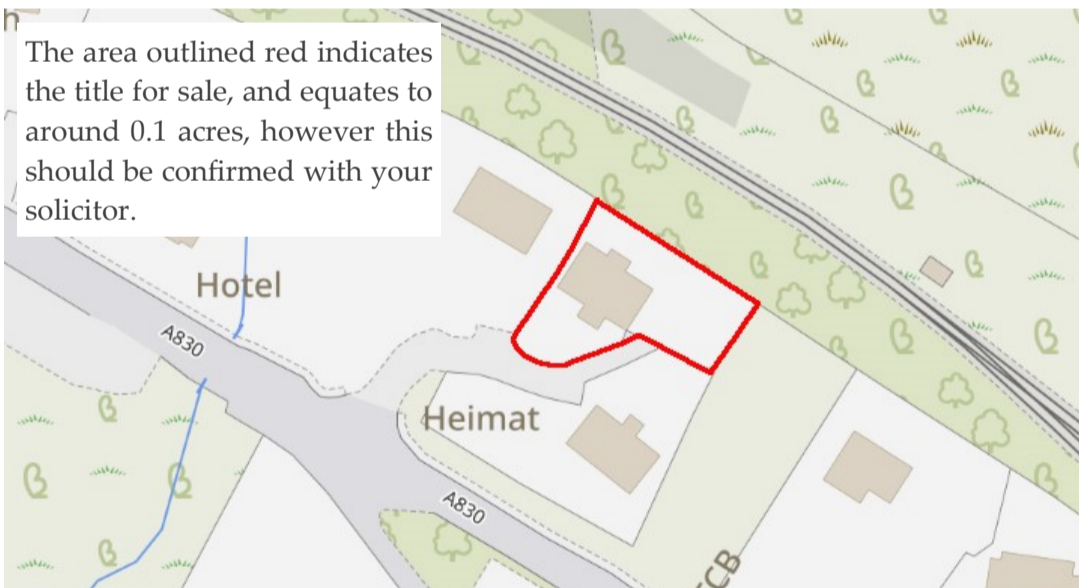

The area outlined red indicates the title for sale, and equates to around 0.1 acres, however this should be confirmed with your solicitor.

Floor Plan

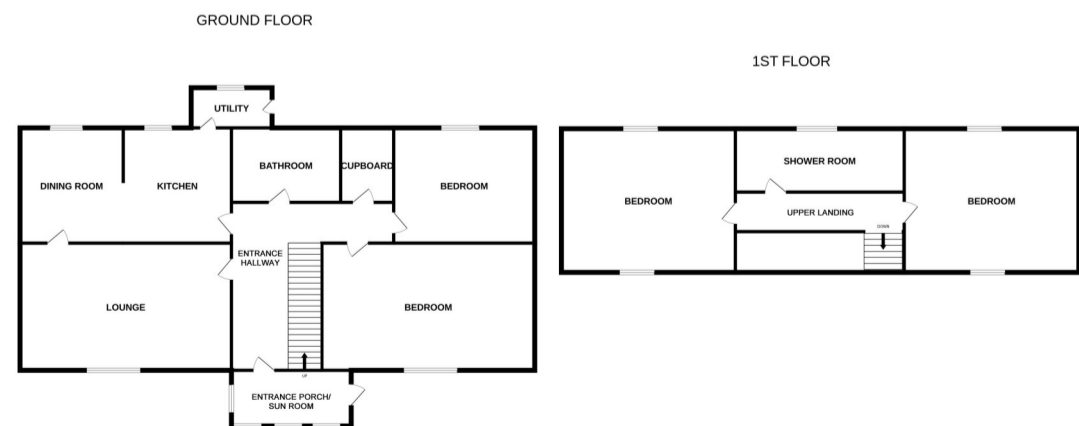

These particulars were prepared on the basis of our knowledge of the local area and, in respect of the property itself, information supplied to us by our clients. All reasonable steps were taken at the time of preparing these particulars to ensure that all details are accurate. All statements contained in the particulars are for information only and all parties should not rely on them as representations of fact; in particular:- (a) descriptions, measurements and dimensions are approximate only; (b) all measurements are taken at the widest points; and (c) all references to condition, planning permission, services, usage, construction, fixtures and fittings and moveable items contained in the property are for guidance only. Our clients may instruct us to set a closing date for offers and therefore if you wish to pursue interest in this property you should immediately instruct your solicitor to note interest with us. Our clients reserve the right to conclude a bargain for the sale of the subjects ahead of a closing date and will not be obliged to accept either the highest or indeed any offer for the subjects or any part thereof. All measurements are taken using a sonic tape measure and therefore may be subject to a small margin of error. None of the services or appliances have been checked by us and no warranty is given as to their condition. All arrangements to view must be made by prior appointment with MacPhee and Partners. It is the responsibility of all prospective viewers to check with the agents prior to viewing the property to ensure that it is still available for sale, particularly with regard to long journeys or those viewings arranged some time in advance. Offers are invited in the style of the Scottish Standard Offer and incorporating the Scottish Standard Clauses (Edition 6).