



**First Floor Flat, 1 Woodlands Street**  
Millport, KA28 0DX

**Offers over £62,000**



## First Floor Flat, 1 Woodlands Millport, KA28 0DX

Flat 1R, 1 Woodlands Street, Millport  
KA28 0DX

Reduced Price: Offers over £62,000

Seafront first floor flat within traditional property on Kames Bay beachfront offering super views across Kames Bay, Marine Parade and a short distance to Millport Town Centre and amenities. The neatly presented flat offers a bright kitchen and dining space, shower room, a spacious bedroom/living area with superb Kames Bay views. Competitively priced and excellently located, this property provides an ideal holiday hideaway and is sure to appeal with viewing is highly recommended. Council Tax: Band A EE Rating: D

The seaside town of Millport is just a 10-minute ferry journey from Largs and offers a variety of local services including Primary School, Health Centre, Cottage Hospital, Library, golf course, bowling green. Glasgow is around an hour away and there are regular public transport connections available from Largs to Glasgow, Ayr, Paisley and the West of Scotland.

### Kitchen

14'9" x 12'7" (4.50m x 3.84m)

### Bedroom/living room

11'4" x 10'8" (3.45m x 3.25m)

### Shower room

8'3" x 3'5" (2.51m x 1.04m)

### Gardens & Outbuildings

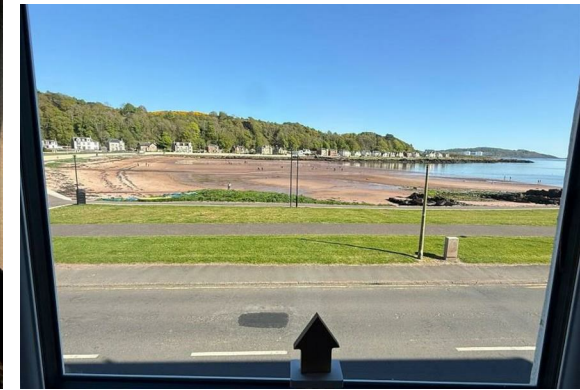

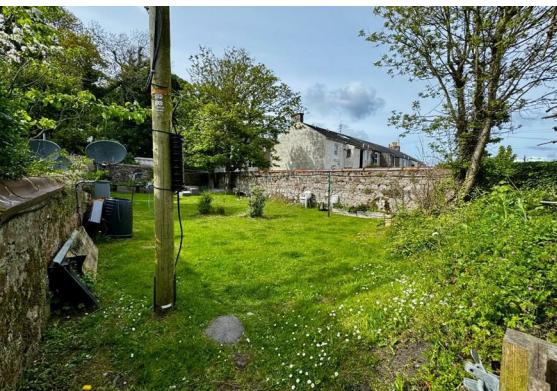

## Floor Plan

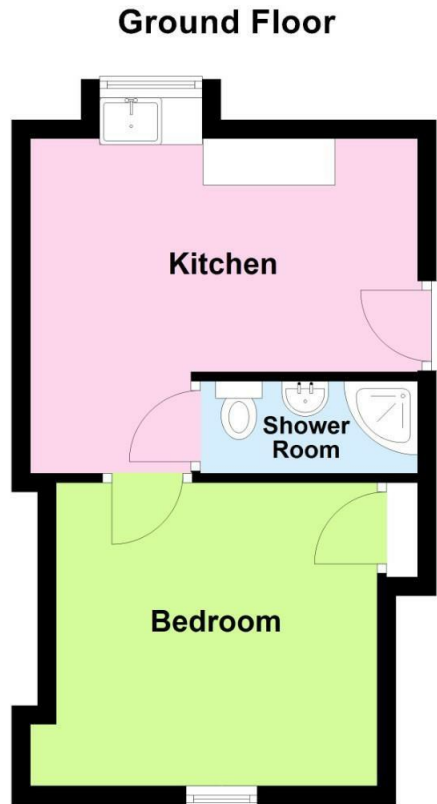

## Area Map



## Energy Efficiency Graph

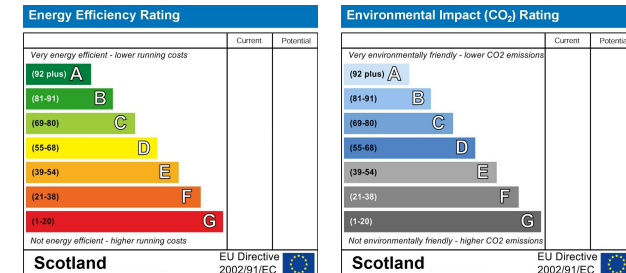

## Viewing

Please contact our Largs Office Office on 01475673663 if you wish to arrange a viewing appointment for this property or require further information.

These particulars, whilst believed to be accurate are set out as a general outline only for guidance and do not constitute any part of an offer or contract. Intending purchasers should not rely on them as statements of representation of fact, but must satisfy themselves by inspection or otherwise as to their accuracy. No person in this firm's employment has the authority to make or give any representation or warranty in respect of the property.