



*jordan fishwick*

High Hill Road New Mills High Peak



## High Hill Road New Mills High Peak SK22 4HQ

£297,000



### The Property

A well presented end terrace property in a popular location. Extended family home with four bedrooms, two reception rooms and ground floor wc - perfect for a growing family. Lovely rear garden with artificial lawn and decked seating area whilst to the front there is driveway parking and a garden. In brief the property comprises; living room with bay window, large dining kitchen, family room to rear with access into the garden, ground floor wc, to the first floor there are three double bedrooms, one single bedroom and a family bathroom with modern white suite and separate walk in shower cubicle.



- Garden Fronted End Terrace Property
- Immaculately Presented Throughout and Conveniently Located
- Four Good Sized Bedrooms, Three Double
- Large Dining Kitchen with Breakfast Bar
- Living Room with Bay Window and Family Room with Patio Doors Leading into the Garden
- Ground Floor WC
- Modern Family Bathroom with Separate Walk in Shower
- Driveway Parking and Lovely Private Rear Garden with Seating Area

**Postcode** SK22 4HQ

**EPC Rating** C

**Local Authority** High Peak

**Council Tax** B

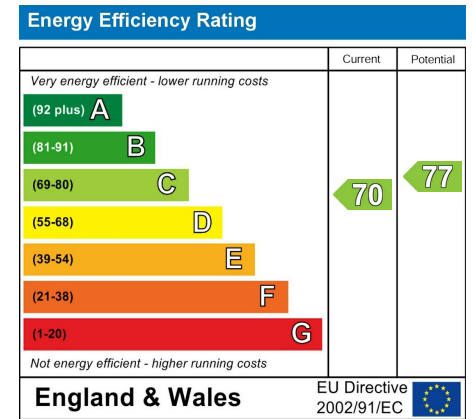

GROUND FLOOR



1ST FLOOR

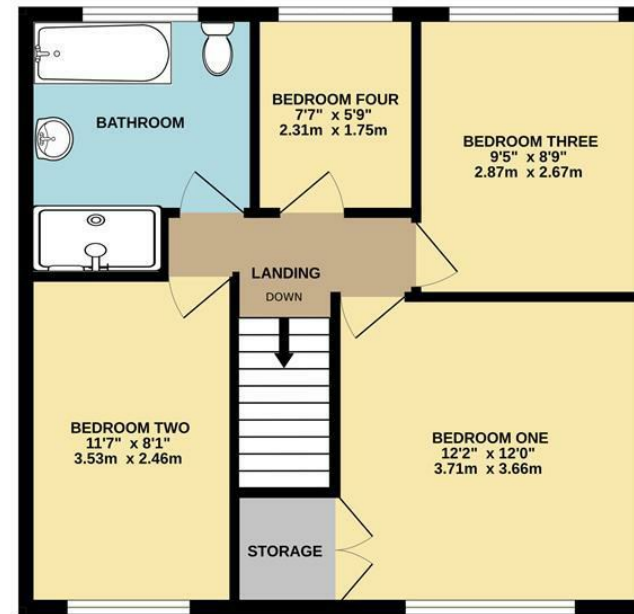

Whilst every attempt has been made to ensure the accuracy of the floorplan contained here, measurements of doors, windows, rooms and any other items are approximate and no responsibility is taken for any error, omission or mis-statement. This plan is for illustrative purposes only and should be used as such by any prospective purchaser. The services, systems and appliances shown have not been tested and no guarantee as to their operability or efficiency can be given.  
 Made with Metropix ©2026



These particulars are believed to be accurate but they are not guaranteed and do not form a contract. Neither Jordan Fishwick nor the vendor or lessor accept any responsibility in respect of these particulars, which are not intended to be statements or representations of fact and any intending purchaser or lessee must satisfy himself by inspection or otherwise as to the correctness of each of the statements contained in these particulars. Any floorplans on this brochure are for illustrative purposes only and are not necessarily to scale.

Offices at: Chorlton, Didsbury, Disley, Hale, Glossop, Macclesfield, Manchester Deansgate, Manchester Whitworth Street, New Mills, Sale, Wilmslow and Withington

14 Market St, Disley, Cheshire, Stockport SK12 2AA

01663 767878

disley@jordanfishwick.co.uk

www.jordanfishwick.co.uk