

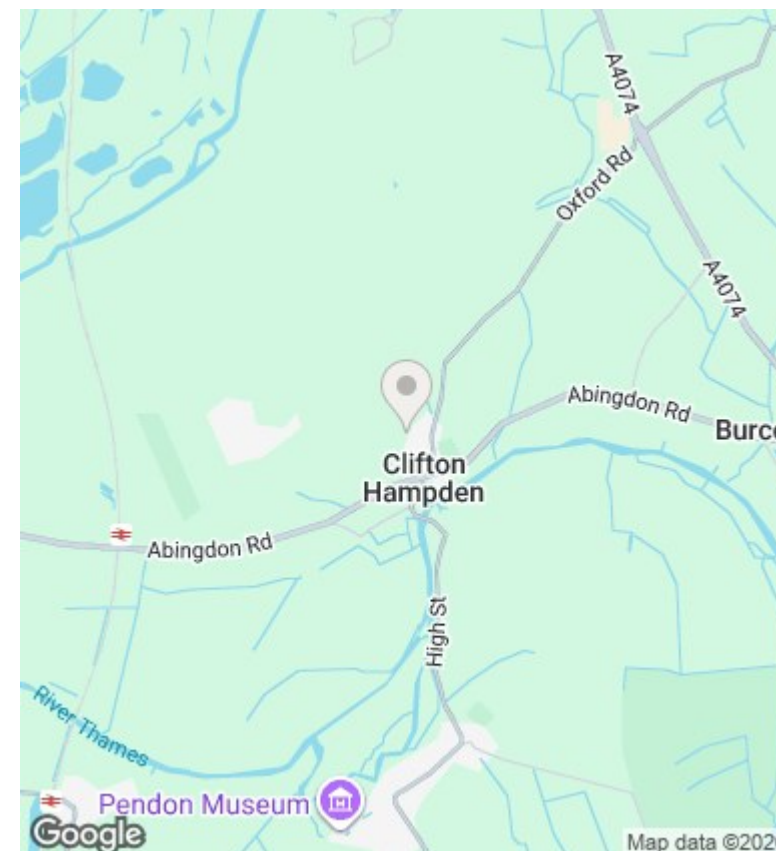

6 Courtiers Green, Clifton Hampden, Oxon, OX14 3EN

£1,795 PCM - 13th February 2026.

- Approx 1652 sq ft accommodation
- Lovely village environment
- Prime South Oxfordshire location
- Ample Parking
- Kitchen & Separate utility
- EPC Rating: D
- Double Glazing
- Three double bedrooms, en-suite
- Council tax band: E
- Gas Central Heating

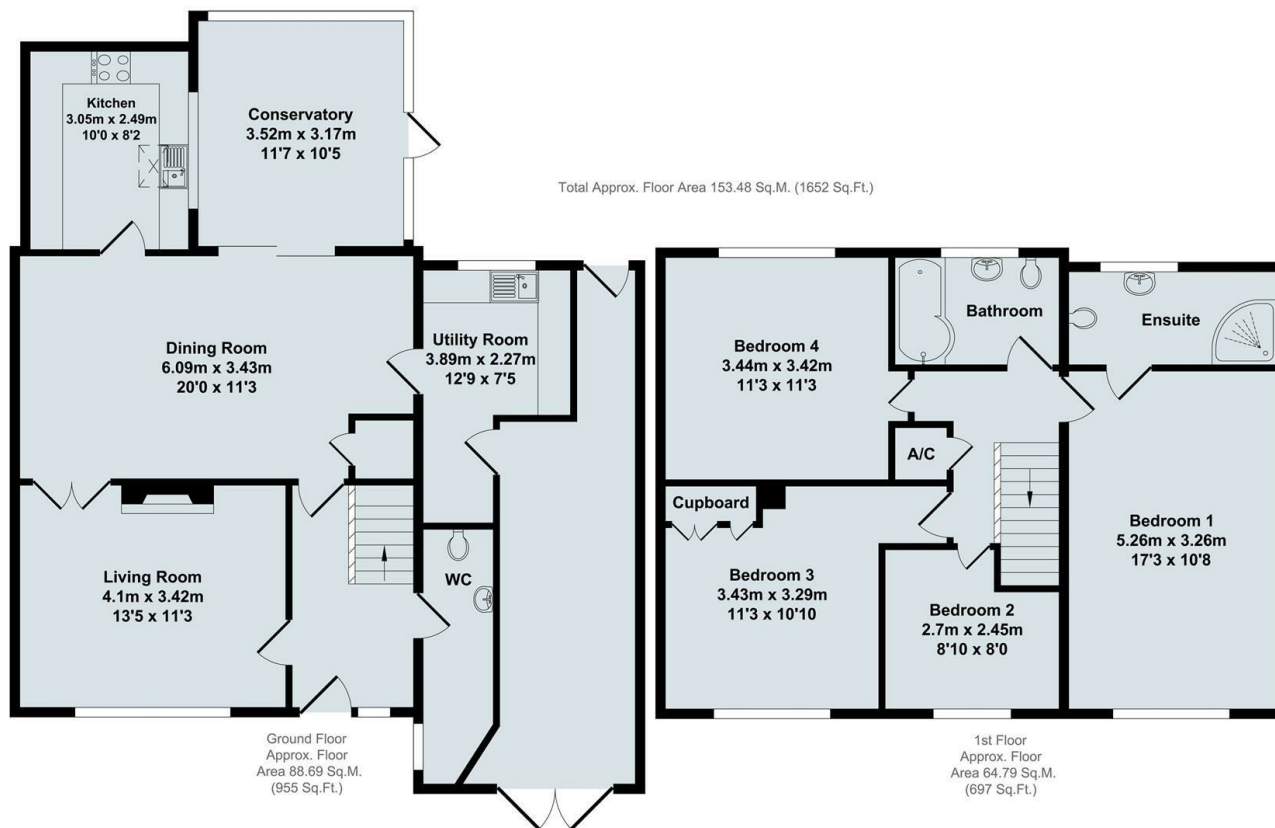

Directions

Viewings

Viewings by arrangement only. Call 01235 554950 to make an appointment.

Council Tax Band

EPC Rating:

D

Energy Efficiency Rating		
	Current	Potential
Very energy efficient - lower running costs		
(92-plus) A		
(81-91) B		
(69-80) C		
(55-68) D	68	
(39-54) E		
(21-38) F		
(1-20) G		
Not energy efficient - higher running costs		
England & Wales		EU Directive 2002/91/EC