



Sutherland Avenue

London, W9

£3,250 per month
(£750 per week)

A lovely two double bedroom apartment within this impressive period building. The property comprises; large open plan reception, two double bedroom and modern bathroom. EPC D.



Sutherland Avenue

London, W9

- Two bedroom
- Open plan reception
- High ceilings
- Wooden floors
- EPC D
- 635 SQFT



A lovely two double bedroom apartment within this impressive period building. The property comprises; large open plan reception, two double bedrooms and modern bathroom.

Sutherland Avenue is conveniently situated moments from all the amenities of Little Venice and close to excellent transport links including both Maida Vale and Warwick Avenue underground stations.

For further material information please call the office.

Minimum Term: 12 months
Deposit Required: 5 weeks
Local Authority: City of Westminster
Council Tax Band: D
EPC Rating: C
Furnished, Part Furnished

Energy Efficiency Rating		Current	Potential
Very energy efficient - lower running costs			
(92-100)	A		
(81-91)	B		
(69-80)	C	72	81
(55-68)	D		
(39-54)	E		
(21-38)	F		
(1-20)	G		
Not energy efficient - higher running costs			
England, Scotland & Wales		EU Directive 2002/91/EC	

Chestertons Little Venice Lettings

26 Clifton Road
 Maida Vale
 London
 W9 1SX
 littlevenicelettingsusers@chestertons.co.uk
 02072662369
 chestertons.co.uk

Additional tenant charges apply (fees apply to non-AST tenancies only)
 Tenancy Agreement Fee: £300
 References per Tenant/Guarantor: £60
 Inventory check (approx. £100 – £250 inc. VAT)
 chestertons.co.uk/property-to-rent/applicable-fees

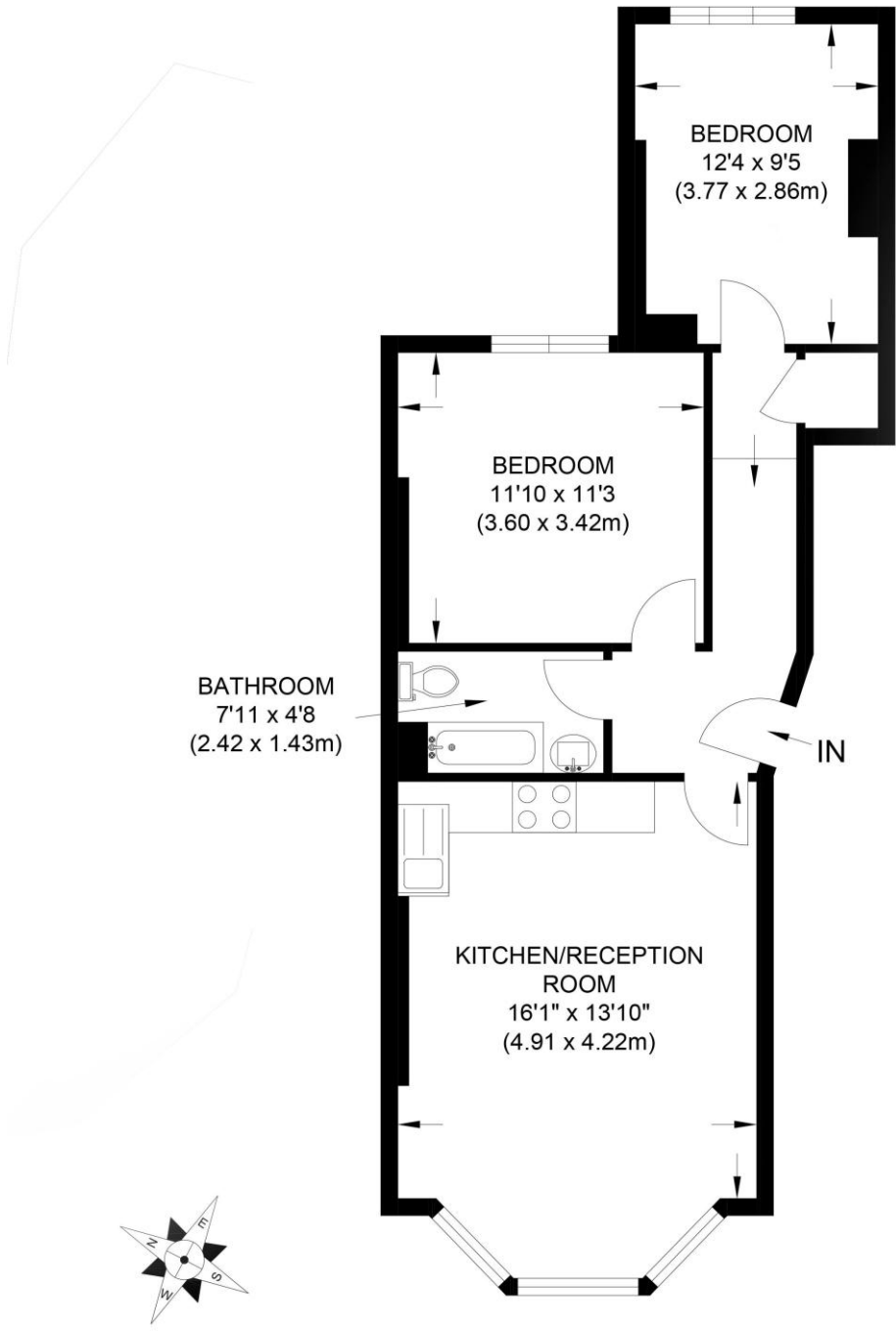

RAISED GROUND FLOOR

APPROX. GROSS INTERNAL FLOOR AREA 635 SQ FT/ 69 SQ M

Illustration for identification purpose only, not to scale
 All measurements are maximum, and includes wardrobes and window bays where applicable
 Prepared by Pixangle ©. Tel 020 8870 2118

Chesterton UK Services Limited trading as Chestertons for themselves and for the vendor of this property whose agents they are, give notice that (i) these particulars do not constitute any part of an offer or contract, (ii) all statements contained within these particulars are made without responsibility on the part of Chestertons or the vendor, (iii) whilst made in good faith, none of the statements contained within these particulars are to be relied upon as a statement or representation of fact, (iv) any intending purchasers must satisfy themselves by inspection or otherwise as to the correctness of each of the statements contained within these particulars, (v) the vendor does not make or give either Chestertons or any person in their employment any authority to make or give representation or warranty whatsoever in relation to this property. Wide angle lenses may be used. ©Copyright Chestertons | Chesterton Global Ltd | Registered Office 5th Floor, The Lantern, 75 Hampstead Road, London, NW1 2PL Registered Company Number 05334580.

