

Butler's

thoughtful estate agency



Seaforth Avenue
New Malden, KT3 6JT
Guide price £675,000

3 1 1 D

Seaforth Avenue

New Malden, KT3 6JT

Nestled in one of New Malden's most convenient roads, this handsome semi-detached period home has so much to offer, both inside and out. Firstly, we have to talk location.

Seaforth Avenue will surpass your expectations, as it's just a short stroll to the high street, with fantastic schooling close by. Not to mention Motspur Park's mainline station providing swift links into the City — making it 'sofa to London' in under an hour.

Despite all of this, sitting in your mature rear garden, you'd be forgiven for thinking you were on holiday — a tranquil space perfect for relaxing with a book, soaking up the sun, or entertaining friends and family.

Inside, the home has been well maintained over the years and retains a wealth of period charm and character, while also offering a wonderful opportunity for a new owner to come in and truly put their own stamp on it. The first floor provides two double bedrooms and a single bedroom, alongside a well-balanced family bathroom. It's also worth noting the loft is boarded and plastered, with clear potential for conversion (STPP). Work from home? You're well covered here. The ground floor layout offers a generous amount of space, including a large living/dining/multipurpose room — ideal for incorporating a home office, play area, or additional seating space.

If entertaining is more your style, the kitchen/breakfast room provides a well thought out and functional space to really make your mark and create something special, perfect for cooking up a storm and hosting loved ones!

GROUND FLOOR

Hallway





Living/Dining Room
25'6 x 11'8 (7.77m x 3.56m)

Kitchen/Breakfast Room
17'10 x 9'0 (5.44m x 2.74m)

FIRST FLOOR

Bedroom
15'5 x 11'7 (4.70m x 3.53m)

Bedroom
10'10 x 9'10 (3.30m x 3.00m)

Bedroom
9'3 x 9'00 (2.82m x 2.74m)

Bathroom
6'2 x 5'11 (1.88m x 1.80m)

OUTSIDE

Rear Garden



Floor Plan

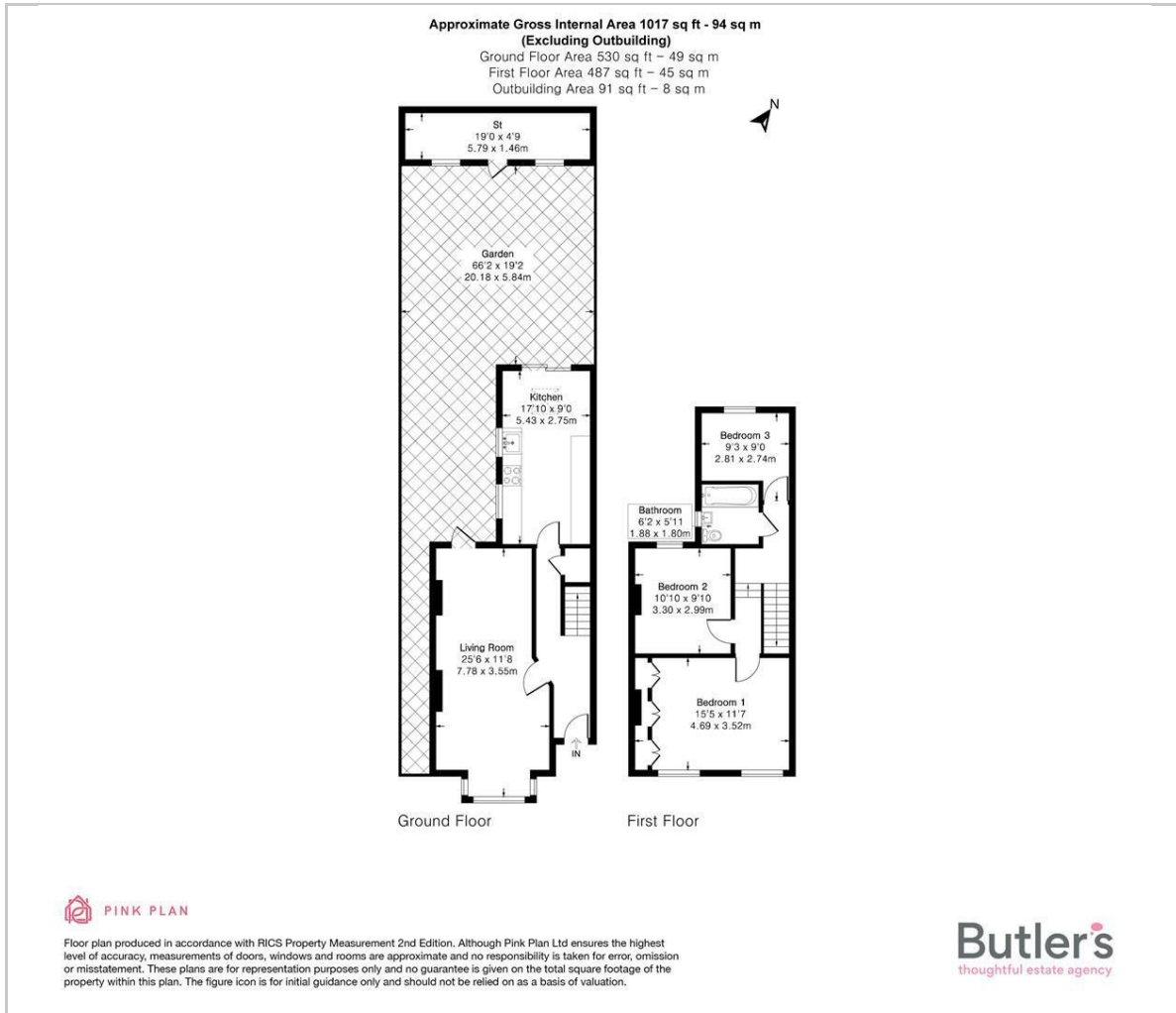

Viewing

Please contact our Butler's Worcester Park Office on 020 39 069 169 if you wish to arrange a viewing appointment for this property or require further information.

These particulars, whilst believed to be accurate are set out as a general outline only for guidance and do not constitute any part of an offer or contract. Intending purchasers should not rely on them as statements of representation of fact, but must satisfy themselves by inspection or otherwise as to their accuracy. No person in this firm's employment has the authority to make or give any representation or warranty in respect of the property.

64 Central Road, Worcester Park, KT4 8HY
Tel: 020 39 069 169 Email: worcesterpark@butlershomes.co.uk butlershomes.co.uk

Area Map

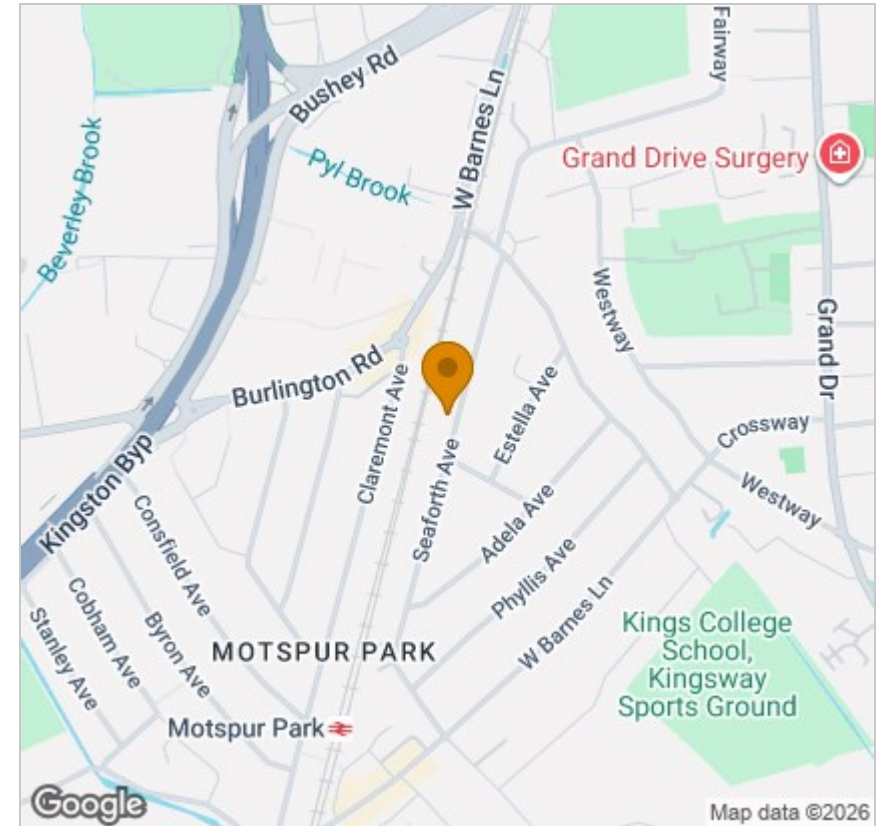

Energy Efficiency Graph

