



37

Templeton Way, Helensburgh. G84 8FA





37

Templeton Way, Helensburgh. G84 8FA



Completed around six years ago by Persimmon Homes, 37 Templeton Way is an utterly gorgeous two-bedroom mid-terrace villa located on the west side of Helensburgh within the sought-after Duchess Gait development.

Positioned at the top of the development, 37 Templeton Way has been owned since new by the current owner who has upgraded and maintained the property to a beautiful standard. On entering there is a lovely sized lounge which has a useful understairs cupboard. A door from the lounge leads to a stunning kitchen fitted with modern gloss units and worktops with a range of integral appliances. Adjoining the kitchen is a handy WC which is also home to the boiler and there is a courtesy door accessing the private south facing garden.

Upstairs the property has two well proportioned bedrooms both of which have built-in wardrobes and feature panelling. The main bedroom also has an additional store cupboard. Completing the upper level is a contemporary bathroom with modern suite and tiling. The property has high performance double glazing, gas central heating and solar panel technology.

Externally the property enjoys a lovely south facing rear garden which has a fabulous decking area and artificial grass for ease of maintenance. To the front, directly outside the property there are two allocated parking spaces.

EPC Band B
Council Tax Band D



37
Templeton Way, Helensburgh. G84 8FA





Measurements

Lounge	13' 06" Max x 13' 01" Max or 4.11m Max x 3.99m Max
Kitchen	9' 06" x 9' 03" or 2.90m x 2.82m
WC	9' 08" x 3' 05" or 2.95m x 1.04m
Landing	7' 01" x 6' 05" or 2.16m x 1.96m
Bedroom 1	10' 01" x 8' 05" or 3.07m x 2.57m
Bedroom 2	11' 05" x 7' 04" or 3.48m x 2.24m
Bathroom	6' 04" x 6' 02" or 1.93m x 1.88m

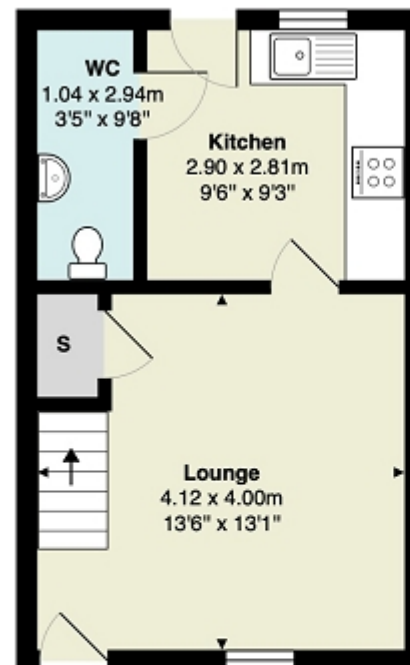

Ground Floor

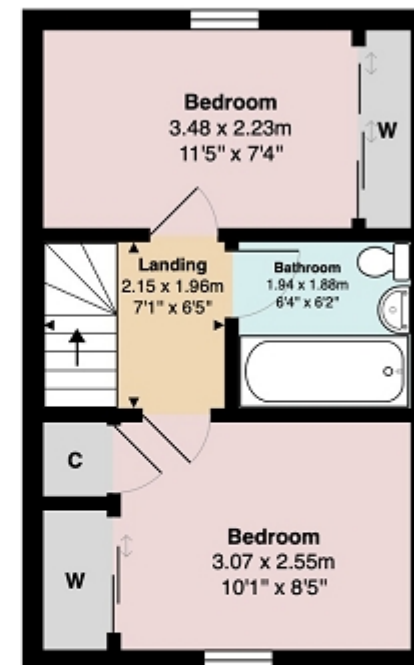

First Floor

All measurements are approximate and for display purposes only

Contact our office for further details



rightmove
find your happy

NOTE: These details have been prepared for guidance. If there is any point which you find misleading please contact McArthur Stanton where further information is available. Measurements have been taken from wall to wall, unless otherwise stated, and have been recorded by use of a sonic beam. Services and appliances not tested. Details have been prepared by August 2025. If required, we can arrange for a property market appraisal to be carried out on your existing property.

37

Templeton Way, Helensburgh. G84 8FA



**McArthur
Stanton**
Letting & Estate Agents