



HOMES BY VICTORIA
ESTATE AGENCY

Chandlers Close, Redditch, B97 5HU

Offers Over £495,000

🛏 4 🚿 3 🚗 2



Welcome to this impressive four/five bedroom detached family home, ideally located in the sought-after Chandler's Close, Redditch. Perfect for growing families, the property is conveniently positioned close to local amenities and well-regarded schools.

The home is approached via a tarmac and pebble driveway providing ample off-road parking, with a small lawned area to the front. A porch entrance offers an ideal boot room before leading into a welcoming entrance hall with stairs rising to the upper floors, useful understairs storage, and doors opening into the principal ground-floor accommodation.

The family lounge is a warm and inviting space, a double-glazed bay window to the front, and sliding doors that open into the conservatory, creating a seamless connection between indoor and outdoor living.

The kitchen diner is a standout feature of the home and truly forms its heart. This expansive, dual-aspect room is fitted with a comprehensive range of wall and base units and benefits from integrated appliances including a microwave oven, electric hob with overhead extractor, wine cooler, fridge freezer, and dishwasher—making it ideal for everyday family life and entertaining.

Leading from the kitchen is a large utility room with additional base units, a tall larder, and space for further appliances. This, in turn, provides access to the half-converted garage, which offers excellent versatility. Featuring two attractive arched double-glazed windows to the front, a vertical radiator, and double-glazed doors opening onto the garden, this space is served by its own modern shower room with WC. Serving perfectly as a guest accommodation, home office or bedroom for a growing child, or could easily be made into a self-contained annex.

Upstairs, the master bedroom is of a generous size and enjoys dual-aspect double-glazed windows allowing plenty of natural light. The room benefits from built-in wardrobes, spotlights to the ceiling, and a sliding door leading to its own private en-suite shower room, creating a comfortable and stylish retreat. The remaining three bedrooms are of generous size, and the upper floor is completed by a stunning



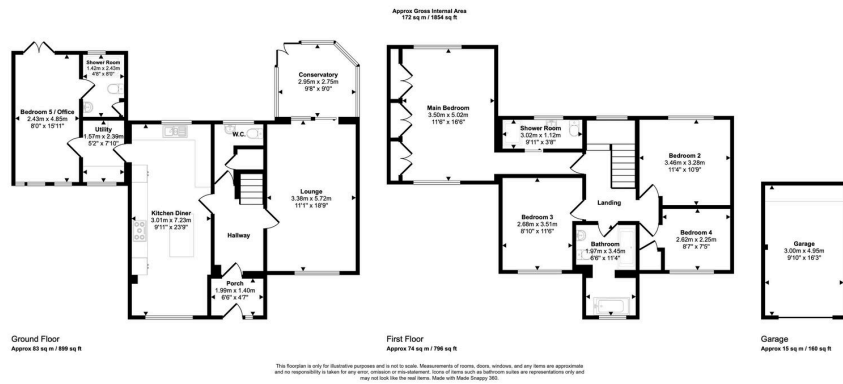

- LARGE DETACHED FAMILY HOME
- SOUGHT AFTER LOCATION
- GENERATIONAL LIVING
- STUNNING KITCHEN DINER
- SEPERATE UTILITY ROOM
- FOUR / FIVE BEDROOMS
- FAMILY BATHROOM AND TWO EN-SUITES
- WRAP AROUND PRIVATE GARDEN
- AMPLE PARKING AND SINGLE GARAGE
- GAS CENTRAL HEATING AND DOUBLE GLAZING



homesbyvictoria.co.uk
victoria@homesbyvictoria | 07833 136521

FOR M HOMES MIDLANDS LIMITED trading as Homes By Victoria Company Number: 13688840 VAT no: 470190115



HOMES BY VICTORIA
ESTATE AGENCY