



2

Bedrooms



2

Bathrooms





This spacious flat offers two bedrooms, two bathrooms, and a reception room, providing a comfortable living space. Located on North End Road in Wembley, the property features a modern kitchen and ample living area. The flat is ideal for those seeking a convenient urban lifestyle in Middlesex, with easy access to local amenities and transport links.

SEVENTEENTH FLOOR

772 sq.ft. (71.8 sq.m.) approx.

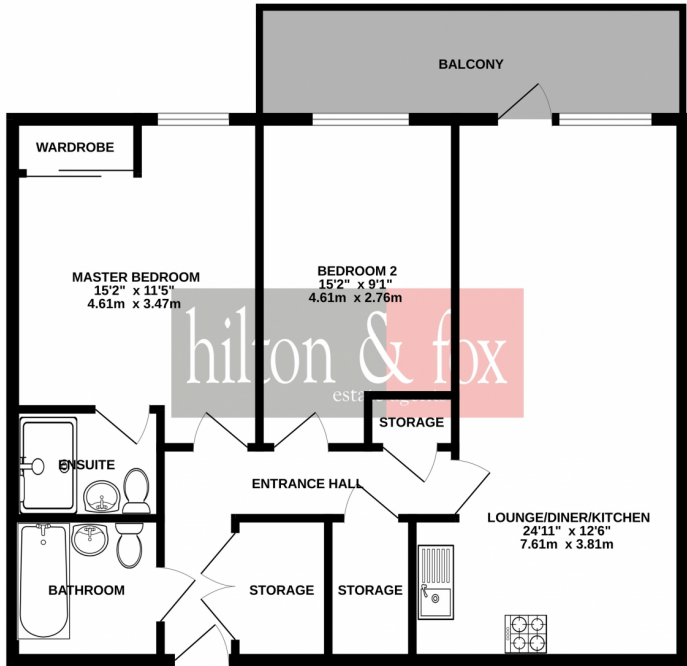

TOTAL FLOOR AREA: 772 sq.ft. (71.8 sq.m.) approx.

Whilst every attempt has been made to ensure the accuracy of the floorplan contained here, measurements of doors, windows, rooms and any other items are approximate and no responsibility is taken for any error, omission or mis-statement. This plan is for illustrative purposes only and should be used as such by any prospective purchaser. The services, systems and appliances shown have not been tested and no guarantee as to their operability or efficiency can be given.  
 Made with Metropack v2012

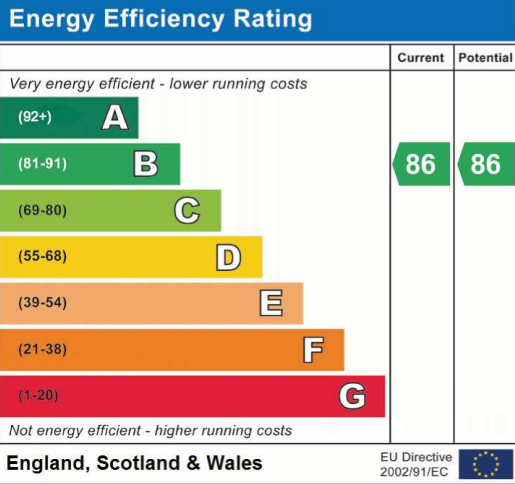

Address: 581 North End Road, HA9



