



Highland Road, SE19

£2,100 Per calendar month

Purpose-built, two bedroom first floor apartment set in the heart of Gipsy Hill. Consisting of two double bedrooms, a great sized living room and a smart galley kitchen. The property further benefits from access to large, well maintained communal grounds and a private balcony.

Highland Road is a 6 minute walk to Gipsy Hill Station for Southern Rail Networks, with journeys into central London taking approximately 30 minutes.

Features

- First Floor Flat
- Two Bedrooms
- Communal Grounds
- Fantastic Location
- Close to Amenities
- Private Balcony



Highland Road, SE19

Purpose-built, two bedroom first floor apartment set in the heart of Gypsy Hill. Consisting of two double bedrooms, a great sized living room and a smart galley kitchen. The property further benefits from access to large, well maintained communal grounds and a private balcony.



Highland Road,
London, SE19

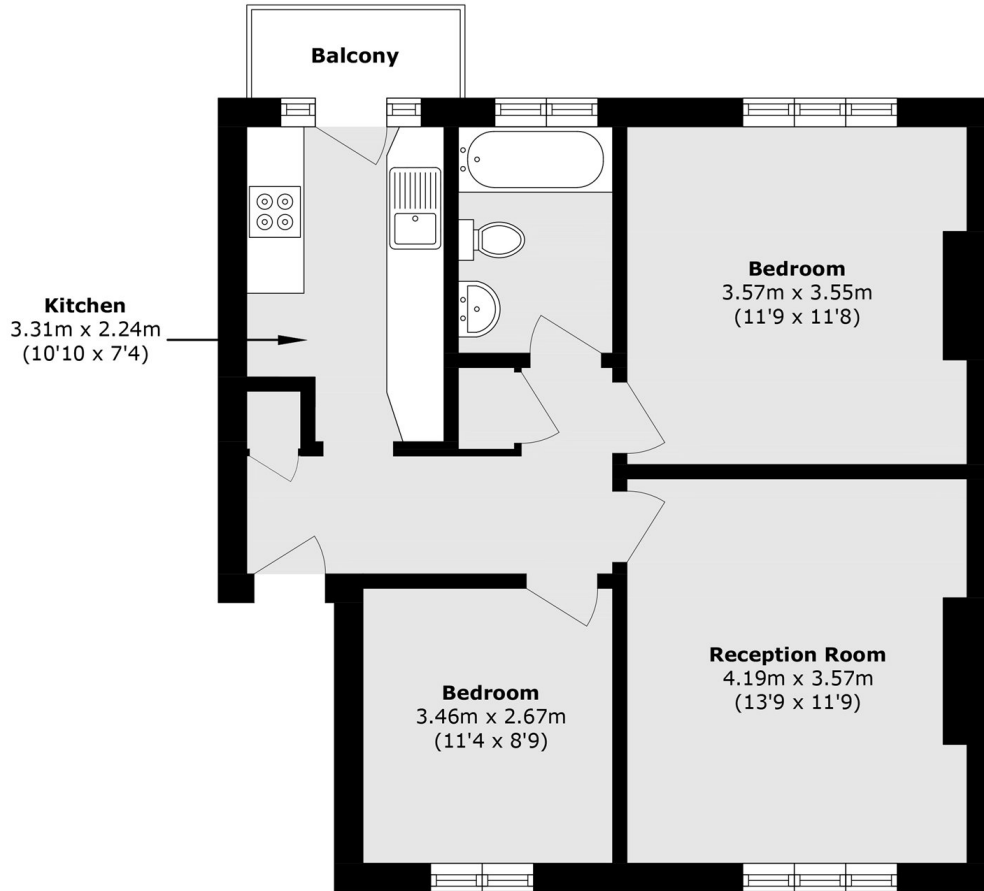

Total area (approx.): 54.8 sq. m (589.8 sq. ft)
Balcony area (approx.): 2.0 sq. m (21.5 sq. ft)