



112 Howbury Street

, Bedford, MK40 3QS

Offers Over £470,000



Floor Plan

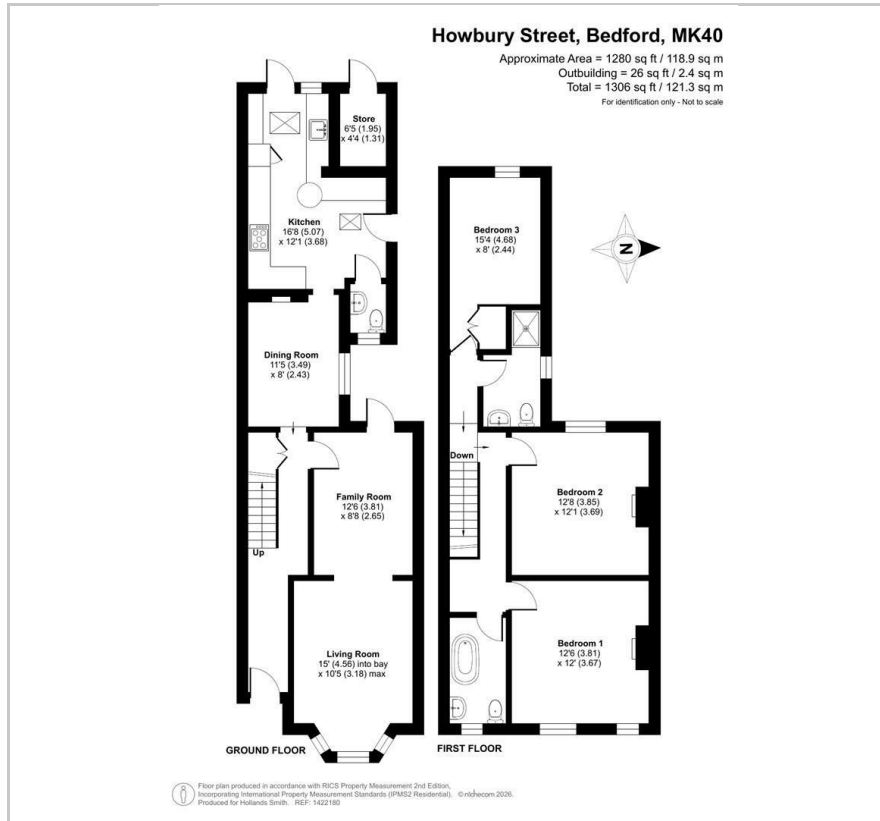

Area Map



Energy Efficiency Graph

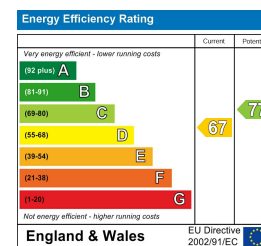

Viewing

Please contact our Bedford Office on 01234 216612 if you wish to arrange a viewing appointment for this property or require further information.

- Extended Period Home
- Three Bedrooms
- Large Living Room
- Sunny West Facing Garden
- NO CHAIN
- Two Bathrooms
- Separate Breakfast Room
- Popular 'Castle Quarter'



Well presented and offering spacious and adaptable accommodation, this period bay fronted terraced home is available with no upward chain. Extended to the rear of the ground floor, there is now a l-shaped kitchen/breakfast room with external storage and a ground floor WC. The kitchen has modern units, wooden worktops and some integrated appliances. There is also a connecting walk-through dining room and a large dual-aspect living room with a bay window to the front and glazed door to the rear. The first floor extends across the shared side passage and provides three double bedrooms and both bath and shower rooms refitted with period style suites. There is a period feel throughout the property with features including wood floors, picture rails and some fireplaces as well as modern additions such as uPVC sash windows. There is also gas to radiator heating throughout. Outside, there is a larger than usual walled garden which enjoys a sunny west facing aspect and has both lawn and patio areas. Howbury Street is within the highly popular 'Castle Quarter' of the town, conveniently situated for all of the area's most popular attractions. There is a choice of eateries along Castle Road including independently-owned coffee shops, cafes and restaurants as well as two popular pubs and other specialist shops such as a butcher and bakery. Russell Park and the Embankment are close by and Bedford town centre is a short walk away. For the commuter, Bedford's rail station offers fast links in London St Pancras. EER: D



163 Castle Road, MK40 3RT

Tel: 01234 216612

www.hollandsmith.co.uk