

19 Barnfield Drive, Chichester, PO19 6UU

£2,000 Per month

EPC Rating: D Council Tax Band: C



19 Barnfield Drive, Chichester, PO19 6UU

£2,000 Per month

Council Tax Band: C

Well-located four-bedroom house ideal for students or sharers, close to St Richard's Hospital and the city centre. Part furnished with beds and white goods included, plus new carpets upstairs. Spacious kitchen/diner, lounge and private garden. Available From May 2026.

This is a fantastic opportunity to secure a well-located four-bedroom house, ideally suited to students or professional sharers. Positioned just moments from St Richard's Hospital and within easy reach of Chichester city centre, the property offers practical, well-balanced accommodation in a highly convenient setting.

The house is presented in modern neutral décor throughout. On the ground floor, there is an entrance hall leading to a comfortable lounge and a spacious kitchen/diner with access out to a private enclosed rear garden — perfect for shared living. Upstairs, there are four bedrooms, each provided with a single bed, wardrobe and bedside table, making it an ideal base for a group looking to move straight in while still allowing space to add personal touches.

With gas central heating, mains services throughout, and key white goods and furniture included, this is a practical and well-equipped home designed for easy group living. Available from May 2026, this is one not to miss for the next academic year.





Ground Floor

Approx. 32.8 sq. metres (353.3 sq. feet)



First Floor

Approx. 32.7 sq. metres (351.7 sq. feet)

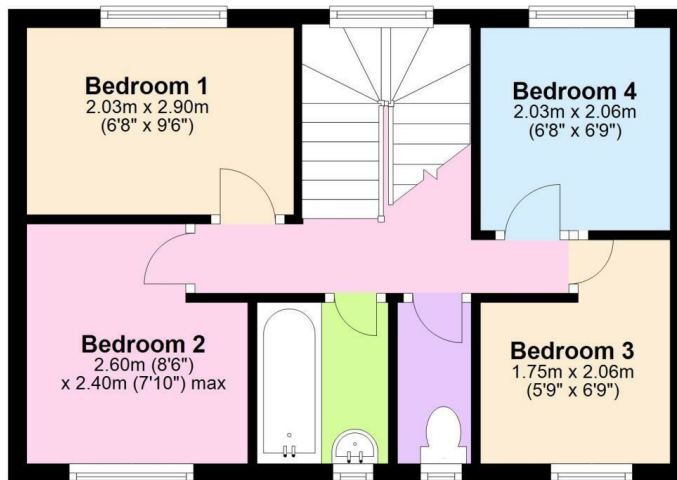

Total area: approx. 65.5 sq. metres (705.0 sq. feet)

The Old Boathouse Bosham Lane

Bosham

West Sussex

PO18 8HS

01243 624637

info@soloestates.co.uk

www.soloestates.co.uk

Energy Efficiency Rating		Current	Potential
Very energy efficient - lower running costs			
(92 plus) A			
(81-91) B			
(69-80) C			
(55-68) D		65	
(39-54) E			
(21-38) F			
(1-20) G			
Not energy efficient - higher running costs			
England & Wales		EU Directive 2002/91/EC	