



## Silwood Street, London, SE16 2AZ

**\*\*Heating and Hot Water Included\*\***

Fully Furnished

A contemporary and generous apartment with private balcony in ever so popular Bermondsey, moments from both Surrey Quays and South Bermondsey stations.

The property boasts a spacious open plan kitchen leading into the private balcony, a generous double bedroom with built-in wardrobe, and a stylish bathroom.

Southwark Park And a plethora of local amenities are located on your doorstep.

Council Tax Band = C

**£1,950 Per month**

- Contemporary Apartment
- Private Balcony
- Heating and Hot Water Included
- Bicycle Storage
- Moments from Surrey Quays and South Bermondsey Station
- Moments from Southwark Park
- Modern Kitchen

**Alex & Matteo**  
ESTATE AGENTS

# Silwood Street, London, SE16

Approximate Area = 544 sq ft / 51 sq m

For identification only - Not to scale

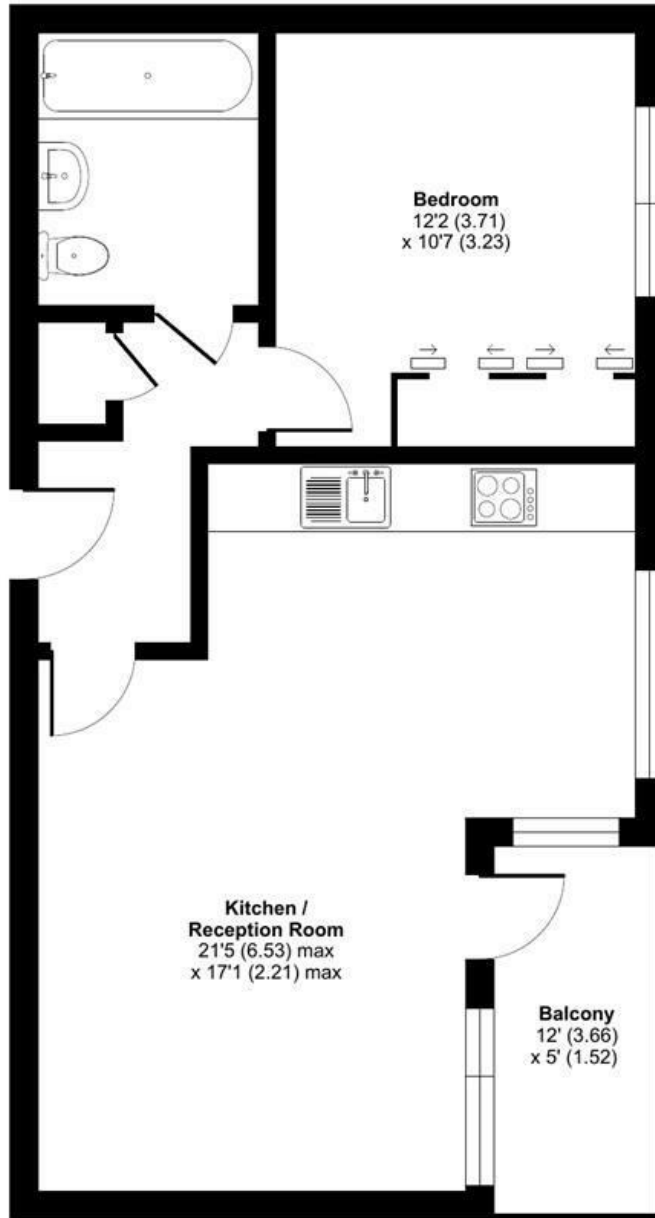

FIRST FLOOR



Floor plan produced in accordance with RICS Property Measurement Standards incorporating International Property Measurement Standards (IPMS2 Residential). © nchecon 2022. Produced for Alex & Matteo Estate Agents. REF: 871964

Energy Efficiency Rating		Current	Potential
Very energy efficient - lower running costs			
(92 plus) <b>A</b>			
(81-91) <b>B</b>		<b>83</b>	<b>83</b>
(69-80) <b>C</b>			
(55-68) <b>D</b>			
(39-54) <b>E</b>			
(21-38) <b>F</b>			
(1-20) <b>G</b>			
Not energy efficient - higher running costs			
<b>England &amp; Wales</b>	EU Directive 2002/91/EC		