

Chichele Street
Higham Ferrers
NN10 8HT

£1,100 Per Month



OSCAR JAMES

...expect excellence

FLOOR PLANS

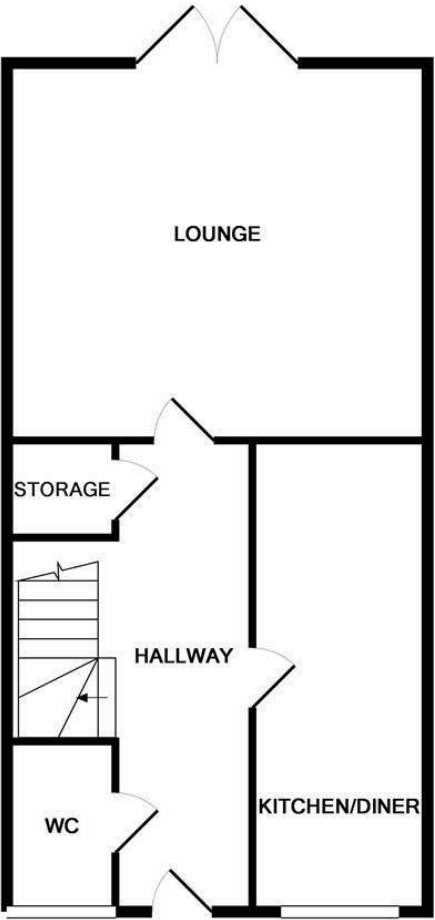

GROUND FLOOR
APPROX. FLOOR
AREA 606 SQ.FT.
(56.3 SQ.M.)

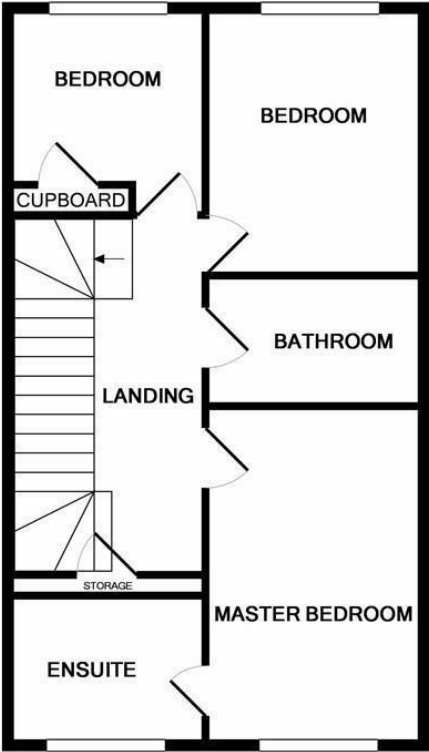

1ST FLOOR
APPROX. FLOOR
AREA 520 SQ.FT.
(48.3 SQ.M.)

TOTAL APPROX. FLOOR AREA 1126 SQ.FT. (104.6 SQ.M.)

Whilst every attempt has been made to ensure the accuracy of the floor plan contained here, measurements of doors, windows, rooms and any other items are approximate and no responsibility is taken for any error, omission, or mis-statement. This plan is for illustrative purposes only and should be used as such by any prospective purchaser. The services, systems and appliances shown have not been tested and no guarantee as to their operability or efficiency can be given
Made with Metropix ©2017



AT A GLANCE...



custom text 1



custom text 4



custom text 2



custom text 5



custom text 3



custom text 6



WHAT'S GREAT?

A beautifully presented, three bedroom home situated in a popular residential location which simply must be viewed.

Offering spacious accommodation over two floors which comprises; entrance hall, large lounge, kitchen diner and ground floor WC.

On the first floor expect to find three large bedrooms and family bathroom. The master bedroom also enjoys en-suite facilities.

Outside there is an enclosed rear garden along with allocated off road parking.

Viewing is an absolute must and strong interest is expected so call today!

*** AVAILABLE JANUARY ***

Council Tax Band: C
EPC Rating: B

...expect excellence



SELLER'S SECRET



Why we like it....

OSCAR JAMES

1 Newland Street | Kettering | NN16 8JH
01536 415777
www.oscar-james.com

To buy or not to buy....
