



**Swale Drive**

Kings Heath, Northampton

**oriordanbond**  
SALES & LETTINGS





## Swale Drive

Kings Heath

NN5 7NN

PRICE £225,000

Presented to an immaculate standard throughout having been fully renovated by the current owners is this three bedroom terraced house. Located in the popular residential area of Kings Heath, the property would make an ideal purchase for first time buyers.

The accommodation comprises entrance hall, sitting/dining room, kitchen, three first floor bedrooms and a family bathroom. Outside is a lawned front garden and to the rear of the property is a recently landscaped low maintenance garden with patio area. Further benefits include gas radiator heating and uPVC double glazing (B/779/M)

### Additional information

- Council Tax Band: A
- Energy Efficiency Rating: D

### Viewing

Viewing strictly by appointment – details below

### Disclaimer

O'Riordan Bond Estate Agents Limited has not tested apparatus, equipment, fittings or services and so cannot verify they are in working order. The buyer is advised to obtain verification from their solicitor or surveyor.

O'Riordan Bond Duston Sales

01604 589007

duston@oriordanbond.co.uk

GROUND FLOOR  
390 sq.ft. (36.2 sq.m.) approx.

1ST FLOOR  
390 sq.ft. (36.2 sq.m.) approx.

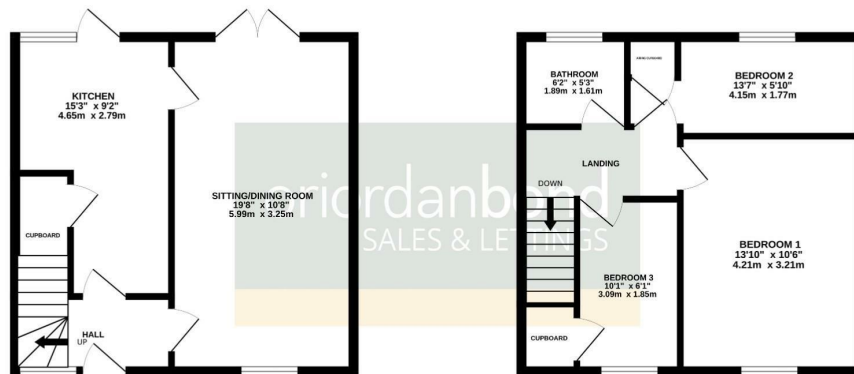

TOTAL FLOOR AREA : 779 sq.ft. (72.4 sq.m.) approx.

Whilst every attempt has been made to ensure the accuracy of the floorplan contained here, measurements of doors, windows, rooms and any other items are approximate and no responsibility is taken for any error, omission or mis-statement. This plan is for illustrative purposes only and should be used as such by any prospective purchaser. The services, systems and appliances shown have not been tested and no guarantee as to their operability or efficiency can be given.

Made with Metropix ©2025

